



HOME COUNTIES

BILLY LOWS LANE

EN6 1XW





Leasehold

£164,995

### Accommodation

This delightful one bedroom apartment on the second floor of the popular development Hertford Mews, located just a short walk to shops and restaurants and both Highview & Annandale Medical Centres and Parkfield Open Space. The property is offered in immaculate condition and benefits from a recently fitted modern kitchen with Neff appliances, southerly views over the award winning gardens, recently remodelled shower room and new hot and cold water tanks.

Hertford Mews is a retirement block with assisted living, there is a manager on site and pull cords in the rooms in case of emergencies, there is a communal residents lounge and award winning gardens, residents laundry room and overnight guest suites available for visitors along with guest and resident off street parking.



HERTFORD MEWS, BILLY LOWS LANE, POTTERS BAR. EN6 1XW



# HERTFORD MEWS, BILLY LOWS LANE, POTTERS BAR. EN6 1XW

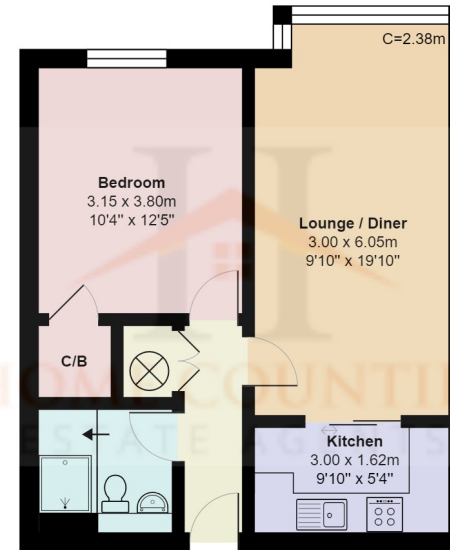

**Second Floor**  
Area: 47.3 m<sup>2</sup> ... 509 ft<sup>2</sup>

## Hertford Mews, Hertfordshire EN6

Total Area: 47.3 m<sup>2</sup> ... 509 ft<sup>2</sup>

All measurements are approximate and for display purposes only



IMPORTANT: we would like to inform prospective purchasers that these sales particulars have been prepared as a general guide only. A detailed survey has not been carried out, nor the services, appliances and fittings tested. Room sizes should not be relied upon for furnishing purposes and are approximate. If floor plans are included, they are for guidance only and may not be to scale. If there are any important matters likely to affect your decision to buy, please contact us before viewing the property.