



Day & Co
ESTATE AGENTS

28 Cavendish Street
Keighley
BD21 3RG



125 Airedale Avenue, Cottingley,
Bingley, West Yorkshire, BD16
1TJ

£145,000

T: 01535 664609

W: www.dayandcoestateagents.co.uk

E: keighley@dayandcoestateagents.co.uk

- END TOWN HOUSE
- THREE BEDROOMS
- FRONT & REAR GARDENS

- REQUIRES MODERNISATION
- THROUGH LOUNGE/DINER
- EPC Rating E

SUMMARY

** A THREE BEDROOM END TOWN HOUSE REQUIRING MODERNISATION, POPULAR RESIDENTIAL LOCATION, THROUGH LOUNGE/DINER, FRONT & REAR GARDENS, DRIVEWAY, EPC Rating E **

FULL DESCRIPTION

Offered for sale is this three bedroom end town house requiring modernisation situated in the popular residential area of Cottingley. This property has gardens to both the front and rear along with a driveway providing off road parking. In brief the accommodation comprises of an entrance hall, through lounge/diner with windows to the front elevation and patio doors to the rear, kitchen having a range of wall and base units, worktops, sink, window to the rear elevation, side entrance door. First Floor - Landing, three bedrooms, bathroom comprising of a rectangular bath, wash basin, separate w.c. Double Glazing. EPC Rating E

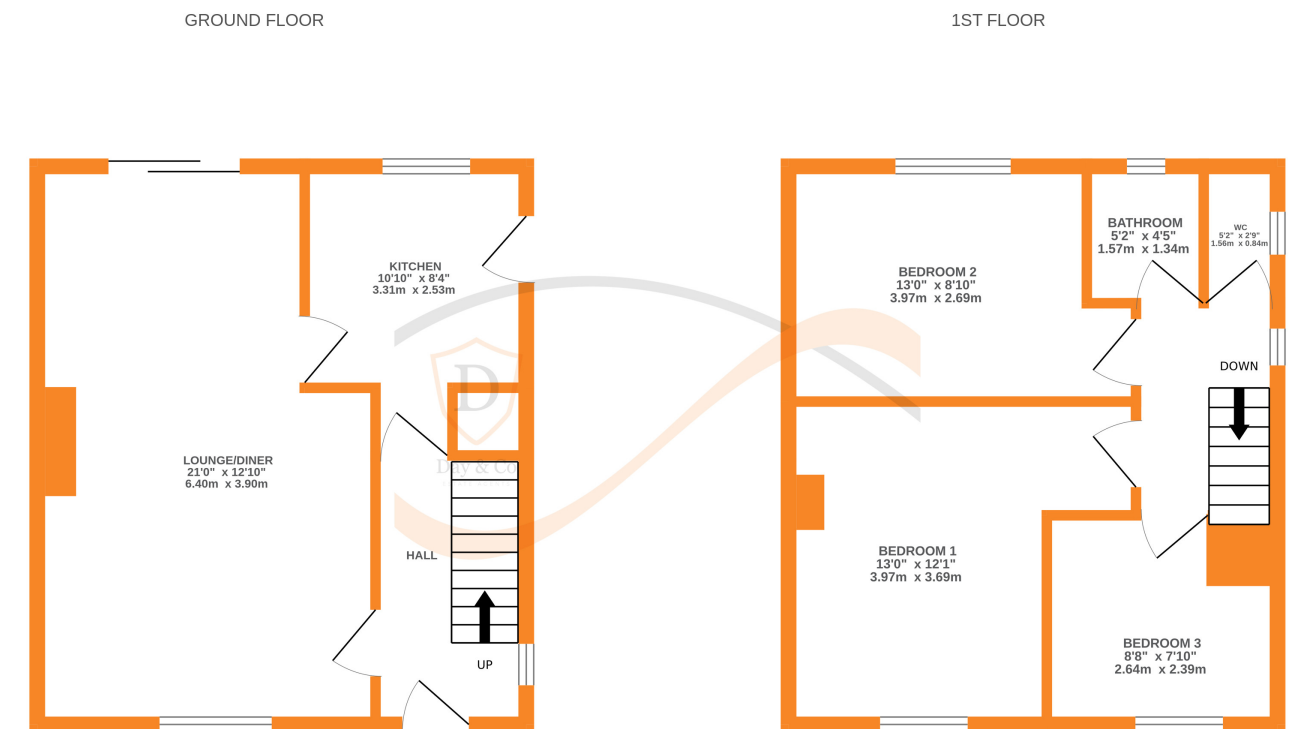

Whilst every attempt has been made to ensure the accuracy of the floorplan contained here, measurements of doors, windows, rooms and any other items are approximate and no responsibility is taken for any error, omission or mis-statement. This plan is for illustrative purposes only and should be used as such by any prospective purchaser. The services, systems and appliances shown have not been tested and no guarantee as to their operability or efficiency can be given.
Made with Metropix ©2023