



IMPERIAL COURT, HARROW

£1,750 pcm

**** AVAILABLE IMMEDIATELY **** A spacious and recently decorated, two bedroom flat, situated just minutes from Rayners Lane Metropolitan/Piccadilly Line station. The property briefly comprises of entrance hallway, large lounge, spacious modern kitchen, two bedrooms with built in wardrobes to the master bedroom and bathroom. Further benefits include double glazing, gas central heating, new flooring throughout, good storage, communal garden and communal residents parking.

- TWO DOUBLE BEDROOM
- LARGE KITCHEN
- MODERN BATHROOM
- GAS CENTRAL HEATING
- PARKING
- CLOSE TO LOCAL SHOPS & TRANSPORT LINKS
- PART FURNISHED OR UNFURNISHED
- FIRST FLOOR FLAT

Enrtance Hall

Lounge

Kitchen

Bedroom 1

Bedroom 2

Bathroom



DISCLAIMER: These particulars, whilst believed to be accurate are set out as a general outline only for guidance and do not constitute any part of an offer or contract. Intending purchasers should not rely on them as statements or representation of fact, but must satisfy themselves by inspection or otherwise as to their accuracy. We have not carried out a detailed survey nor tested the services, appliances and specific fittings. Room sizes should not be relied upon for carpets and furnishings. The measurements given are approximate. No person in this firms employment has the authority to make or give any representation or warranty in respect of the property.

FIRST FLOOR

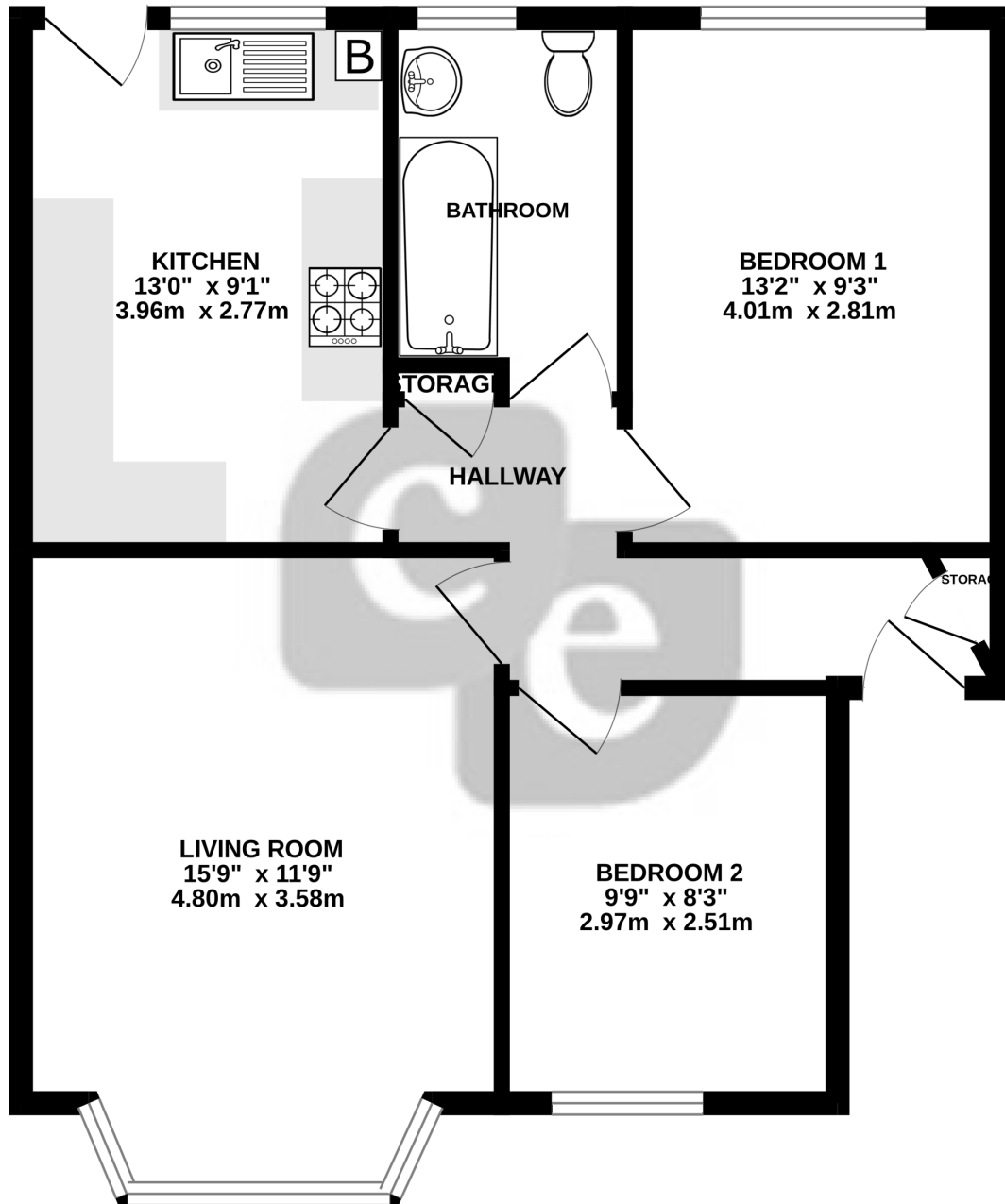

Whilst every attempt has been made to ensure the accuracy of the floorplan contained here, measurements of doors, windows, rooms and any other items are approximate and no responsibility is taken for any error, omission or mis-statement. This plan is for illustrative purposes only and should be used as such by any prospective purchaser. The services, systems and appliances shown have not been tested and no guarantee as to their operability or efficiency can be given.
Made with Metropix ©2025