



Tennyson Court

44, Tennyson Close, Royston,
Hertfordshire, SG8 5SZ

Leasehold - Guide Price **£185,000**

country
properties

We are pleased to offer this well-presented, and larger than average, two bedroom second floor apartment to the market. Tennyson Court is located in a peaceful residential area on the outskirts of Royston. The property comprises of a porch, entrance hallway, spacious living room, separate kitchen with space for dining, two good sized bedrooms, family bathroom, one allocated parking space and garage en-bloc. This property is an ideal purchase for a first-time buyer or someone looking to add a ready-made property into their portfolio.

Royston's vibrant market town benefits from commuter links directly to London's Kings Cross and Cambridge via the British Railway Network and also has excellent commutable road links via the A10, M11, A505 and A1M. The town has direct access to Cambridge City Centre along with London Luton and Stansted airports both being within a 45 minute drive. There are desirable schools for lower and higher education with two schools holding outstanding reputation. Royston Town Centre also benefits from local amenities including boutique shops, restaurants/bars, major supermarkets and doctors and dentists.

- Vendor is currently in the process of a full lease extension - new lease to be 143 years
- Two bedrooms
- Spacious lounge
- Separate kitchen
- Communal garden
- Allocated parking
- Garage en-bloc
- Council Tax band B / EPC rating E

Accommodation

Entrance

4' 9" x 6' 8" (1.45m x 2.03m)

Airing cupboard, carpets.

Lounge

15' 8" x 11' 5" (4.78m x 3.48m)

Double glazed window to the front aspect, carpets, double electric heater.



Kitchen

8' 7" x 8' 5" (2.62m x 2.57m)

Double glazed window to the front aspect, vinyl flooring, range of wall mounted and base level units with inset sink, space for a fridge/freezer, cooker, partially tiled walls, electric heater.

Bathroom

6' 1" x 5' 5" (1.85m x 1.65m)

Double glazed window to the side aspect, tiled walls and flooring, bath, wash hand basin, electric shower, electric heater.

Bedroom One

12' 8" x 9' 2" (3.86m x 2.79m)

Double glazed window to the rear aspect, carpets, electric heater.

Bedroom Two

8' 9" x 6' 10" (2.67m x 2.08m)

Double glazed window to the rear aspect, laminate flooring, electric heater.

External

Garage en-bloc, allocated parking space and communal garden area.

Agent's Notes

Lease Details

Lease Length - 99 years from 25 December 1979 (53 years remaining - the vendor is currently in the process of a full lease extension to add 90 years to the current lease)

Service Charge - £1440.43 per annum

Ground Rent - £110.00 per annum



44 Tennyson Court, Royston

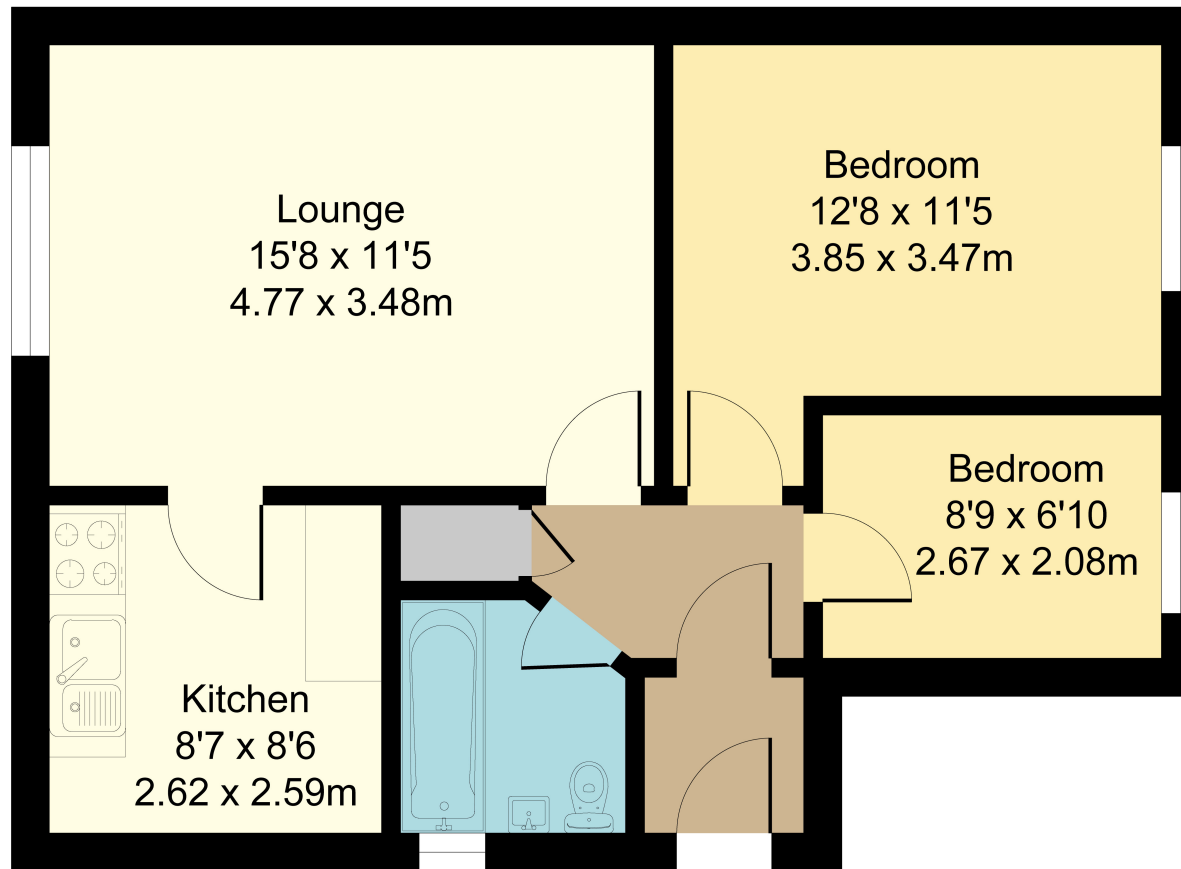

Total Area: 49.6 m² ... 535 ft²

All Measurements are approximate and for display purposes only

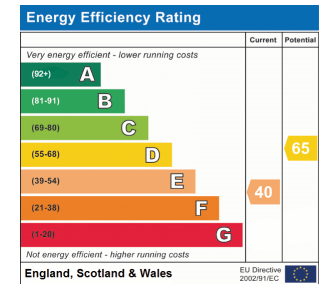

All measurements are approximate and quoted in metric with imperial equivalents and for general guidance only and whilst every attempt has been made to ensure accuracy, they must not be relied on. The fixtures, fittings and appliances referred to have not been tested and therefore no guarantee can be given and that they are in working order. Internal photographs are reproduced for general information and it must not be inferred that any item shown is included with the property. For a free valuation, contact the numbers listed on the brochure.

Viewing by appointment only

Country Properties | 45, High Street | SG8 9AW

T: 01763 245121 | E: royston@country-properties.co.uk

www.country-properties.co.uk

country
properties