



Flat 2 Lismore court, West Parade, Bexhill On Sea, East Sussex, TN39 3HR
One Bedroom Hall Floor Apartment With Stunning Sea Views £169,950





Property Café are delighted to offer for sale this spacious one bedroom, hall floor apartment situated directly on the seafront boasting stunning panoramic views of the sea and De La Warr Pavilion. Accommodation and benefits include; Spacious south aspect lounge; Large bedroom benefitting from fitted wardrobes; Fitted kitchen with ample cupboard & worktop space as well as an area for eating; Shower room consisting of shower cubicle, wash basin & WC. Additional benefits include stunning sea views across the English Channel, double glazing and gas central heating. The property has been neutrally decorated throughout and is to be sold with no onward chain. We recommend you view at your earliest convenience.

The property is situated in a highly sought after Seafront Location & within walking distance of Bexhill Town Centre which offers an excellent range of independent shops and amenities serving the local residents. Within the Town Centre you will find all the shops general facilities that you may need on a daily basis, most are independently owned and have been in existence for many years but of course there are also some excellent main shopping facilities. You will find an excellent Doctors surgery, various dentist, excellent local pubs and restaurants, a main pharmacy & main post office. There are regular bus services close by with services to Eastbourne and Hastings and both Collington & Bexhill Mainline stations are also close by providing excellent direct services routes to Gatwick, Ashford International & Central London.



HALL FLOOR

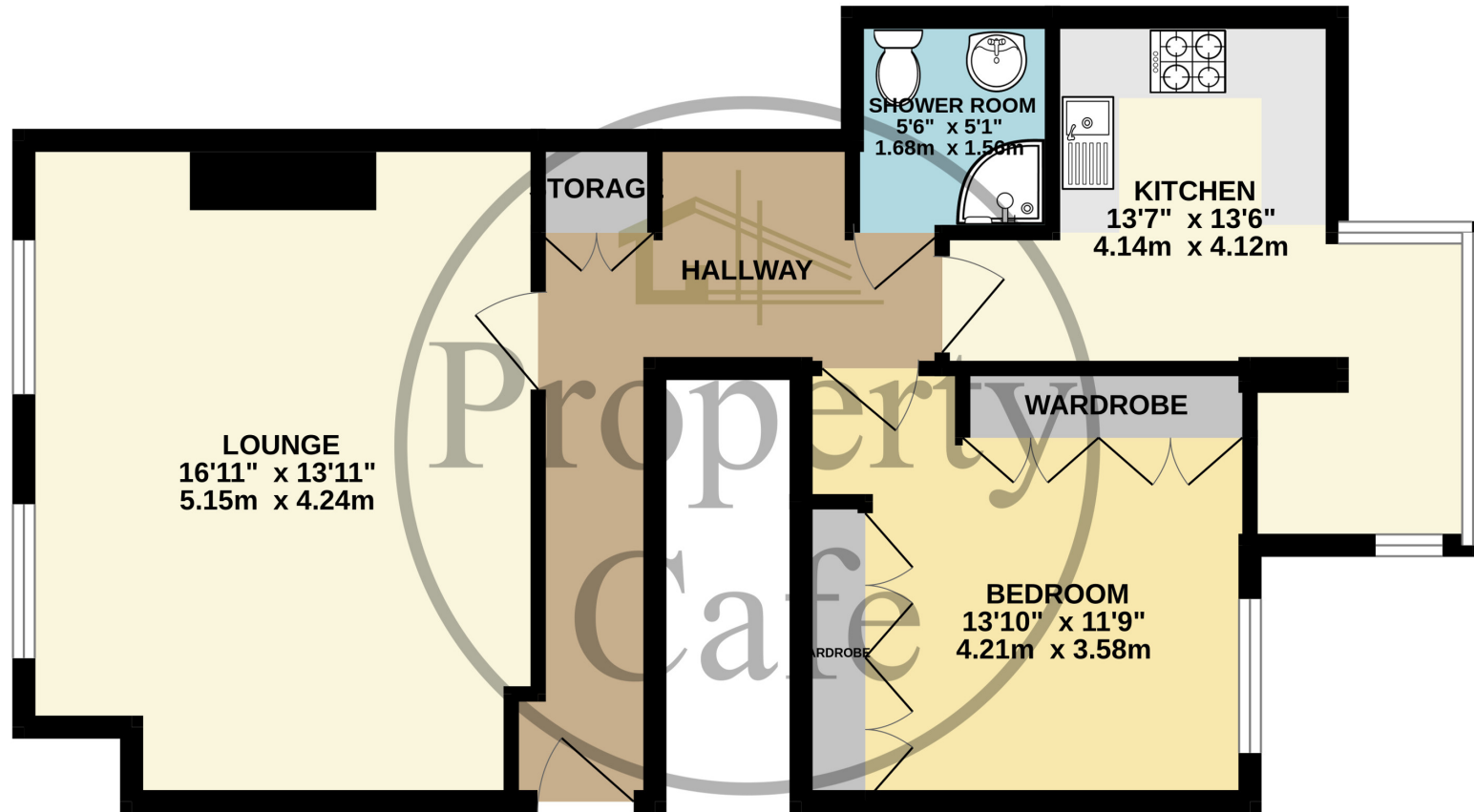

Whilst every attempt has been made to ensure the accuracy of the floorplan contained here, measurements of doors, windows, rooms and any other items are approximate and no responsibility is taken for any error, omission or mis-statement. This plan is for illustrative purposes only and should be used as such by any prospective purchaser. The services, systems and appliances shown have not been tested and no guarantee as to their operability or efficiency can be given.
Made with Metropix ©2024



At Property Café we believe it important to give clear and straight forward advice to both buyers and sellers alike. Whilst we believe the internet is truly amazing we also believe there is still no substitute for meeting you in person; with this in mind we have developed a unique lounge style environment that allows you the time and space to discuss your requirements with us in detail and enjoy your property search in comfort. Our trained consultants look forward to meeting you.



Share of freehold * Remaining lease length - 103 years * Service charge £720 per annum * Ground rent - N/A

The property is situated in a highly sought after Seafront Location & within walking distance of Bexhill Town Centre which offers an excellent range of independent shops and amenities serving the local residents. Within the Town Centre you will find all the shops general facilities that you may need on a daily basis, most are independently owned and have been in existence for many years but of course there are also some excellent main shopping facilities. You will find an excellent Doctors surgery, various dentist, excellent local pubs and restaurants, a main pharmacy & main post office. There are regular bus services close by with services to Eastbourne and Hastings and both Collington & Bexhill Mainline stations are also close by providing excellent direct services routes to Gatwick, Ashford International & Central London.

- Hall Floor Apartment
 - Share of Freehold
- Large One Bedroom Flat For Sale
- Stunning Views Of De La War Pavilion & Sea
 - Spacious South Facing Lounge
 - Fitted Kitchen With Eating Area
- Fitted Shower Room
- Neutral Decor Throughout
- Gas Central Heating & Double Glazed
 - Sold With No Onward Chain
- Sought After Seafront & Town Centre Location
 - Viewing Highly Recommended