



HILTON KING & LOCKE

SPECIALISTS IN PROPERTY



8 Benjamin Lane, Wexham, Berkshire. SL3 6AB.

£450,000 Freehold

IMMACULATE THREE BEDROOM, TWO BATHROOM TOWN HOUSE

WITHIN A SOUGHT AFTER DEVELOPMENT BUILT BY THE RENOWNED LINDEN HOMES CIRCA 2009

SITUATED AT THE END OF A PLEASANT CUL-DE-SAC WITH A GOOD SIZED GARDEN

OWN DRIVE AT THE FRONT OF THE HOUSE PLUS PARKING SPACE OPPOSITE

This immaculate three bedroom terraced town house is situated in popular Benjamin Lane in Wexham, an impressive development built by the renowned Linden Homes in 2009. This property is situated nicely tucked away, in a pleasant setting at the end of a cul-de-sac.

Internal accommodation includes a 15'4 x 14' rear aspect living room with doors opening out onto the double glazed conservatory/dining room. Also on the ground floor is a stylish modern kitchen which overlooks the front of the property which has an integrated dishwasher, washing machine and fridge freezer. There is also a cloakroom off the hall.

On the first floor are two good sized bedrooms, with bedroom two measuring 13'11 x 11'2 and offering a rear aspect over the garden, and a 13'11 x 7'10 bedroom three which has a delightful twin front aspect. The family bathroom completes this floor.



On the top floor is a lovely master suite with the bedroom being 13'11 x 10'8, and it has its own ensuite shower room.

Outside and to the front, there is parking at the front of the property plus an additional space opposite. To the rear, there is a low maintenance garden which is west facing and has a lawn and rear access gate.

The property is within easy reach of Slough Town Centre with its abundance of amenities including an array of shops, cafes, bars and restaurants, while walking distance to Wexham Park Hospital and Stoke Poges.

Within close proximity are Black Park, Langley Park and the motorway network of the M25, M40, M4. A selection of schools are also close by, plus nearby Slough, Langley Stations will shortly join the pending crossrail route in 2023



Important Notice

Particulars: These particulars are not an offer or contract, nor part of one. You should not rely on statements by Hilton King & Locke Ltd in the particulars or by word of mouth or in writing (whether written or oral) as being factually accurate about the property, its condition or its value. Hilton King & Locke Ltd does not have any authority to make any representations about the property, and accordingly any information given is entirely without responsibility on the part of the agents, seller(s) or lessor(s).

Photographs etc: The photographs show only certain parts of the property as they appeared at the time they were taken. Areas, measurements and distances given are approximate only.



The Broadway
Slough Buckinghamshire SL2 3QH

Tel: 01753 643555
fc@hklhome.co.uk

First Floor

Approx. 33.7 sq. metres (362.7 sq. feet)

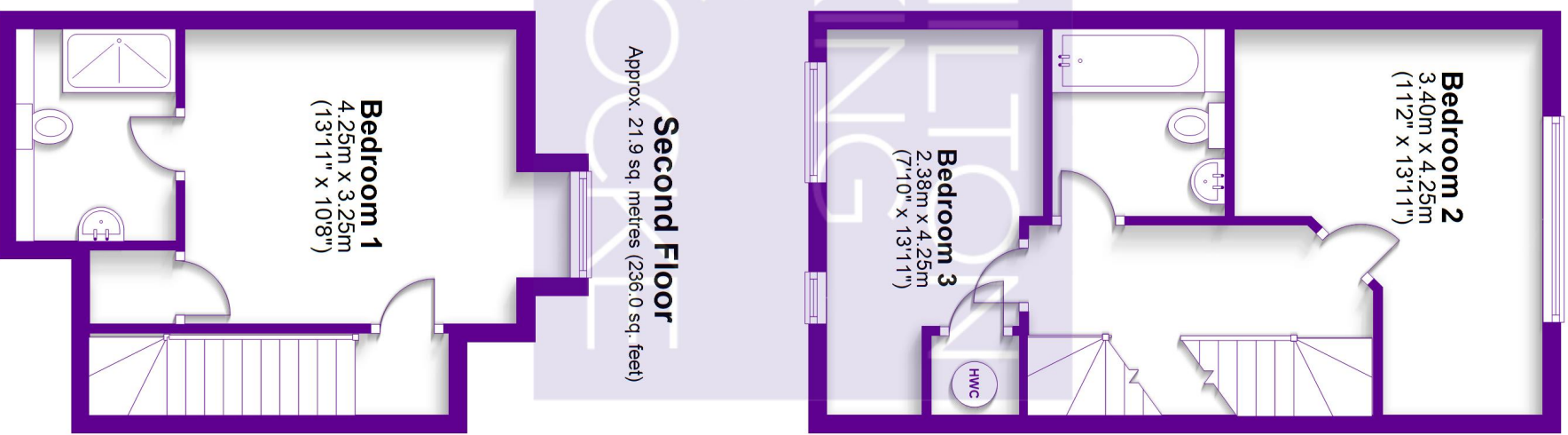

Ground Floor

Approx. 43.0 sq. metres (462.9 sq. feet)

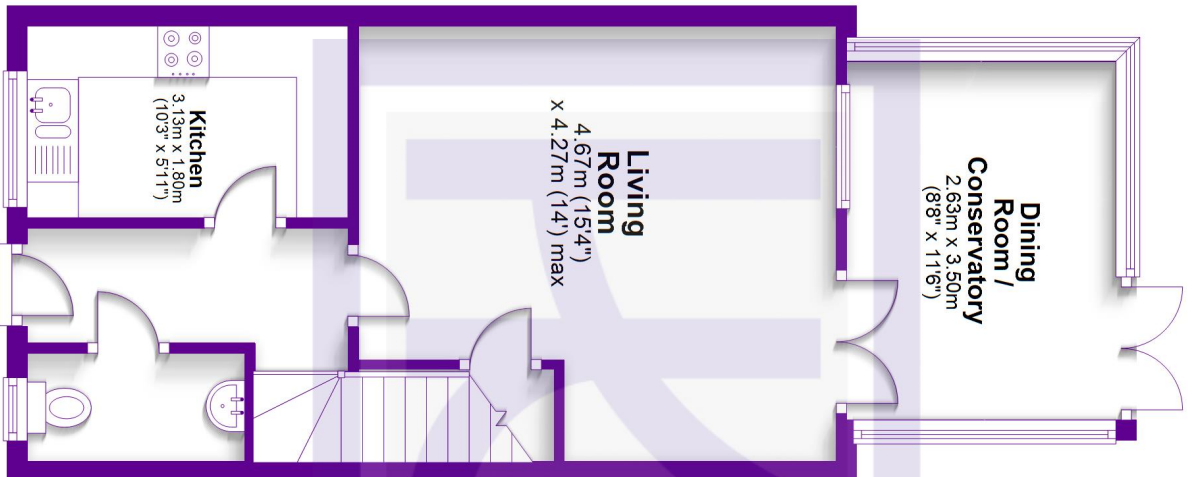

Total area: approx. 98.6 sq. metres (1061.6 sq. feet)

FOR ILLUSTRATIVE PURPOSES ONLY - NOT TO SCALE

The position and size of doors, windows, appliances and other features are approximate only.

© My Home Property Marketing - Unauthorised reproduction prohibited.

Plan produced using PlanUp.