



Day & Co
ESTATE AGENTS

28 Cavendish Street
Keighley
BD21 3RG



17 Waterside, Oxenhope,
Keighley, West Yorkshire, BD22
9HW

£264,500

T: 01535 664609

W: www.dayandcoestateagents.co.uk

E: keighley@dayandcoestateagents.co.uk

- EPC Rating Is D
- Four Bedrooms
- Drive & Under House Garage
- NO CHAIN

- Well Presented End Town House
- Accommodation Over Three Floors
- Sought After Village Of Oxenhope With Views Over The Village

SUMMARY

****A SUPERBLY PRESENTED 4 BEDROOM END TOWN HOUSE, SPACIOUS FAMILY ACCOMMODATION IN SOUGHT AFTER VILLAGE LOCATION OF OXENHOPE!!**** Having accommodation over 3 floors, block paved drive, under house garage, well maintained rear garden, pleasant views over the village - OFFERED FOR SALE WITH NO ONWARD CHAIN!! EPC rating is D.

FULL DESCRIPTION

Viewing is essential to fully appreciate this superbly presented four bedroom end town house situated in the sought after village location of Oxenhope with excellent access to the local primary school and village amenities. The well proportioned accommodation comprises of an entrance hall giving access to a cloaks WC and spacious under stairs storage cupboard. Bedroom four is on this level having double glazed window to the front and a radiator. The utility room has base and wall mounted units and plumbing for an automatic washing machine. To the first floor the spacious living room/dining room has a pebble effect gas fire, double glazed window to the rear, double glazed sliding doors to a Juliet balcony with views to the front, double glazed sliding doors leading to the rear garden. To the second floor there are three further bedrooms, the master having two double glazed windows to the front and offering pleasant views over Oxenhope village. The bathroom has a modern three piece suite in white comprising of a 'P' bath with shower over, WC, wash hand basin. Externally the property has a block paved drive leading to an under house garage. To the rear is a well maintained artificial lawn and patio. Offered for sale with no onward chain, EPC rating is D.

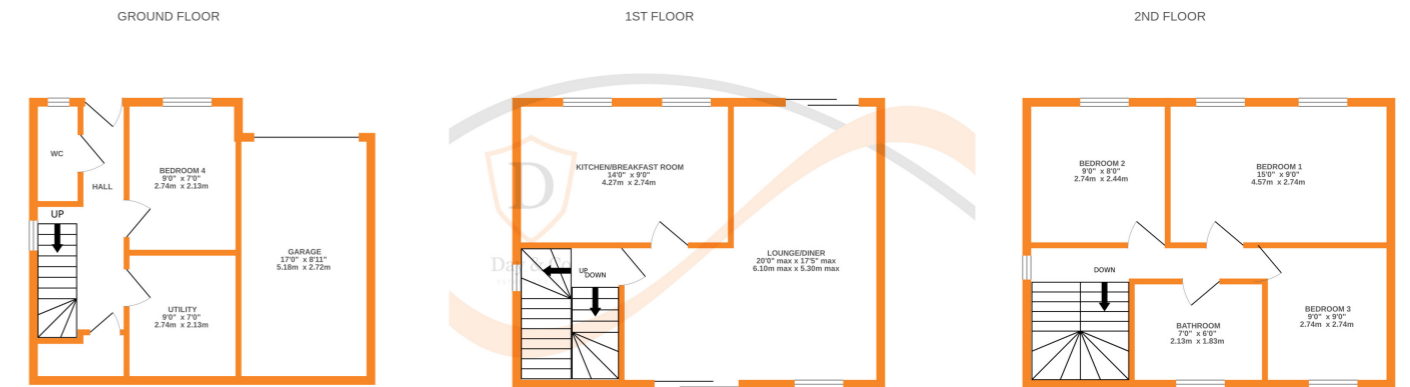

Whilst every attempt has been made to ensure the accuracy of the floorplan contained here, measurements of doors, windows, rooms and any other items are approximate and no responsibility is taken for any error, omission or mis-statement. This plan is for illustrative purposes only and should be used as such by any prospective purchaser. The services, systems and appliances shown have not been tested and no guarantee as to their operability or efficiency can be given.
Made with Metropix 62023