



20 Willow Drive, Bexhill-on-Sea, East Sussex,
TN39 4PX

£539,950



- Immaculate Detached Bungalow
- Two Good Size Double Beds
- Lounge With Patio Doors To The Garden
- Master Bed With En-suite Shower Rm
- Well Planned Modern Fitted Kitchen
- UPVC Conservatory Overlooking Garden
- Spacious Inner Entrance Hall
- Immaculate Family Bathroom
- Lovely Neutral Decor Throughout
- Ample Storage & Large Loft Space
- Block Paved Drive (Space For X2 Cars)
- Central Heated & Double Glazed
- Walled & Gated Front Garden
- Good Size & Well Stocked Rear Garden
- Two Garden Tool Sheds
- Lovely Peaceful Cul-De-Sac Location
- Close To Little Common Village



GROUND FLOOR
 1032 sq.ft. (95.9 sq.m.) approx.

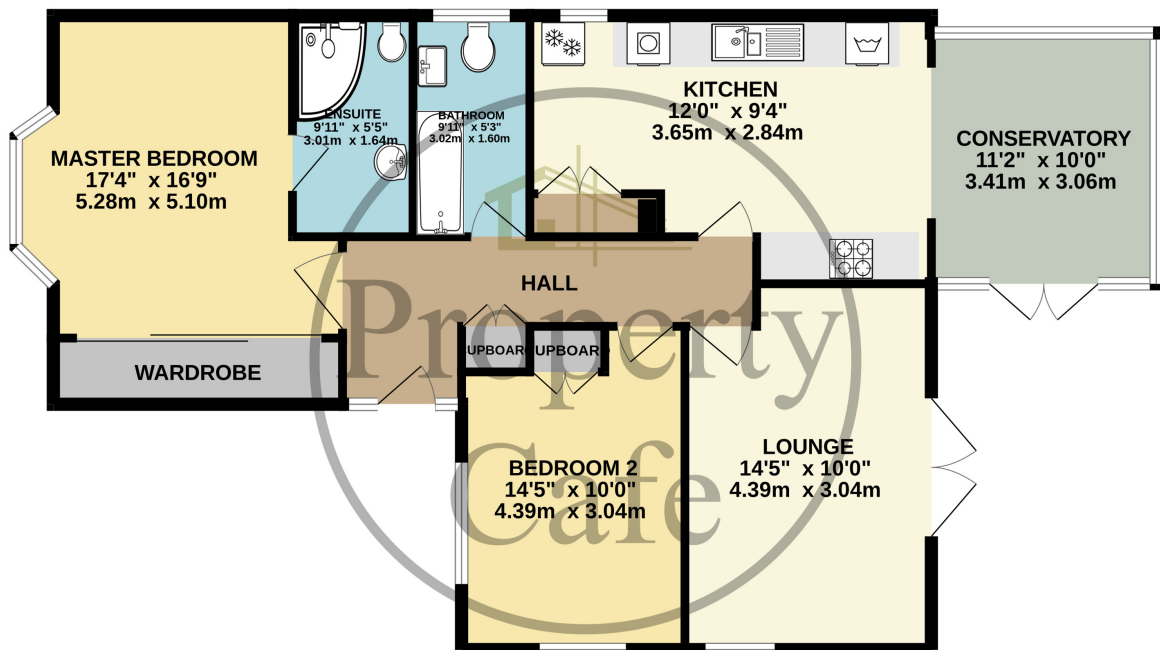

TOTAL FLOOR AREA : 1032 sq.ft. (95.9 sq.m.) approx.

Whilst every attempt has been made to ensure the accuracy of the floorplan contained here, measurements of doors, windows, rooms and any other items are approximate and no responsibility is taken for any error, omission or mis-statement. This plan is for illustrative purposes only and should be used as such by any prospective purchaser. The services, systems and appliances shown have not been tested and no guarantee as to their operability or efficiency can be given.
 Made with Metropix ©2023

