



43 Lewis Road, Sidcup, Kent, DA14 4NB
£350,000 Leasehold

Description

Recently Refurbished Throughout, this beautiful two bedroom ground floor maisonette is available immediately.

Two spacious bedrooms, modern bathroom, modern kitchen with appliances and space for dining table, large living room with doors leading to private garden. Parking to the front. Please use our online diary to request your viewing!

Situated in a sought after location this ground floor two bedroom maisonette, Sidcup High Street is approximately 1 mile away with boutique shops and cafes and the prestigious Hall Place a fine Grade I listed country house built in 1537 a popular wedding and events destination. Locally there are many restaurants, retail shops and pubs, large supermarket, gyms and recreational grounds with Fooks Cray Meadows just a short walk away with 240 acres of woodlands and fields with the river Cray flowing through. The property also benefits from Albany Park Station approximately 0.6 miles away with a parade of local amenities. Sidcup Station is approximately 0.7 mile away. The location also benefits from easy access to the A2 and A20 which make this location ideal for the London commuter.

GROUND FLOOR
615 sq.ft. (57.1 sq.m.) approx.

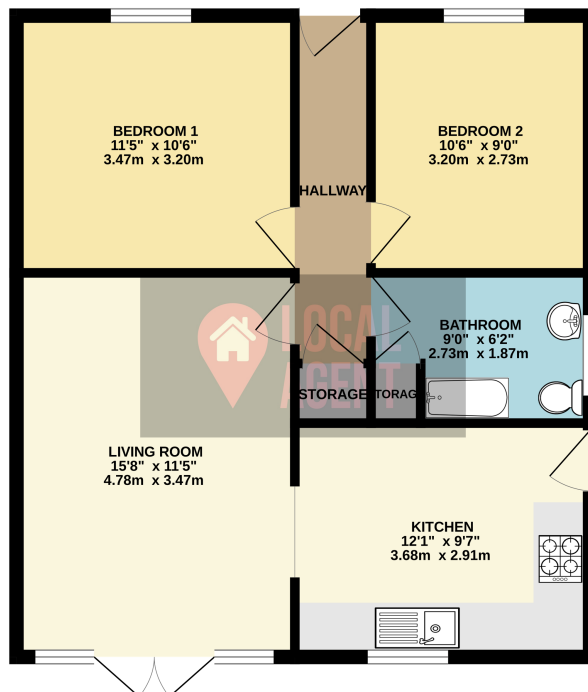

TOTAL FLOOR AREA : 615 sq.ft. (57.1 sq.m.) approx.
Whilst every attempt has been made to ensure the accuracy of the floorplan contained here, measurements