

74 Meadenvale, Peterborough, PE1 5PY



Capitol Lettors has not tested any of the equipment or the heating system (if mentioned) in these details. Purchasers are advised to satisfy themselves as to their working order and condition. These particulars do not constitute or form any part of an offer or contract nor may they be regarded as representations. All interested parties must themselves verify their accuracy. All measurements are approximate.

Capitol Lettors

Capitol Lettors Sales & Letting Agents

PO Box 1476, Peterborough, Cambs, PE2 2WX

Tel: 01733 553366

Email: Enquiries@capitollettors.com • www.capitollettors.com

VAT No. 922 2845 32 • Company Registration No. 6218276



74 Meadenvale, Peterborough, PE1 5PY
NO CHAIN £162,500 Freehold

This Semi-Detached property is located in Parnwell which is just 3 miles from Peterborough City Centre. The property offers UPVC double glazing, gas central heating, entrance hall, lounge, kitchen/diner, two bedrooms, bathroom with shower over bath, enclosed rear garden & parking for one car.



www.capitollettors.com

Zoopa.co.uk
Smarter property search

74 Meadenvale, Peterborough, PE1 5PY

Entrance Hall

1.21m x 1.42m (4' 0" x 4' 8") Approx
UPVC door to front aspect, fuse box, laminate flooring.

Lounge

3.29m x 4.23m (10' 10" x 13' 11") Approx
UPVC window to front aspect, radiator, TV & phone points, stairs leading to 1st floor, fitted carpet.

Kitchen/Diner

3.29m x 4.05m (10' 10" x 13' 3") Approx
UPVC sliding door to rear aspect, eye & base level units with tiled splash back & complimentary worktops, sink with mixer tap, electric oven, gas hob with extractor above, combi boiler, plumbing for white goods, vinyl flooring.

Stairs & Landing

Stairs to first floor, loft hatch, storage cupboard with shelving, fitted carpet.

Bedroom 1

3.29m x 2.65m (10' 10" x 8' 8") Approx
UPVC window to front aspect, built in wardrobe, radiator, laminate flooring.

Bedroom 2

3.29m x 2.44m (10' 10" x 8' 0") Approx
UPVC window to rear aspect, radiator, laminate flooring.

Bathroom

1.60m x 2.50m (5' 3" x 8' 2") Approx
UPVC frosted window to side aspect, three piece bathroom suite comprising of low level WC, wash hand basin & bath with electric shower over, towel radiator, fully tiled walls & floor.

Rear Garden

Fully enclosed by fence panels & brick wall, patio area with slabbed path way leading to rear gate giving access to parking space & front gate, shed, lawn area.

Front

Small graveled area, slabbed path to front door & gate leading to rear garden.

74 Meadenvale, Peterborough, PE1 5PY

Ground Floor

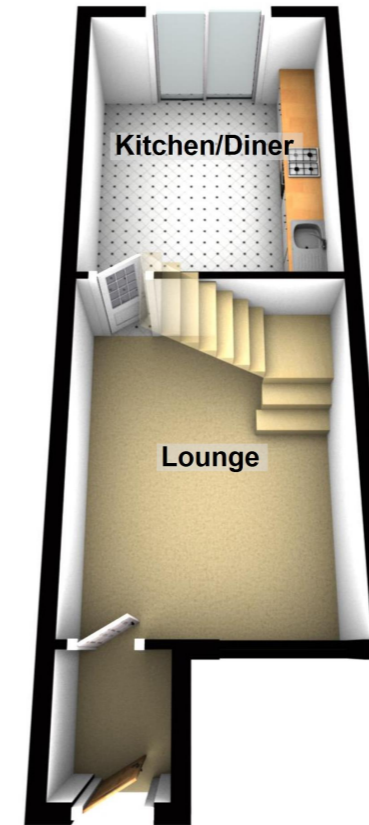

First Floor



This plan is for illustration purposes only and may not be representative of the property. Plan may not be to scale. Plan produced using PlanUp.

