

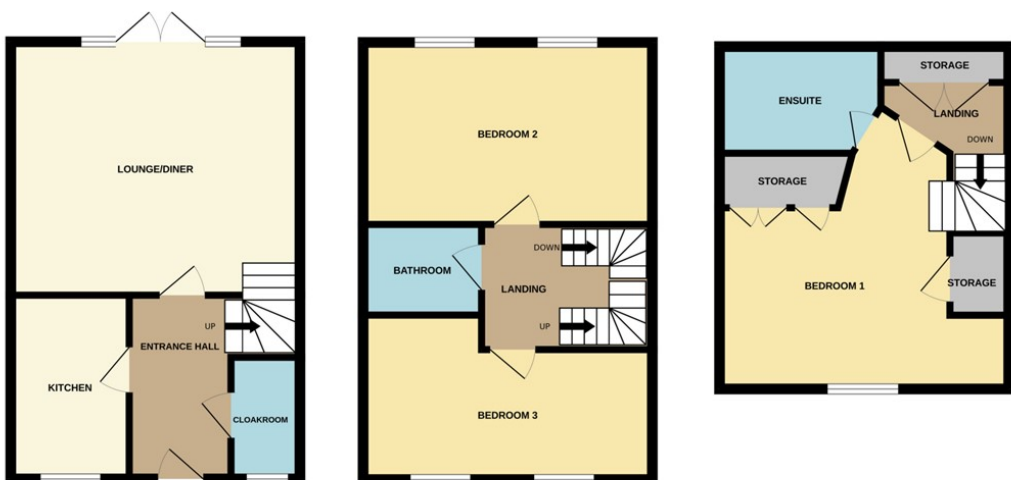

BOURNE

£165,000



Being Sold via Secure Sale online bidding. Terms & Conditions apply. Starting Bid £165,000 This mid terrace house offers spacious living accommodation set across three floors and is situated on the popular Elsea Park Estate in Bourne. On the ground floor there is an entrance hallway, cloakroom, kitchen and lounge with doors leading to the rear garden. On the next floor there are two bedrooms and a family bathroom whilst the top floor has the master bedroom with ensuite shower room. There are two allocated parking spaces to the rear. The property is currently vacant and is being offered with No Onward Chain. EPC Energy Rating C - Council Tax Band C