



FOR SALE

Montrose Court, The Hyde COLINDALE NW9

Calling All Buy-to-Let Investors & First-Time Buyers!

Recently Renovated - A fantastic opportunity to acquire this spacious and well-presented two double bedroom, second-floor purpose-built apartment, offered to the market on a chain-free basis.

The property has been recently renovated throughout and comprises a bright and airy reception room, a newly fitted modern kitchen with appliances, two generous double bedrooms, and a contemporary three-piece family bathroom. Further benefits include access to well-maintained communal gardens.

Ideally located just off Edgware Road, the property is within close proximity to a range of local shops, supermarkets, and amenities. Excellent transport links are available nearby, including Burnt Oak Underground Station (Northern Line), providing direct access into Central London. Early viewing is highly recommended. Contact us today to arrange your appointment!

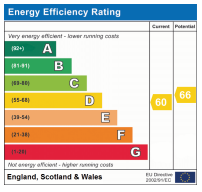

£325,000 Leasehold

Floorplan

GROUND FLOOR
523 sq.ft. (48.6 sq.m.) approx.

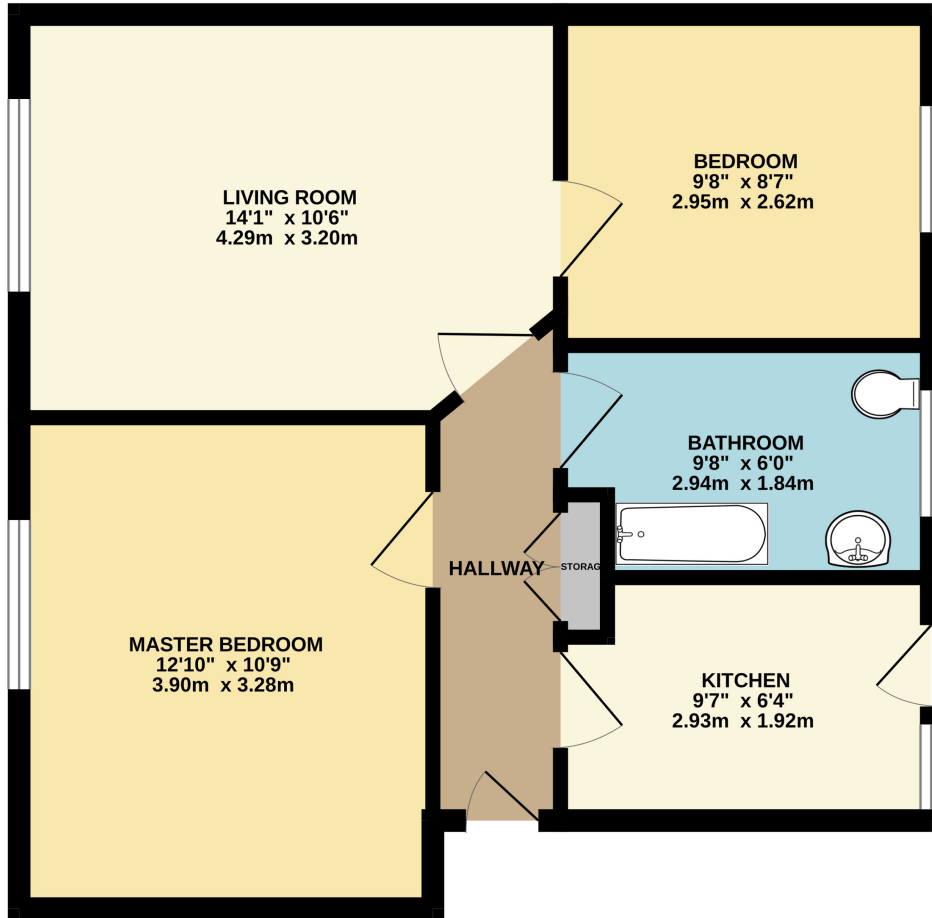

TOTAL FLOOR AREA : 523 sq.ft. (48.6 sq.m.) approx.

Whilst every attempt has been made to ensure the accuracy of the floorplan contained here, measurements of doors, windows, rooms and any other items are approximate and no responsibility is taken for any error, omission or mis-statement. This plan is for illustrative purposes only and should be used as such by any prospective purchaser. The services, systems and appliances shown have not been tested and no guarantee as to their operability or efficiency can be given.
Made with Metropix ©2025

NB: Please note that all fittings, kitchen appliances and heating systems have not been tested by Mishca & Co Sales & Lettings. Whilst we endeavour to make our sales details accurate and reliable. Room sizes should not be relied upon for carpets and furnishings. If there is any point, which is of particular important to you, please contact our office and we will be pleased to verify any information for you. Do so particularly if contemplating travelling some distance to view this property.