



**3 Greenlake Terrace Laleham Road, Staines-upon-Thames. TW18 2NU.**  
**2 Bedroom Terraced House - £415,000 Freehold**

# 3 Greenlake Terrace Laleham Road, Staines-upon-Thames. TW18 2NU.

01784 451458

## 2 Bedroom Terraced House - £415,000 Freehold

WELL PRESENTED, HUGELY SPACIOUS TWO BEDROOM PROPERTY SITUATED ALONG THIS MUCH SOUGHT AFTER ROAD IDEALLY LOCATED FOR EASY ACCESS TO BOTH STAINES TOWN CENTRE & MAINLINE TRAIN STATION. The property benefits from a spacious lounge/diner with patio doors to rear garden, separate modern fitted kitchen, two large double bedrooms, modern white bathroom suite, large secluded rear garden and garage. No Onward Chain. Viewings Highly Recommended!

### Key Features

HUGELY SPACIOUS TWO BEDROOM HOUSE  
CLOSE TO TOWN CENTRE & MAINLINE TRAIN STATION  
MUCH SOUGHT AFTER LOCATION  
WELL PRESENTED THROUGHOUT  
NO ONWARD CHAIN

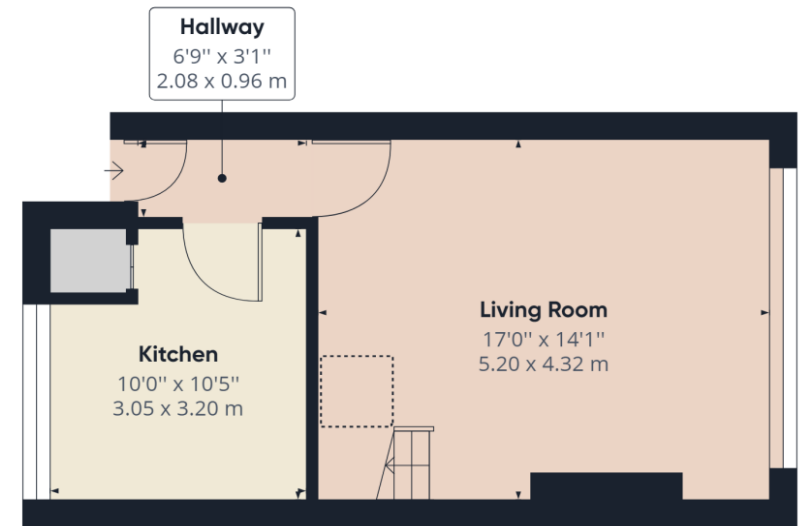

Ground Floor

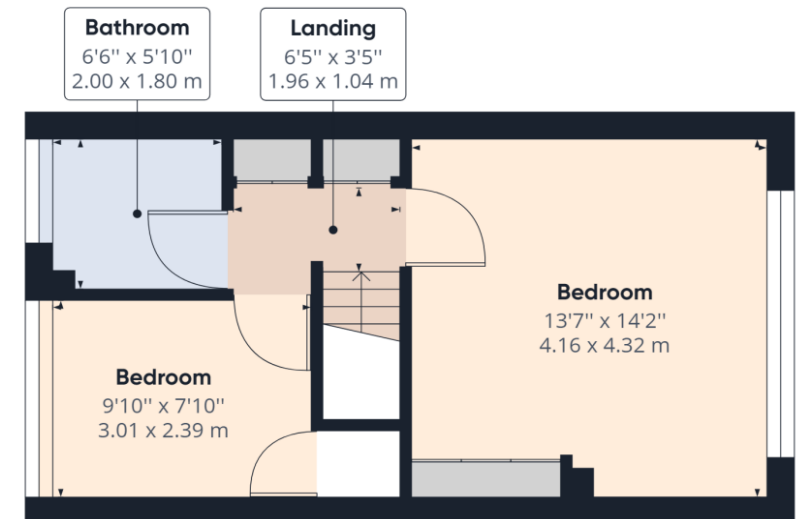

**GREGORY BROWN**  
RESIDENTIAL SALES & LETTINGS



# 3 Greenlake Terrace Laleham Road, Staines-upon-Thames. TW18 2NU.

[gregory-brown.co.uk](http://gregory-brown.co.uk)

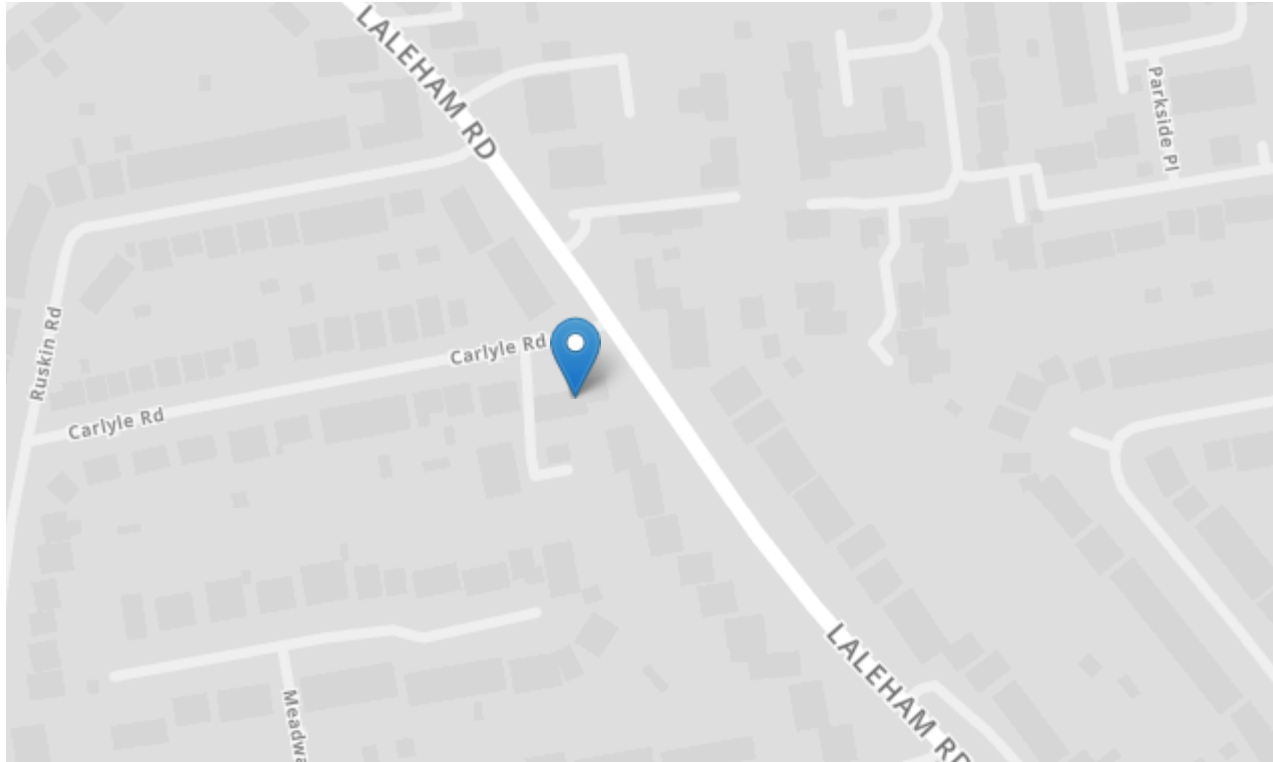

Tenure	<b>Freehold</b>
Lease Term	<b>N/A</b>
Ground Rent	<b>N/A</b>
Service Charge	<b>N/A</b>
Local Authority	<b>Spelthorne</b>
Council Tax	<b>per year (Band D)</b>

We have prepared these property particulars as a general guide to a broad description of the property. They are not intended to constitute part of an offer or contract. We have not carried out a structural survey and the services, appliances and specific fittings have not been tested. All photographs, measurements, floorplans and distances referred to are given as a guide only and should not be relied upon for the purchase of carpets or any other fixtures or fittings. Lease details, service charges and ground rents (where applicable) and council tax are given as a guide only and should be checked and confirmed by your solicitor prior to exchange of contracts. The copyright of all details, photographs and floorplans remain exclusive to Gregory Brown.

