



HILTON KING & LOCKE

SPECIALISTS IN PROPERTY



7A Churchfield Road, Chalfont St Peter, Buckinghamshire. SL9 9EN.

£1,100 pcm

A neat one bedroom property to the rear of Chalfont St Peter High Street , a charming village with a contemporary style.

First floor apartment accessed by stair well entering into an immaculate interior. Double bedroom complete with storage cupboard, shower room and WC.

The property is split level with living area over looking the main high street , spacious kitchen with dining area and guest cloakroom.

The property has the added bonus of one allocated parking.

Ideally situated for access to all local amenities including shops, cafes , bars and superb restaurants.

Bus and rail are within easy reach with the nearby Gerrards Cross train station with direct stop to London Marylebone and M40 minutes away.

Super long term rental ,highly desirable area with plenty to occupy and enjoy in the local surrounds.

Call 01753 643555 or email enquiries@hklhome.co.uk



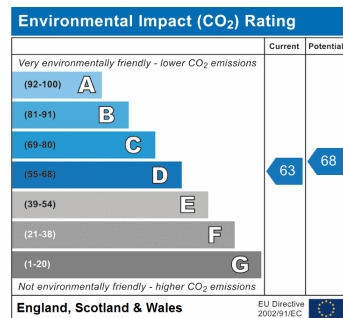
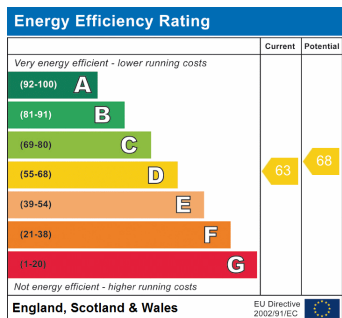

Important Notice

Particulars: These particulars are not an offer or contract, nor part of one. You should not rely on statements by Hilton King & Locke Ltd in the particulars or by word of mouth or in writing as being factually accurate about the property, its condition or its value. Hilton King & Locke Ltd does not have any authority to make any representations about the property, and accordingly any information given is entirely without responsibility on the part of the agents, seller(s) or lessor(s).

Photographs etc: The photographs show only certain parts of the property as they appeared at the time they were taken. Areas, measurements and distances given are approximate only.



20 Market Place
Chalfont St Peter Buckinghamshire SL9 9EA

Tel: 01753 480060
csp@hklhome.co.uk

7A Churchfield Road

Approximate Gross Internal Area

First Floor = 19.6 sq m / 211 sq ft

Second Floor = 33.7 sq m / 363 sq ft

Total = 53.3 sq m / 574 sq ft



First Floor

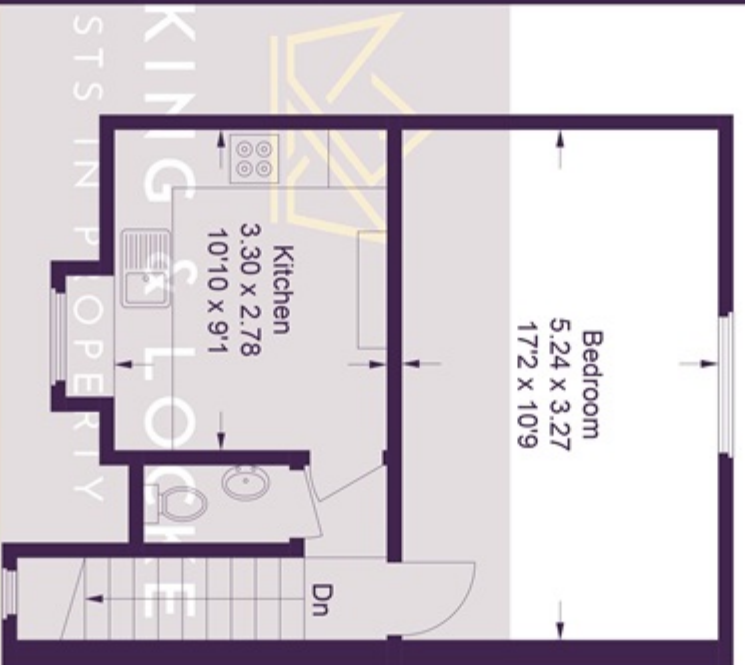

Second Floor

This plan is for layout guidance only. Not drawn to scale unless stated. Windows and door openings are approximate. Whilst every care is taken in the preparation of this plan, please check all dimensions, shapes and compass bearings before making any decisions reliant upon them.

© CJ Property Marketing Ltd Produced for Hilton King & Locke