



## 27 Reayrt Ny Crink, Crosby, Isle of Man. IM4 2EA

End Terraced 3 Bedroom home in a desirable location of Crosby with off road parking for 5 cars and rural views to the rear



£345,000 Freehold

## PROPERTY DESCRIPTION

---

Located at 27 Reayrt Ny Crink in Crosby, Isle of Man, this end terraced 3-bedroom house offers a comfortable and spacious living space. The property features a cozy lounge area, perfect for relaxing or entertaining guests. The addition of a conservatory provides a bright and airy space to enjoy the lawned garden and BBQ terrace area. The rear of the property overlooks the fields to the rear.

The house also boasts a breakfast kitchen, ideal for preparing meals and enjoying family time. Three bedrooms and a family bathroom, there is plenty of space for a growing family or visiting guests. Outside, a garden and patio area offer opportunities for outdoor enjoyment, while parking for up to 5 cars provides convenient and ample space for vehicles. Overall, this property is tucked away and provides a peaceful and comfortable living environment with a countryside setting.

## FEATURES

---

- Spacious End Terraced Home
- Convenient Location within Crosby
- Close to Crosby Public House
- Generous Lounge, Spacious Conservatory
- Breakfast Kitchen
- 3 Bedrooms plus Bathroom
- Private Rear Garden & Terrace with Rural Views
- Off Road Parking for five cars
- Gas Fired Central Heating
- Double Glazed
- Primary School, Co-op Shop Close By



# Property Images

---



# FLOORPLAN



GROUND FLOOR  
631 sq.ft. (58.6 sq.m.) approx.

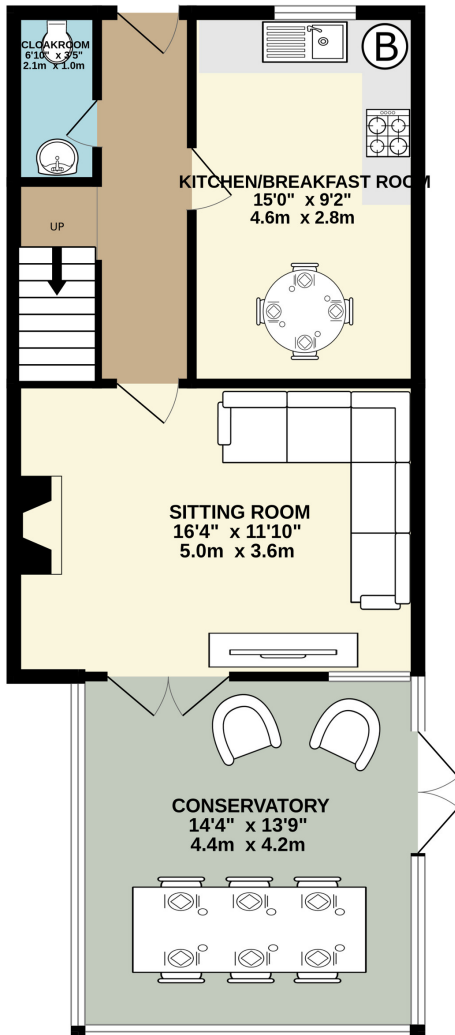

1ST FLOOR  
403 sq.ft. (37.5 sq.m.) approx.

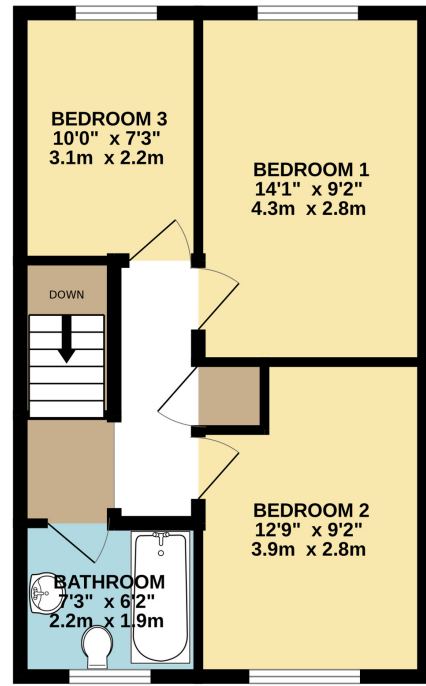

3 BED END TERRACE

TOTAL FLOOR AREA : 1034 sq.ft. (96.1 sq.m.) approx.

Whilst every attempt has been made to ensure the accuracy of the floorplan contained here, measurements of doors, windows, rooms and any other items are approximate and no responsibility is taken for any error, omission or mis-statement. This plan is for illustrative purposes only and should be used as such by any prospective purchaser. The services, systems and appliances shown have not been tested and no guarantee as to their operability or efficiency can be given.  
Made with Metropix ©2024

**DISCLAIMER:** Whilst Manxmove Ltd believe that these details are correct, neither Manxmove Ltd or their clients guarantee their accuracy in any way. Consequently, these details are not to be used to form part of any legally binding contract. Prospective purchasers or tenants are advised to visit this property to satisfy themselves as to the correctness of these details. Please note, we use wide angle camera lenses in order to show as much of each room as possible. This is not intended to mislead any prospective purchasers or tenants in any way and an honest verbal description is always available prior to viewing if required.

Manxmove Estate Agents - Douglas  
Victoria Road, Douglas, IM2 4HD  
01624 619966  
info@manxmove.im