



EASTCOTE LANE, HARROW

£2,300 pcm

**** AVAILABLE IMMEDIATELY **** A recently decorated three bedroom mid terrace house conveniently located for shops schools and transport links. The property briefly comprises entrance porch, hallway, through lounge/dining room, modern fitted kitchen, three bedrooms off landing and modern bathroom. Further benefits include double glazing, gas central heating, off street parking and private rear garden.

- AVAILABLE IMMEDIATELY
- THREE BEDROOM MID TERRACE HOUSE
- RECENTLY DECORATED THROUGHOUT
- CONVENIENTLY LOCATED FOR SHOPS, SCHOOLS AND TRANSPORT LINKS
- MODERN FITTED KITCHEN
- THROUGH LOUNGE/DINING ROOM
- MODERN BATHROOM
- ENTRANCE PORCH
- DOUBLE GLAZING & GAS CENTRAL HEATING
- OFF STREET PARKING AND PRIVATE REAR GARDEN

Ground Floor

Porch

Hallway

Open Plan Lounge/Dining Room

24' 10" into bay x 11' 4" max (7.57m x 3.45m)

Kitchen

10' 3" x 6' 3" (3.12m x 1.91m)

First Floor

Landing

Bedroom One

13' 5" x 10' 10" (4.09m x 3.30m)

Bedroom Two

10' 9" x 10' 10" (3.28m x 3.30m)

Bedroom Three

7' 3" x 5' 9" (2.21m x 1.75m)

Bathroom

7' 3" x 5' 8" (2.21m x 1.73m)

Outside

Front Garden

Off street parking

Rear Garden



DISCLAIMER: These particulars, whilst believed to be accurate are set out as a general outline only for guidance and do not constitute any part of an offer or contract. Intending purchasers should not rely on them as statements or representation of fact, but must satisfy themselves by inspection or otherwise as to their accuracy. We have not carried out a detailed survey nor tested the services, appliances and specific fittings. Room sizes should not be relied upon for carpets and furnishings. The measurements given are approximate. No person in this firms employment has the authority to make or give any representation or warranty in respect of the property.

GROUND FLOOR
451 sq.ft. (41.9 sq.m.) approx.

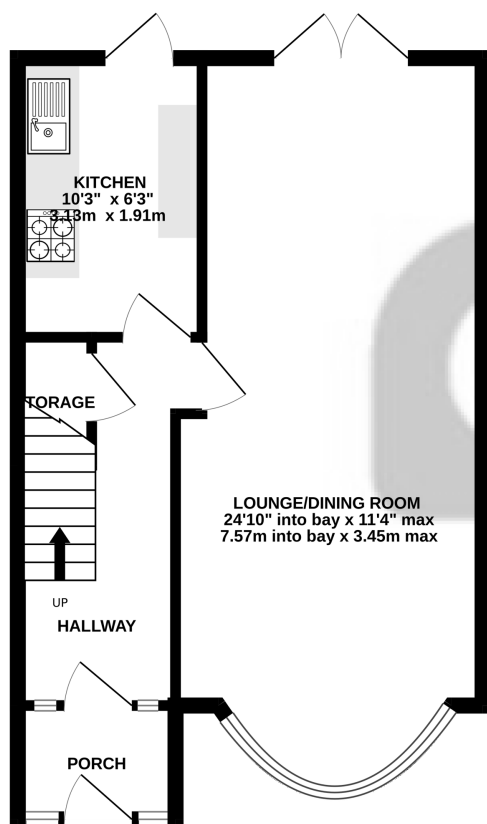

1ST FLOOR
379 sq.ft. (35.2 sq.m.) approx.

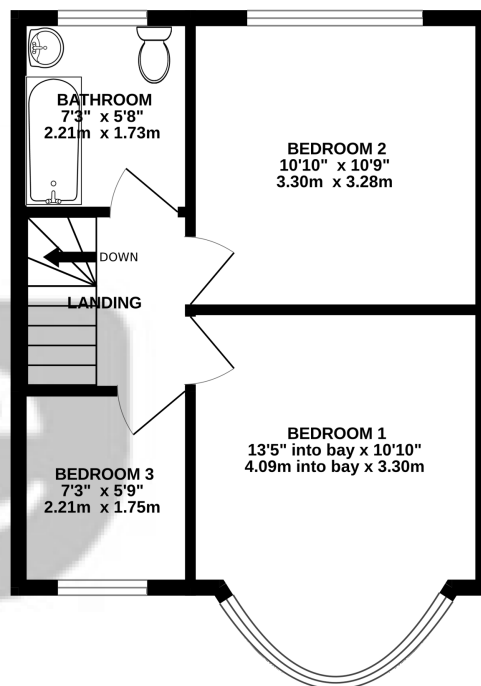

TOTAL FLOOR AREA : 830 sq.ft. (77.1 sq.m.) approx.

Whilst every attempt has been made to ensure the accuracy of the floorplan contained here, measurements of doors, windows, rooms and any other items are approximate and no responsibility is taken for any error, omission or mis-statement. This plan is for illustrative purposes only and should be used as such by any prospective purchaser. The services, systems and appliances shown have not been tested and no guarantee as to their operability or efficiency can be given.
Made with Metropix ©2025