



- Two Bedroom Terraced Home
- Central Colchester Location Close To An Array Of Amenities, Shops, Transport Links & Schools
- New Sash UPVC Windows Being Imminently Installed
- Reception Room With Feature Fireplace
- Dining Room
- Modern Kitchen
- Downstairs Cloakroom
- Two Double Bedrooms
- First Floor Bathroom
- Courtyard Style Garden

6 Cromwell Road, Colchester, Essex. CO2 7EN.

Cromwell Road, CO2 – Two Bedroom Terraced House, Central Colchester – No Onward Chain **Guide Price £210,000 - £220,000** Situated in a highly desirable central Colchester location, this property benefits from immediate access to an array of shops, amenities, restaurants, and bars. Colchester City Centre railway station is within easy reach, offering direct links to London Liverpool Street in under an hour, making this an ideal home for commuters and city-centre living.



Call to view 01206 576999



Property Details.

Ground Floor

Reception Room



11' 6" x 10' 8" (3.51m x 3.25m)

Inner Hallway

Dining Room



11' 2" x 10' 8" (3.40m x 3.25m)

Kitchen



7' 4" x 5' 11" (2.24m x 1.80m)

Downstairs Cloakroom

Utility Area

First Floor

Master Bedroom



11' 10" x 10' 8" (3.61m x 3.25m)

Property Details.

Bedroom Two



10' 10" x 10' 8" (3.30m x 3.25m)

Bathroom



7' 5" x 7' 4" (2.26m x 2.24m)

Property Details.

Floorplans

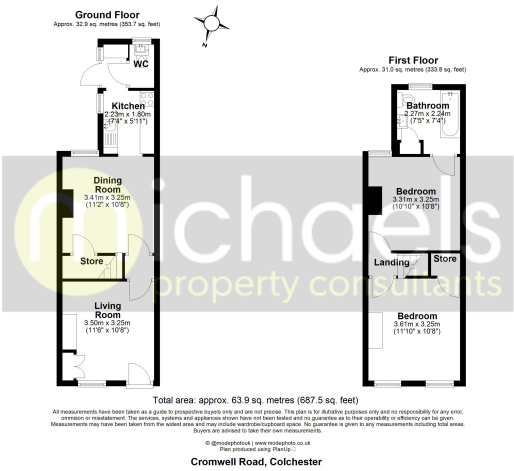

Location

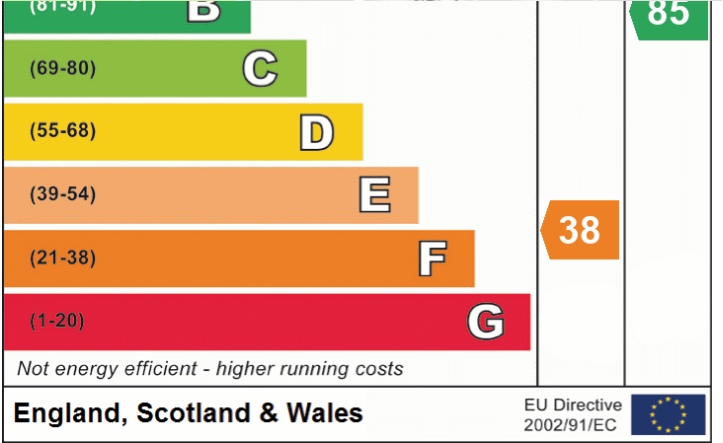
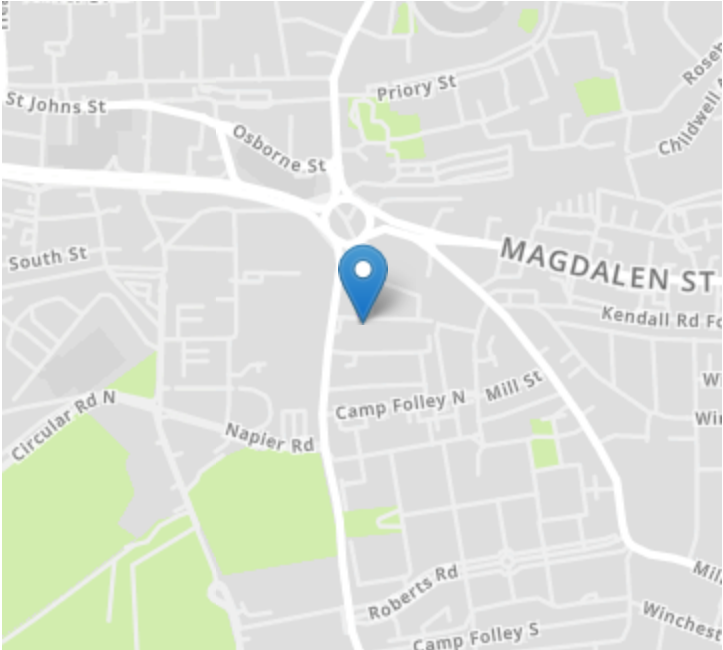

We have not carried out a structural survey and the services, appliances and specific fittings have not been tested. All photographs, measurements, floor plans and distances referred to are given as a guide only and should not be relied upon for the purchase of carpets or any other fixtures or fittings. Gardens, roof terraces, balconies and communal gardens as well as tenure and lease details cannot have their accuracy guaranteed for intending purchasers. Lease details, service ground rent (where applicable) are given as a guide only and should be checked and confirmed by your solicitor prior to exchange of contracts.