

# Dudsbury Road

West Parley, Dorset, BH22 8RG



**HEARNES**

WHERE SERVICE COUNTS



### Grand Entrance and Reception:

92 Dudsbury Road is a bold, contemporary home spanning over 4,200 sq. ft. of architecturally designed space.

A stunning atrium-style entrance with a mezzanine-esque first floor seamlessly leads into an elegant blend of family snug and formal dining areas. The mezzanine, featuring a full-size pool table, overlooks and interacts with the dining space below, enjoying a vaulted ceiling adorned with a modern crystal chandelier. The cozy snug is centered around an inset log burner, adding warmth and character. From this impressive 41-foot space, access flows effortlessly to many ground-floor rooms, including the cinema room, gaming room and home office.





### Kitchen Breakfast & Informal Dining:

The spacious 31-foot kitchen/breakfast area is exquisitely finished with polished black granite worktops, dual multifunction ovens, combination microwave, dual dishwashers, and a refrigerated wine storage unit with dual temperature zones. A striking crackle glass splashback and LED lighting enhance the contemporary design. Combined with the formal dining & snug area, this space forms the stunning heart of the home. The kitchen opens onto two hardwood decking areas, creating the perfect setting for alfresco dining and blending indoor-outdoor living for family meals and entertaining.





TOTAL FLOOR AREA : 4263 sq.ft. (396.1 sq.m.) approx.

Whilst every attempt has been made to ensure the accuracy of the floorplan contained here, measurements of doors, windows, rooms and any other items are approximate and no responsibility is taken for any error, omission or mis-statement. This plan is for illustrative purposes only and should be used as such by any prospective purchaser. The services, systems and appliances shown have not been tested and no guarantee as to their operability or efficiency can be given.  
Made with Metropix ©2024

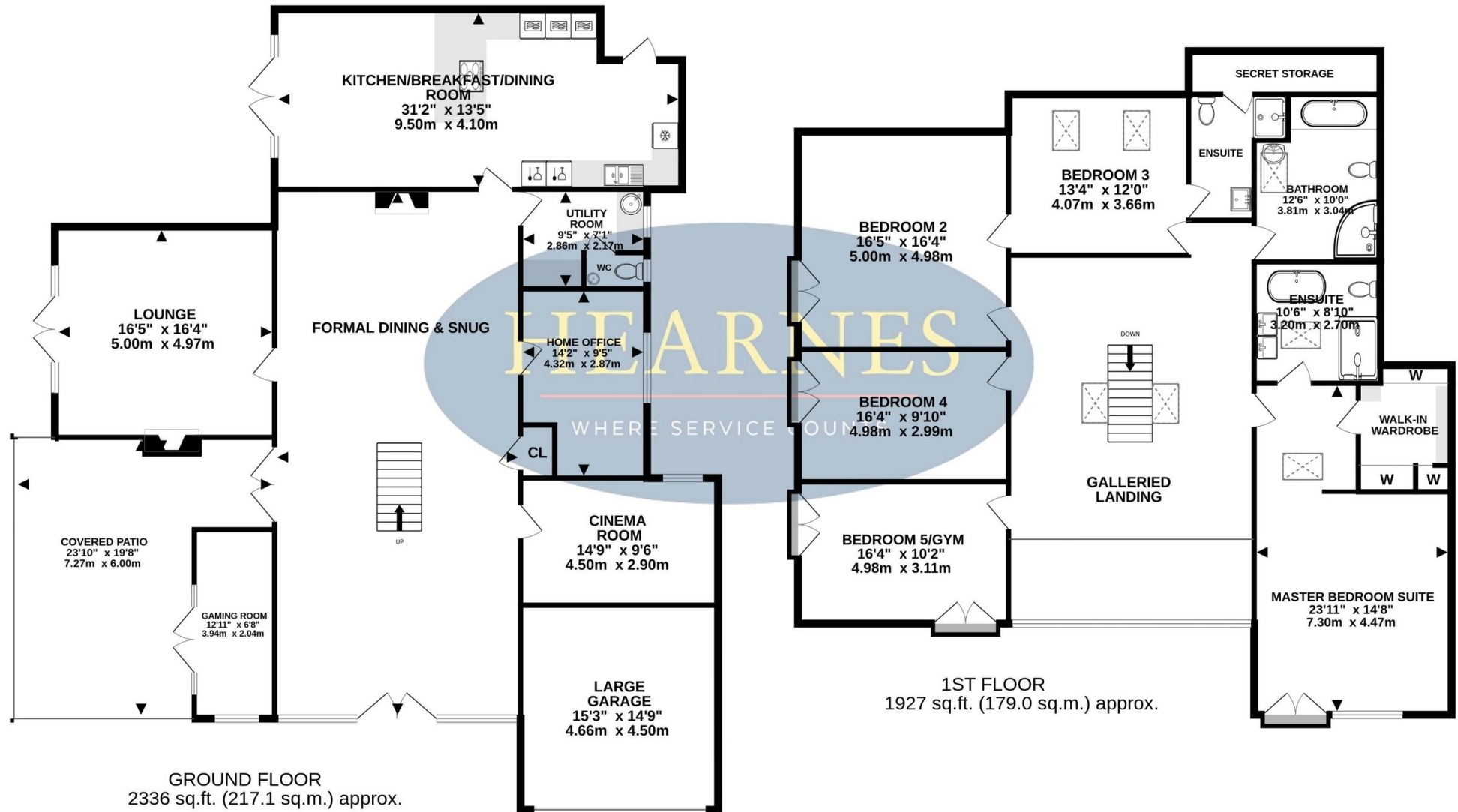

AGENTS NOTES: The heating system, mains and appliances have not been tested by Hearnese Estate Agents. Any areas, measurements or distances are approximate. The text, photographs and plans are for guidance only and are not necessarily comprehensive. Whilst reasonable endeavours have been made to ensure that the information in our sales particulars are as accurate as possible, this information has been provided for us by the seller and is not guaranteed. Any intending buyer should not rely on the information we have supplied and should satisfy themselves by inspection, searches, enquiries and survey as to the correctness of each statement before making a financial or legal commitment. We have not checked the legal documentation to verify the legal status, including the leased term and ground rent and escalation of ground rent of the property (where applicable). A buyer must not rely upon the information provided until it has been verified by their own solicitors.



### First Floor:

The first floor exudes grandeur, blending style & comfort. Vaulted ceilings and a mezzanine landing with full-width glazing flood the space with light. The architectural design creates a vertical connection between the grand entrance, the mezzanine-esque spacious galleried landing, and the formal dining and snug below. A modern crystal chandelier & remote-controlled blinds add sophistication. Spacious bedrooms feature Juliette balconies, full-height French doors, & blackout blinds for restful sleep. The master suite includes a walk-in wardrobe, dressing area, & luxurious ensuite. Bedrooms 3 & 4 have an interlink door for flexible annex-style accommodation. A stylish family bathroom & additional ensuite complete the well-appointed floor.





## Outdoors

High-quality hardwood decking, accessed from all south & rear-facing rooms, features remote-controlled LED lighting & power points, adding ambiance & functionality. An attached garage & extensive driveway provide ample parking. Oak-boarded fencing & automated full-height gates, accented with LED lighting, create a grand entrance, giving security, privacy & exclusivity. Planted borders & lawned areas beautifully complement the hardwood decking, offering well-planned, low-maintenance spaces perfect for relaxation, alfresco dining, & outdoor entertaining, enhancing the seamless indoor-outdoor living experience.





6-8 Victoria Road, Ferndown, Dorset, BH22 9HZ  
Tel: 01202 890890 Email: ferndown@hearnes.com



[www.hearnes.com](http://www.hearnes.com) Offices also at:  
Bournemouth, Poole, Ringwood & Wimborne