

Bowl Road, Battisford, Stowmarket



MARKS & MANN



- DETACHED BUNGALOW
- THREE/FOUR DOUBLE BEDROOMS
- UTILITY ROOM
- POPULAR VILLAGE LOCATION
- DOUBLE GLAZING THROUGHOUT
- OFF ROAD PARKING AND SINGLE GARAGE
- MODERN INTEGRATED KITCHEN
- FOUR PIECE BATHROOM
- POTENTIAL FOR FURTHER EXTENSION (STPP)

### Bowl Road, Battisford, Stowmarket

Offered for sale is this DETACHED THREE/FOUR bedroom bungalow with OFF ROAD PARKING and a SOUTH WEST facing rear garden. The home comprises of a living room, a modern kitchen, three/four bedrooms and a family bathroom. It has a sizable landscaped rear garden with a pond, apple tree and single garage, also a side garden and generously sized front garden with a four car driveway.

MARKS & MANN

99-101 Penshurst Rd, Ipswich, Suffolk, IP3 8QB.

01473 396 296

contactipswich@marksandmann.co.uk

Website [www.marksandmann.co.uk](http://www.marksandmann.co.uk)

**£430,000**

## Bowl Road, Battsford, Stowmarket

### INSIDE

#### Hallway

Spotlighting, radiator, storage cupboard, airing cupboard and wood effect flooring.

#### Lounge

4.25m x 3.34m (13' 11" x 10' 11")  
Overhead lighting, side aspect UPVC double glazed window, rear aspect UPVC double glazed sliding doors, radiator, log burner and wood effect flooring.

#### Kitchen

4.25m x 2.75m (13' 11" x 9' 0")  
Skimmed ceiling, spotlighting, two front aspect UPVC double glazed windows, side aspect UPVC double glazed window and wood effect flooring. Kitchen consists of a range of base and eye level units with integrated sink-drainer, range cooker, dishwasher, extraction unit and under counter fridge.

#### Utility Room

2.10m x 1.74m (6' 11" x 5' 9")  
Spotlighting, front aspect UPVC double glazed window, radiator and wood effect flooring, integrated sink-drainer and space for a washing machine, tumble dryer and fridge freezer.

#### Bedroom Two/Dining Room

3.66m x 3.32m (12' 0" x 10' 11")  
Currently being used as a dining room, overhead lighting, side aspect UPVC double glazed window, radiator and wood effect flooring.

#### Bedroom One

3.22m x 3.14m (10' 7" x 10' 4")  
Overhead lighting, skylight, side aspect UPVC double glazed French doors and window, rear aspect UPVC double glazed window, two radiators, built in wardrobe and wood effect flooring.

#### Bedroom Three

2.76m x 2.75m (9' 1" x 9' 0")  
Overhead lighting, front aspect UPVC double glazed window, radiator and wood effect flooring.

## Bowl Road, Battsford, Stowmarket

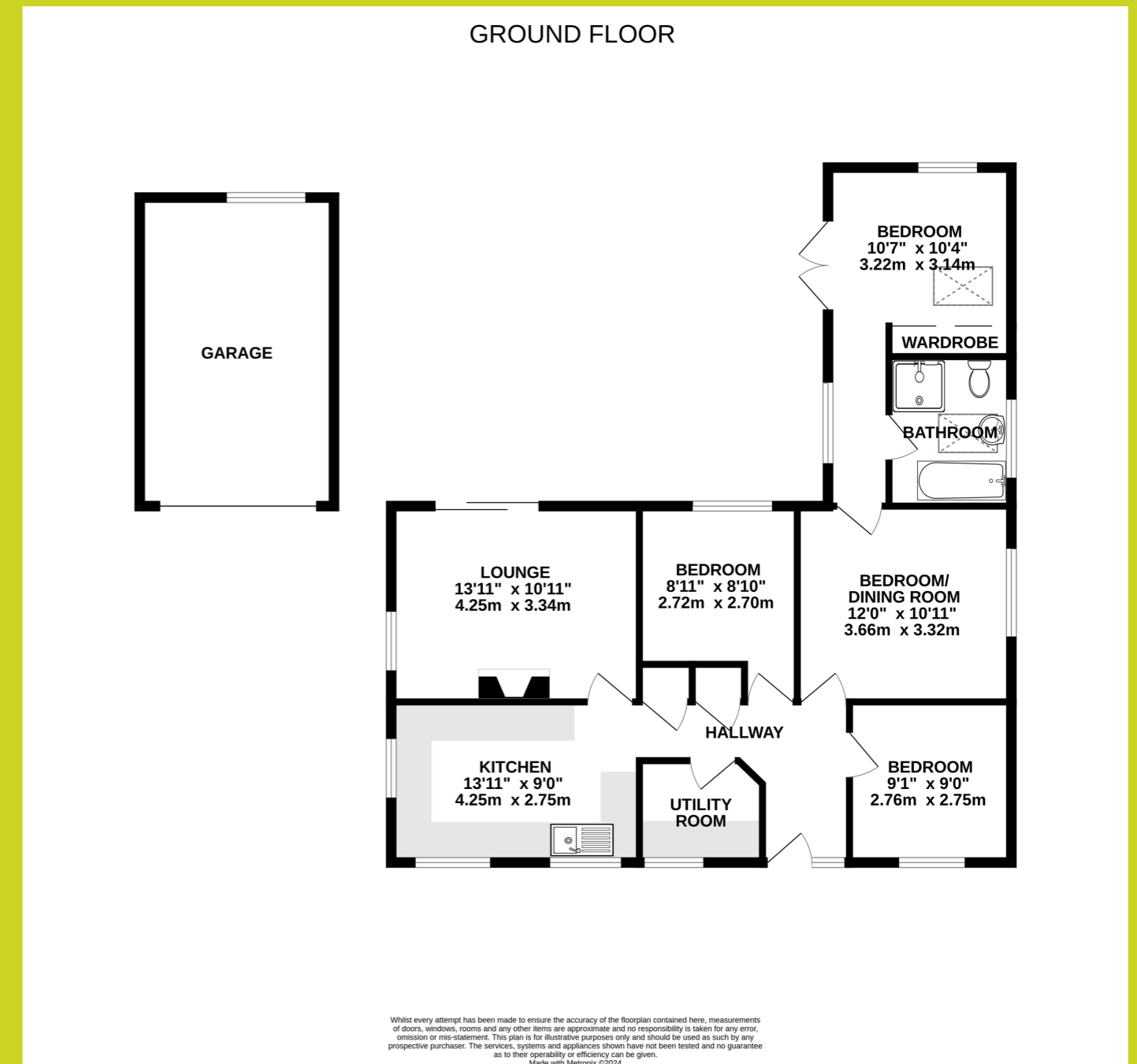

The above floor plans are not to scale and are shown for indication purposes only.

