



Weston Way, Baldock, Hertfordshire. SG7 6JG





## 1 Bedroom Ground Floor Maisonette £180,000 Leasehold

A modern one bedroom ground floor flat set in this popular development. The property benefits from its own front door, gas central heating and allocated parking. With a tasteful kitchen and bathroom and a generously sized bedroom, this would make a ideal first time purchase or a buy to let. The property is offered to the market on a chain free basis.



- One bedroom
- Ground floor
- Own front door
- Double glazed
- Allocated parking
- Chain free
- Modern development
- EPC rating C. Council tax band C

## Ground Floor

### Entrance:

Via own front door.

### Lounge:

Abt. 16' 0" x 13' 7" (4.88m x 4.14m) Two radiators. Double glazed window to front aspect. Carpet flooring. Opens to kitchen.

### Kitchen:

Abt. 8' 6" x 7' 3" (2.59m x 2.21m) Range of wall and base units. Plumbing for washing machine. Over hob extractor fan. Lino floor. Stainless steel sink and drain unit.

### Hall:

Radiator. Doors to wc and bedroom. Two sliding door cupboards.

## Bathroom:

Panelled bath. Low level wc. Pedestal wash hand basin. Radiator. Extractor fan. Lino flooring.

## Bedroom:

Abt. 15' 7" x 11' 0" (4.75m x 3.35m) Double glazed window to rear aspect. Radiator. Fitted carpet.



These particulars are a guide only and do not constitute an offer or a contract. The floor plan is for identification purposes only and not to scale. All measurements are approximate and should not be relied upon if ordering furniture, white goods and flooring etc. We have presented the property as we feel fairly describes it but before arranging a viewing or deciding to buy, should there be anything specific you would like to know about the property please enquire. Satchells have not tested any of the appliances or carried out any form of survey and advise you to carry out your own investigations on the state, condition, structure, services, title, tenure, and council tax band of the property. Some images may have been enhanced and the contents shown may not be included in the sale. Satchells routinely refer to 3rd party services for which we receive an income from their fee. If you would like us to refer you to one of these services please ask one of our staff who will pass your details on. We advise you check the availability of the property on the day of your viewing.

## Ground Floor

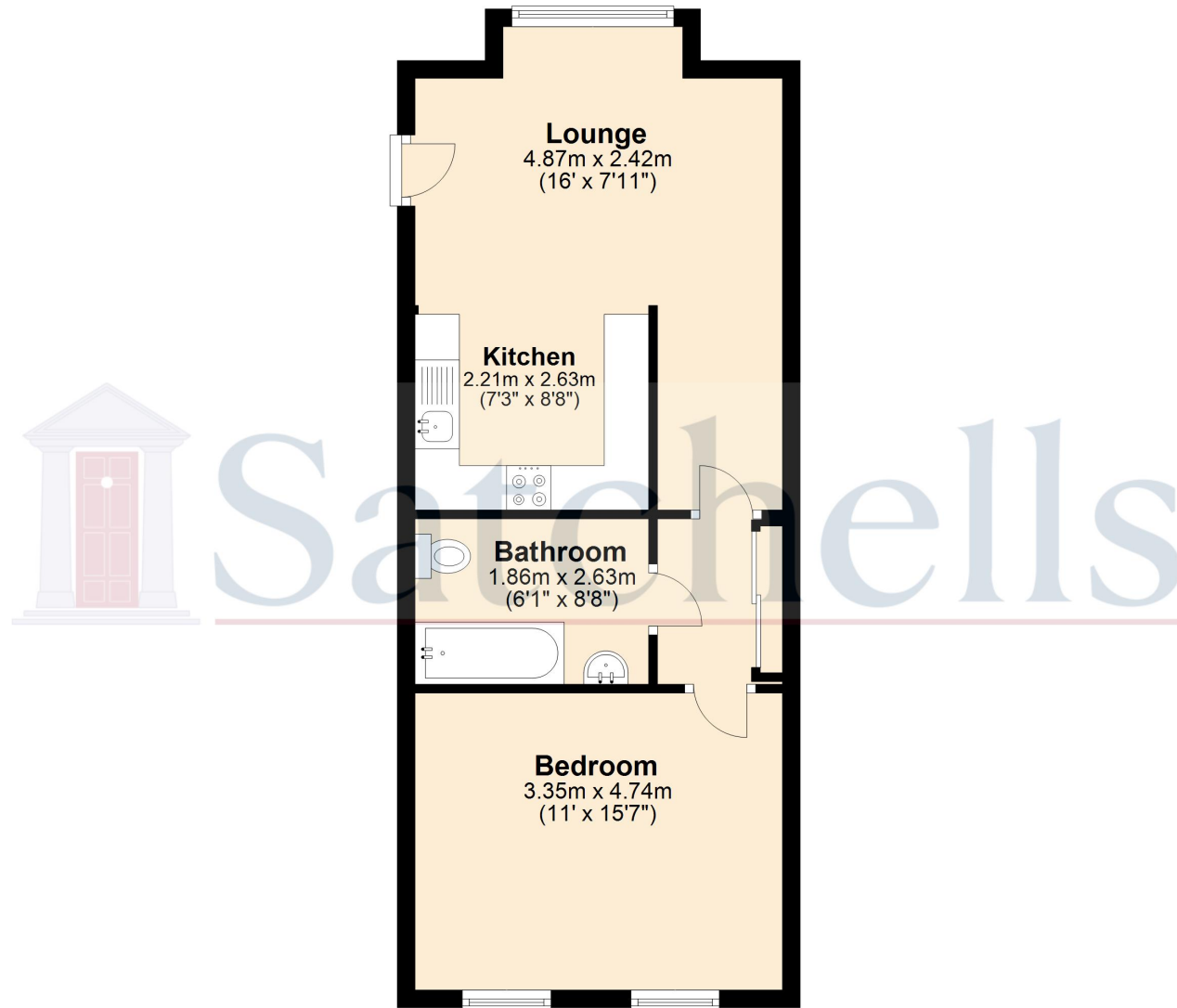

For illustrative purposes only - NOT TO SCALE - Measurements shown are approximate. The size and position of doors, windows, appliances and other features are approximate.  
Plan produced using PlanUp.