

Truuli



Mount Pleasant Road, London, SE13 6RB

£225,000 Share of Freehold

- Lower ground floor
- In need of cosmetic updating
- Share of freehold
- Prime high street location
- Close to Lewisham Park
- Within easy access of Hither Green and Catford Bridge Stations

Southbridge Place, Surrey, CR0 4HA

Tel: 0330 043 0002

Email: save@truuli.co.uk Web: www.truuli.co.uk

Mount Pleasant Road, London, SE13 6RB

£225,000 Share of Freehold

This is a fantastic opportunity to transform this lower ground floor one-bedroom maisonette on Mount Pleasant Road, Lewisham into the place of your dreams. Benefiting from its own private front door, this property offers a blank canvas for those seeking a renovation project to create a stylish and personalized home.

Ground Floor
617 sq.ft. (57.3 sq.m.) approx.

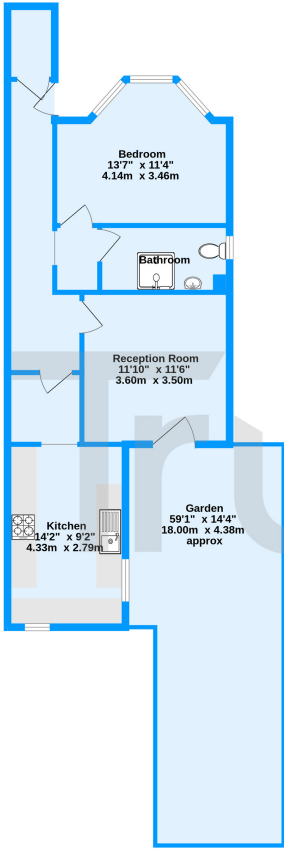

Mount Pleasant Road, Lewisham, SE13

TOTAL FLOOR AREA: 617 sq.ft. (57.3 sq.m.) approx.
Measurements are approximate. Not to scale. Illustrative purposes only
Made with Metropix ©2024

