



Day & Co
ESTATE AGENTS

28 Cavendish Street

Keighley

BD21 3RG



9 Upper Marsh Lane, Oxenhope,
Keighley, West Yorkshire, BD22
9RH

£195,000

T: 01535 664609

W: www.dayandcoestateagents.co.uk

E: keighley@dayandcoestateagents.co.uk

- Delightful Character Cottage In Rural Location
- Far Reaching Views Across Oxenhope & Countryside
- Gas Central Heating & Double Glazing

- Two Bedrooms
- South Facing Garden
- EPC RATING D

SUMMARY

** A DELIGHTFUL, CHARACTER STONE COTTAGE, TWO BEDROOMS, VIEWS, GAS CENTRAL HEATING, DOUBLE GLAZING, SOUTH FACING REAR PATIO GARDEN, DESIRABLE RURAL LOCATION, EPC RATING D **

FULL DESCRIPTION

Viewing is recommended for this character cottage set in a rural location with far reaching countryside views. Formerly a successful holiday let, due to enviable location close to Penistone Hill and Bronte Country.

Ground Floor:

Galley kitchen with range of fitted units, integrated oven, gas hob, fridge/freezer.

Access to cellar with vaulted ceiling.

Lounge with stove style gas fire, Porch with doorway leading to a South facing patio and enclosed garden with views across the valley towards Oxenhope and beyond.

First Floor:

Landing, storage cupboard

Two bedrooms with fitted wardrobes

Bathroom

Externally: Rear garden with flagged patio.

EPC Rating D

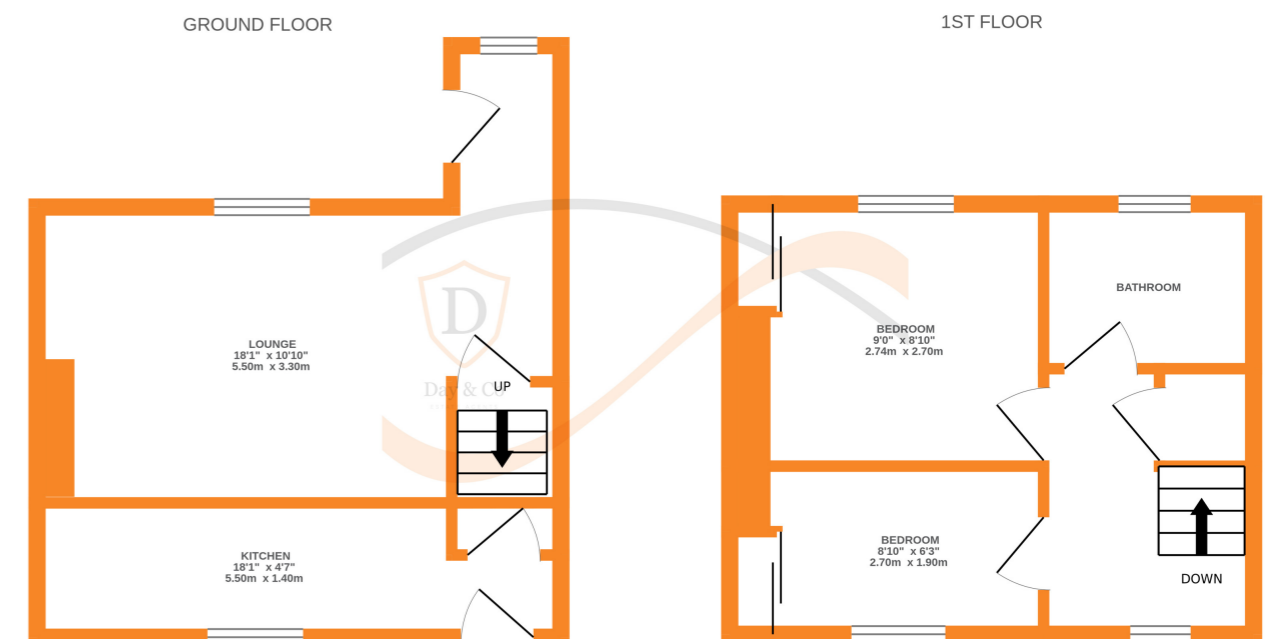

Whilst every attempt has been made to ensure the accuracy of the floorplan contained here, measurements of doors, windows, rooms and any other items are approximate and no responsibility is taken for any error, omission or mis-statement. This plan is for illustrative purposes only and should be used as such by any prospective purchaser. The services, systems and appliances shown have not been tested and no guarantee as to their operability or efficiency can be given.
Made with Metropix ©2024