



Property Cafe
BUYER INCENTIVE
AVAILABLE WHEN YOU VIEW
THIS PROPERTY THROUGH US

3 Nickles Close, Bexhill-on-Sea, East Sussex,
TN39 4GF

£389,950



- BUYERS INCENTIVES AVAILABLE WITH THIS PROPERTY:
- Modern Three Bed Family Home
- West Facing Lounge With Bay Window
- Modern Full Width Kitchen-Diner
- Master Bedroom With En-Suite
- Modern Family Bathroom & G.Floor W/C
- Extra Size Plot With Potential & Scope
- Central Heated & Double Glazed
- Off Road Parking For x2 Cars (Further Scope)
- Sought After Rosewood Park Development
- Built By David Wilson (Award Winning Developers)
- Pleasant Area Of Front Garden
- An Immaculate Property Throughout
- Quality Carpets & Floor Coverings
- Additional Fixtures & Fittings Negotiable
- Fitted with Security & Soffit Lighting
- Quiet Cul-De-Sac With Woodland Frontage
- New Build NHBC Guarantees



GROUND FLOOR
799 sq.ft. (74.2 sq.m.) approx.

1ST FLOOR
430 sq.ft. (40.0 sq.m.) approx.

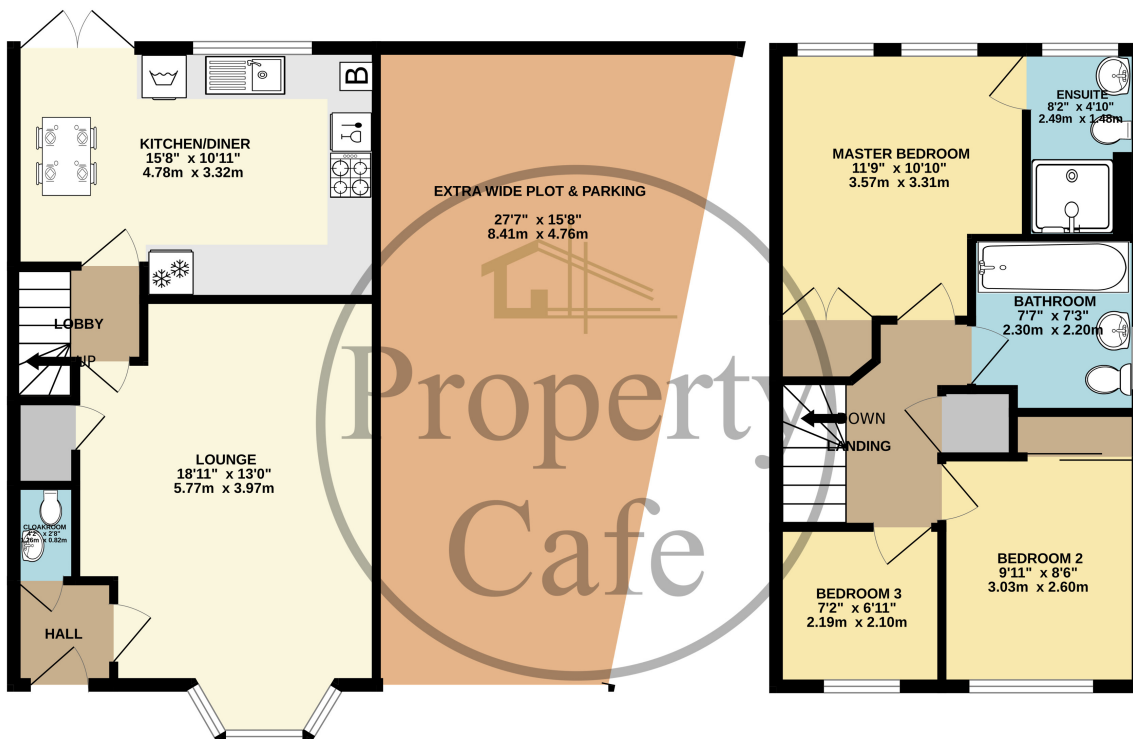

TOTAL FLOOR AREA : 1229 sq.ft. (114.2 sq.m.) approx.

Whilst every attempt has been made to ensure the accuracy of the floorplan contained here, measurements of doors, windows, rooms and any other items are approximate and no responsibility is taken for any error, omission or mis-statement. This plan is for illustrative purposes only and should be used as such by any prospective purchaser. The services, systems and appliances shown have not been tested and no guarantee as to their operability or efficiency can be given.
Made with MetroPix ©2024

