



THE ESTATE AGENTS
1977



Wheatfield Road, Northampton NN3 2NE
Offers Over £230,000 - Freehold



PROPERTY DESCRIPTION

The Estate Agents are pleased to present this three bedroom property in a popular residential area of Abington. The accommodation briefly comprises; a spacious and welcoming entrance hall, large living room, kitchen/dining room and WC. On the first floor are two double bedrooms, a further bedroom/study and family bathroom. Outside the property there's a drive to the front with off road parking and a generous rear garden with a covered patio and space for a garden shed. The property has plenty of scope to improve and extend (subject to relevant permissions).

Situated within easy reach of local amenities, Abington Park, bars, restaurants and cafés can be found on the vibrant Wellingborough Rd and a choice of primary and secondary schools in the area.

POINTS OF INTEREST

- Three Bedrooms
- Ground Floor WC
- Two Double Bedrooms
- Off Road Parking
- Large Rear Garden
- Covered Patio
- Scope To Improve/Extend (STPP)
- No Upward Chain

GROUND FLOOR
440 sq.ft. (40.9 sq.m.) approx.

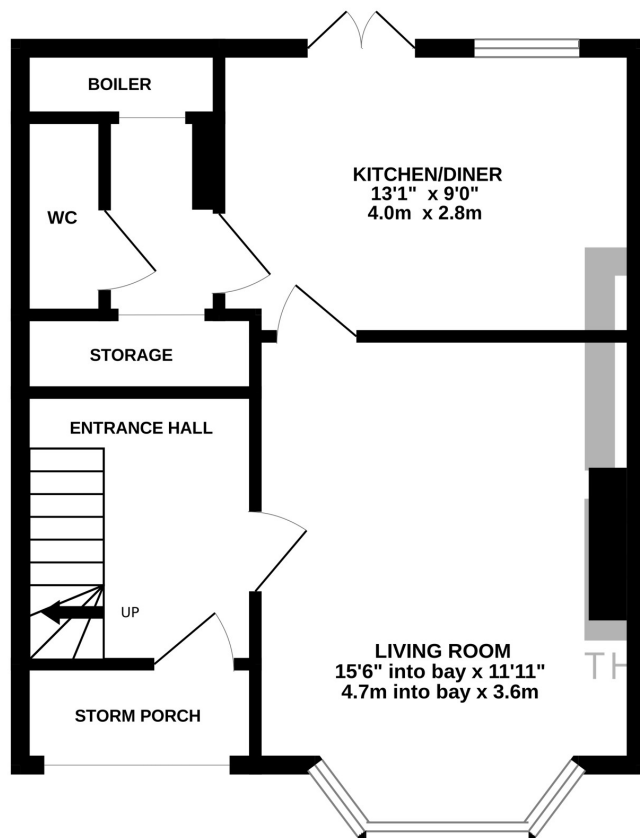

1ST FLOOR
404 sq.ft. (37.5 sq.m.) approx.

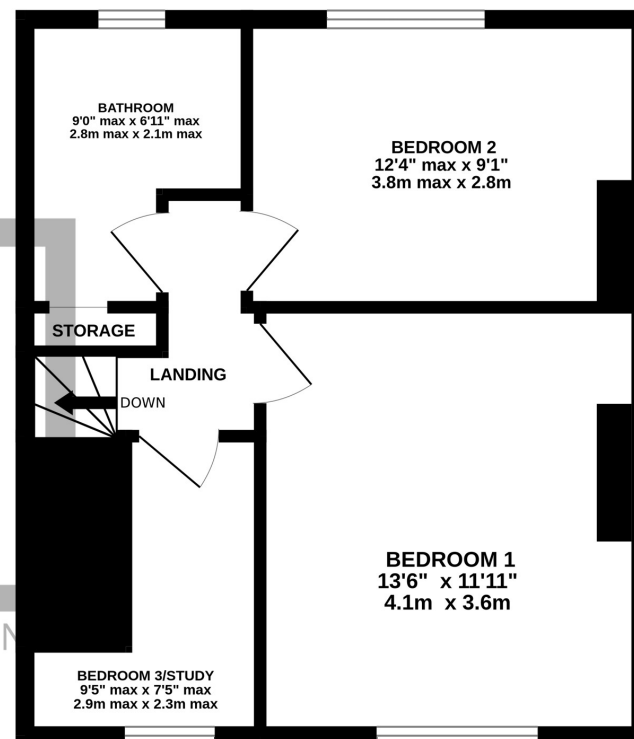

TOTAL FLOOR AREA : 844 sq.ft. (78.4 sq.m.) approx.

Whilst every attempt has been made to ensure the accuracy of the floorplan contained here, measurements of doors, windows, rooms and any other items are approximate and no responsibility is taken for any error, omission or mis-statement. This plan is for illustrative purposes only and should be used as such by any prospective purchaser. The services, systems and appliances shown have not been tested and no guarantee as to their operability or efficiency can be given.
Made with Metropix ©2024