



5 The Mews., Norton Hall Farm, Letchworth, Herts., SG6 1AL

Guide Price £215,000

Lane & Bennett's are pleased to present this unique Mews style apartment, located at the sought after Norton Hall farm development which provides exclusive independent living for the over 55's, set in Landscaped grounds, but close to local amenities; A restaurant and bar, garden centre and cafe are nearby, a post office and convenience store within walking distance, as is a bowls club, Church and open countryside including the famous Greenway 13 mile circuit

This double bedroom Mews house has a large dual aspect lounge diner, a fitted kitchen with appliances, good sized bathroom and ample storage. There is private off road parking, and



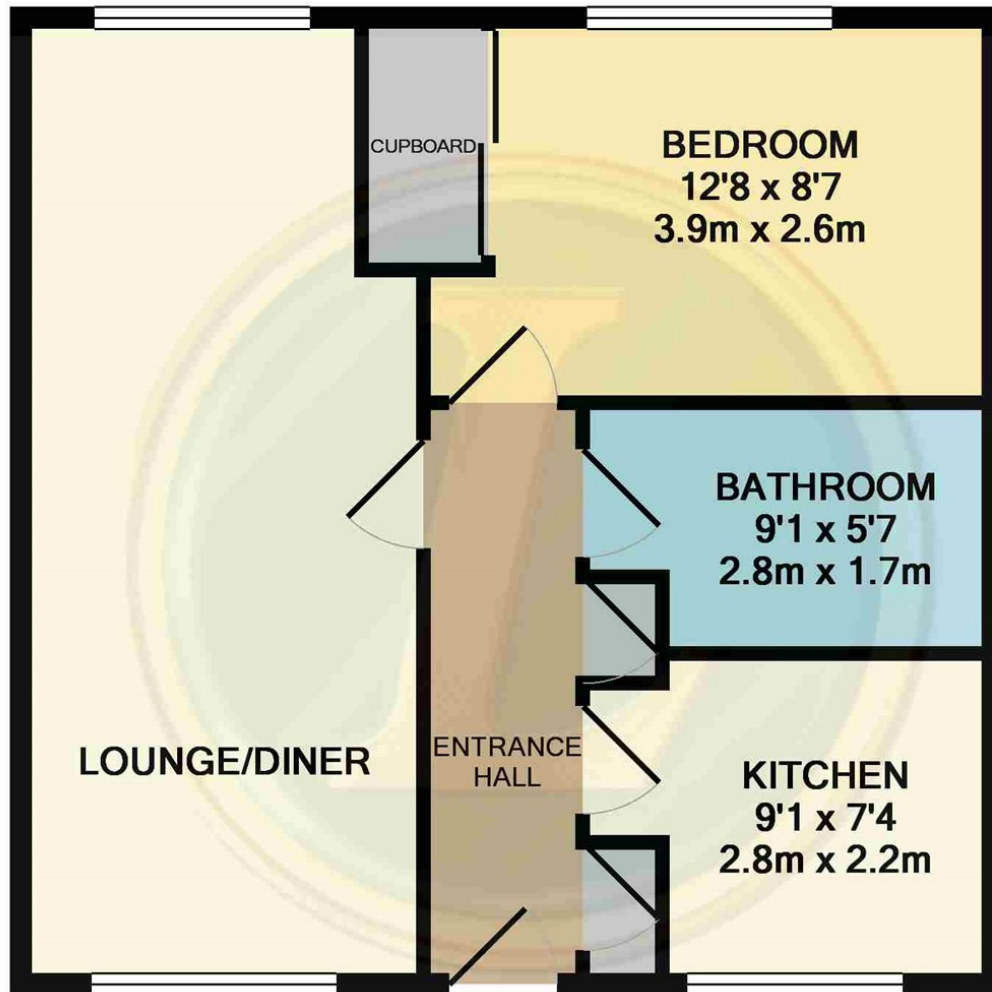

- Individual Mews style home
- Large lounge and Diner
- EXCLUSIVE LIVING FOR THE OVER 55's
- Double bedroom
- Fitted kitchen
- CHAIN FREE
- Bathroom
- Beautiful landscaped gardens
- Communal facilities available
- On site duty manager

Measurements are approximate. Not to scale. Illustrative purposes only
Made with Metropix ©2018

