



Flat 174 Foundry Court Mill Street, Slough, Berkshire. SL2 5FZ.
£195,000

- ONE BEDROOM APARTMENT
- MODERN DEVELOPMENT
- 110 YEAR LEASE
- SECOND FLOOR

- BALCONY
- SPACIOUS ACCOMMODATION
- ALLOCATED PARKING
- IDEAL FOR INVESTORS OR FIRST TIME BUYERS

Flat 174 Foundry Court Mill Street, Slough, Berkshire. SL2 5FZ.

£195,000

Modern second floor apartment conveniently located within walking distance to Slough Town Centre and Slough Mainline Train Station. Features include entrance hall, spacious living room leading onto a private balcony, fully fitted kitchen with integrated appliances, bedroom with large built-in wardrobe, bathroom, one allocated parking space, and security entry phone system. The property has a lease of 110 years and benefits from having a tenant in situ with a rental income of £875pcm, making the property an ideal purchase for an investor or a first-time buyer.

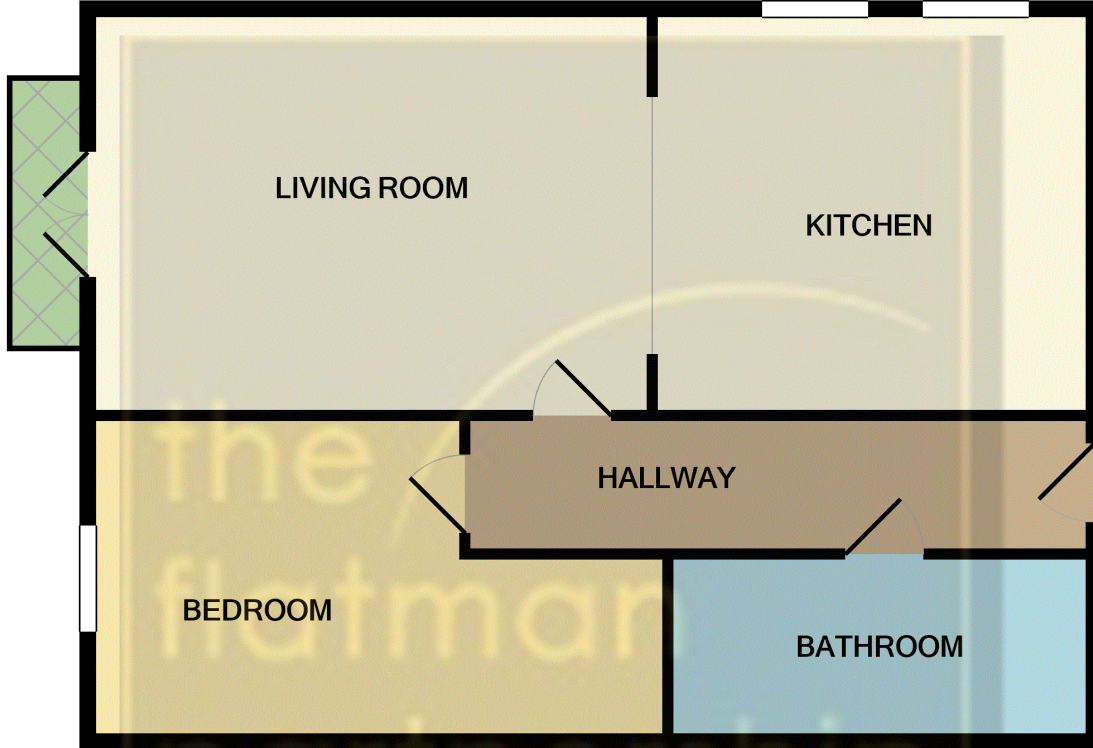

TOTAL APPROX. FLOOR AREA 637 SQ.FT. (59.2 SQ.M.)

Whilst every attempt has been made to ensure the accuracy of the floor plan contained here, measurements of doors, windows, rooms and any other items are approximate and no responsibility is taken for any error, omission, or mis-statement. This plan is for illustrative purposes only and should be used as such by any prospective purchaser. The services, systems and appliances shown have not been tested and no guarantee as to their operability or efficiency can be given

Made with Metropix ©2021

