



25 St James Heights, Paradise Walk, Bexhill-On-Sea, East Sussex, TN40 2LG
£795 pcm





The Property Café are delighted to offer TO LET this immaculate one bedroom top floor purpose built apartment situated in a sought after Pebsham location with benefits to include: A secure communal entrance with entry phone system and lift access to all floors: The apartment can be found on the top floor (4th): The inner hall leads to: A spacious open plan lounge-diner with ample space for both relaxing & entertaining with patio doors leading to a small West facing balcony that enjoys pleasant views. There is a modern open plan fitted kitchen with built in appliances, a modern bathroom and a good size double bedroom. To the front there is an allocated parking space. The property also benefits from double glazing, under floor heating and is immaculately presented throughout and an internal viewings is highly recommended. To arrange a viewing, please contact the Bexhill office 01424 224488.



TOP FLOOR APARTMENT
512 sq.ft. (47.6 sq.m.) approx.

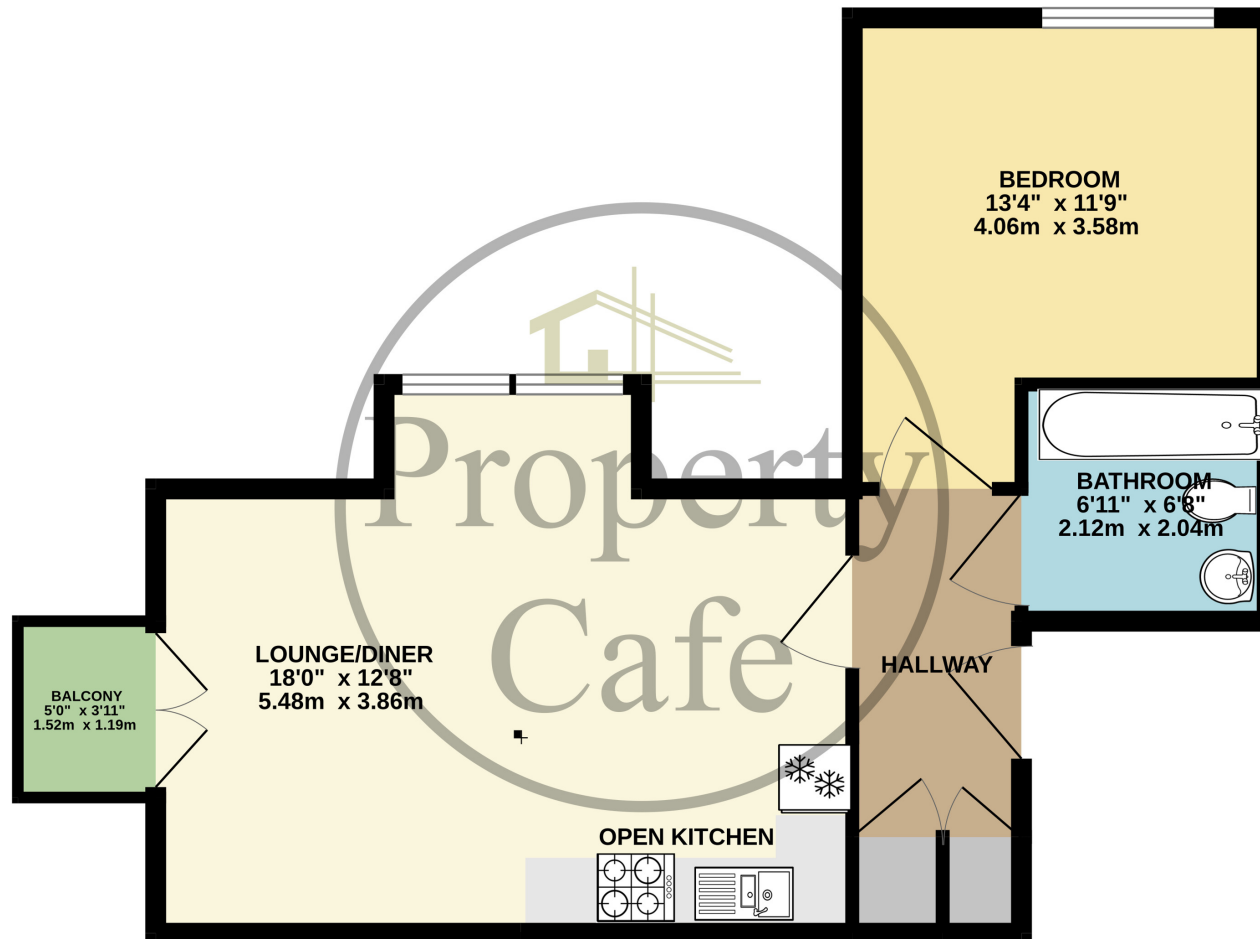

TOTAL FLOOR AREA : 512 sq.ft. (47.6 sq.m.) approx.

Whilst every attempt has been made to ensure the accuracy of the floorplan contained here, measurements of doors, windows, rooms and any other items are approximate and no responsibility is taken for any error, omission or mis-statement. This plan is for illustrative purposes only and should be used as such by any prospective purchaser. The services, systems and appliances shown have not been tested and no guarantee as to their operability or efficiency can be given.

Made with Metropix ©2023







- Spacious top floor flat to let.
- Open plan lounge/diner with balcony.
 - Modern open plan kitchen.
 - Good size double bedroom.
- Modern fitted bathroom.
- Lift access and security entry phone system.
 - Off road allocated parking.
- Underfloor heating and double glazing.
- Sought after Pebsham location.
 - Available now.