



51

GB



51 Normanhurst, Ashford, Surrey TW15 2NT
£425,000 - Freehold



PROPERTY DESCRIPTION

Conveniently situated at the end of Ashford High Street so within easy walking distance of the high street shops, train station, schools and all local amenities. This is a four bedroom mid terraced house in need of updating so would ideally suit a DIY enthusiast. The accommodation comprises as follows, on the ground floor a lounge/diner, kitchen, wc. on the first floor are three good size bedrooms and a shower room and on the second floor is bedroom number four, enclosed gardens to the front and rear with two storage sheds with power in the front garden both measuring 9' x 5'. The property is being sold with no onward chain.

POINTS OF INTEREST

- Town centre location
- Four bedrooms
- Downstairs WC
- Updating required
- Lounge/diner
- Enclosed front & rear gardens
- Walking distance to station
- No onward chain





GROUND FLOOR
436 sq.ft. (40.5 sq.m.) approx.

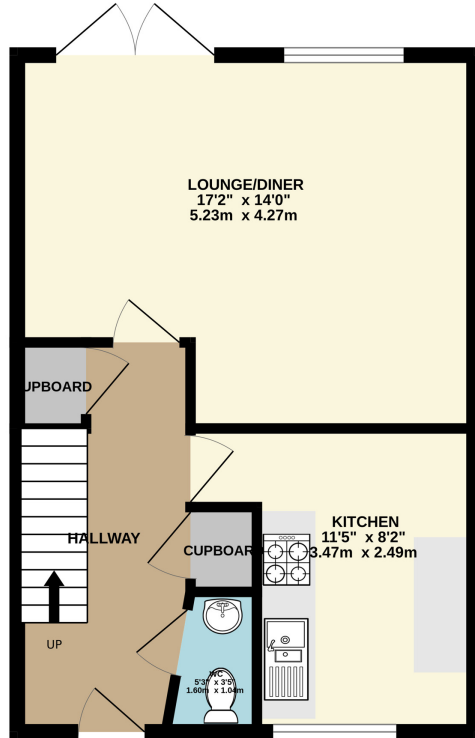

1ST FLOOR
436 sq.ft. (40.5 sq.m.) approx.

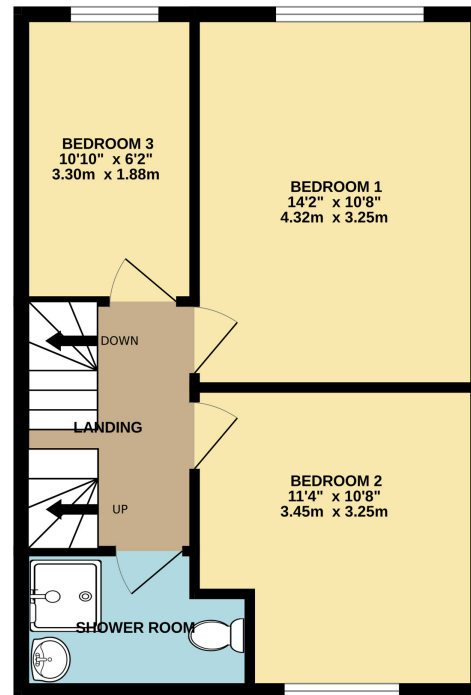

2ND FLOOR
197 sq.ft. (18.3 sq.m.) approx.

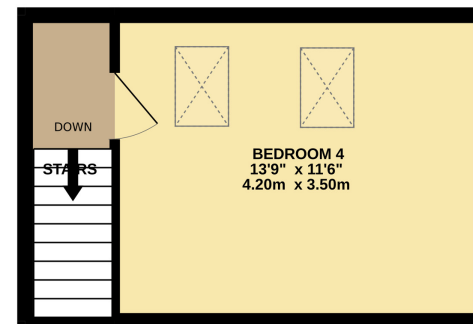

TOTAL FLOOR AREA : 1070 sq.ft. (99.4 sq.m.) approx.

Whilst every attempt has been made to ensure the accuracy of the floorplan contained here, measurements of doors, windows, rooms and any other items are approximate and no responsibility is taken for any error, omission or mis-statement. This plan is for illustrative purposes only and should be used as such by any prospective purchaser. The services, systems and appliances shown have not been tested and no guarantee as to their operability or efficiency can be given.

Made with Metropix ©2025