



One Bedroom End of Terrace House  
Stonecross Lea, Chatham, Kent, ME5 0BL

Offers in Excess of £205,000  
Freehold

## Stonecross Lea, Chatham, Kent, ME5 0BL

Offers in Excess of £205,000

Freehold

### Description

An opportunity for the first time buyer to purchase this one bedroom starter home. You will not be disappointed as this lovely home is ready to move into & is a great opportunity for investment too.

The property offers an open plan kitchen and good size lounge area. The kitchen offers a range of fitted wall and base units, integrated electric hob & oven and ample worksurfaces. Also further under stairs storage. Moving upstairs you are welcomed to a good size bedroom and modern fitted bathroom with shower over.

Outside there is a low maintenance garden which is a great space to chill and unwind in, front garden laid to lawn and an allocated parking space.

### Key Features

- Early viewing recommended
- 1 Bedroom Starter Home
- Immaculate Condition Throughout
- Ideal First Purchase or Investment
- Allocated Parking Space
- Open Plan Living
- Modern Fitted Kitchen & Bathroom
- Side Garden

### Local Area

Chatham is located within the Medway towns with good transfer links by rail into Central London and Ebbsfleet International plus road connections to the M2/M25 & M20. Amenities include a bustling Town Centre, the Historic Dockyard, Capstone Ski & Snowboard centre and nearby Gillingham FC and Rochester Castle & Cathedral.

GROUND FLOOR  
240 sq.ft. (22.3 sq.m.) approx.

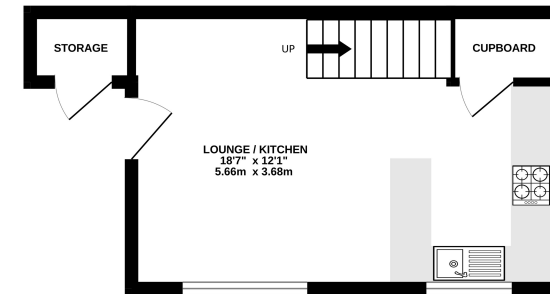

1ST FLOOR  
226 sq.ft. (21.0 sq.m.) approx.

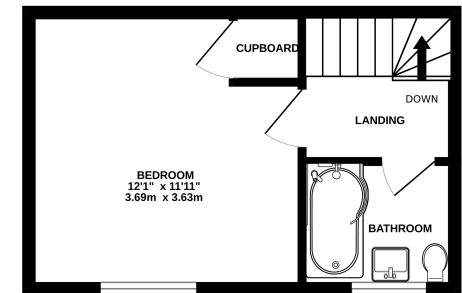

TOTAL FLOOR AREA: 466 sq.ft. (43.3 sq.m.) approx.  
Whilst every attempt has been made to ensure the accuracy of the floorplan contained here, measurements of doors, windows, rooms and any other items are approximate and no responsibility is taken for any error, omission or mis-statement. This plan is for illustrative purposes only and should be used as such by any prospective purchaser. The services, systems and appliances shown have not been tested and no guarantee as to their operability or efficiency can be given.  
Made with Metropix ©2024



## Property Location

Stonecross Lea, Chatham, Kent, ME5 0BL

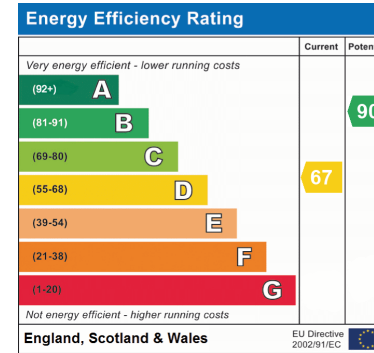
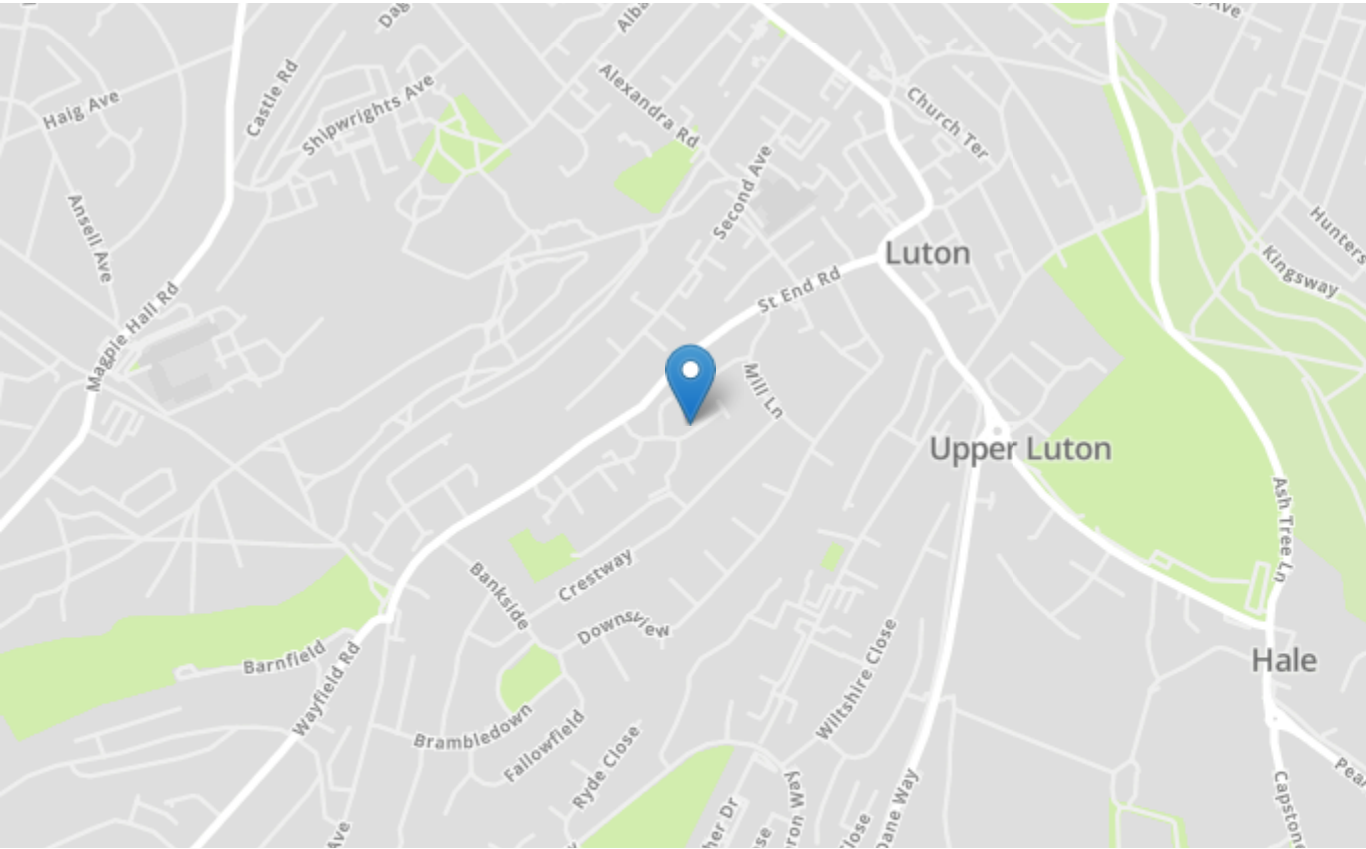

<b>Tenure</b>	Freehold
<b>Lease Term</b>	N/A
<b>Ground Rent</b>	N/A
<b>Service Charge</b>	N/A
<b>Local Authority</b>	Medway
<b>Council Tax</b>	Band B

### Greyfox Walderslade

Unit 2, Thetford House  
 Walderslade Village Centre  
 Walderslade Road  
 Chatham  
 Kent  
 ME5 9LR  
 Tel: 01634 672227 Email:  
 walderslade@greyfox.co.uk

### Greyfox Rainham

67C High Street  
 Rainham  
 Kent  
 ME8 7HS  
 Tel: 01634 377737 Email:  
 rainham@greyfox.co.uk

#### Agent Notes

These particulars are prepared as a general guide to a broad description of the property and should not be relied upon as a statement or representation of fact and do not constitute part of an offer or contract. The seller does not make or give nor do our employees or Greyfox have authority to make or give any representation or warranty to the property. We have not carried out a structural survey and the services, appliances and specific fittings have not been tested. All photographs, measurements, floorplans and distances referred to are given as a guide only and should not be relied upon for the purchase of carpets or any other fixtures or fittings. Lease details, service charges and ground rent (where applicable) and council tax are given as a guide only and should be checked and confirmed by you on inspection and your solicitor prior to exchange of contracts. If there are any points of particular importance to you we will be pleased to check the information for you and to confirm that the property remains available. This is particularly important should you be travelling some distance to view and where statements have been made by us to the effect that the information has not been verified. The copyright of all details, photographs and floorplans remain exclusive to Greyfox. For details of our privacy policy and referral fee arrangements with any of our selected partner companies please visit <https://www.greyfox.co.uk/legal/privacy> and <https://www.greyfox.co.uk/referral-fees>.