



**8 Vicarage Court, Wendover Road, Staines. TW183DF.**

**1 Bedroom Apartment - £305,000 OIEO Leasehold**



# 8 Vicarage Court, Wendover Road, Staines. TW183DF.

01784 451458

## 1 Bedroom Apartment - £305,000 OIEO Leasehold

STUNNING APARTMENT SITUATED IN THIS LUXURIOUS NEWLY CONSTRUCTED DEVELOPMENT IDEALLY LOCATED JUST MOMENTS OF STAINES TOWN CENTRE, PROVIDING EASY ACCESS TO LOCAL MOTORWAY NETWORKS & HEATHROW AIRPORT. The property benefits from a spacious lounge/diner with private balcony, luxury fitted kitchen, large double bedroom, separate W.C, modern white bathroom suite, allocated parking and a very long lease. Viewings Highly Recommended!

### Key Features

STUNNING APARTMENT  
LUXURIOUS NEWLY BUILT DEVELOPMENT  
PARKING  
PRIVATE GATED DEVELOPMENT  
EASY ACCESS TO LOCAL MOTORWAY NETWORKS & HEATHROW AIRPORT  
WITHIN MOMENTS OF TOWN CENTRE

Approximate Gross Internal Area 551 sq ft - 51 sq m

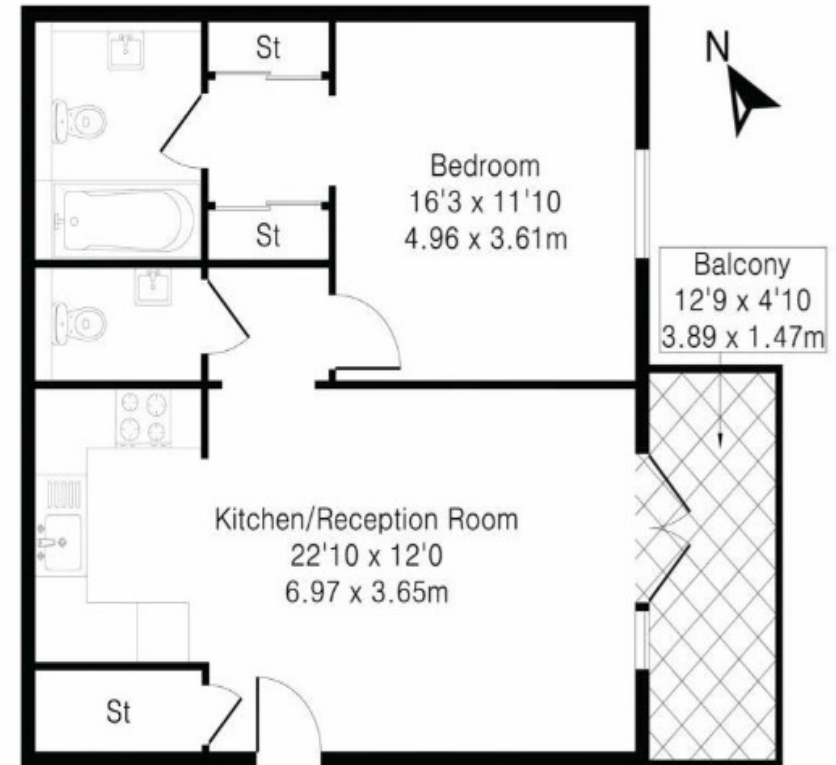

First Floor



**GREGORY BROWN**  
RESIDENTIAL SALES & LETTINGS









214 8 Vicarage Court, Wendover Road, Staines.  
TW183DF.

gregory-brown.co.uk

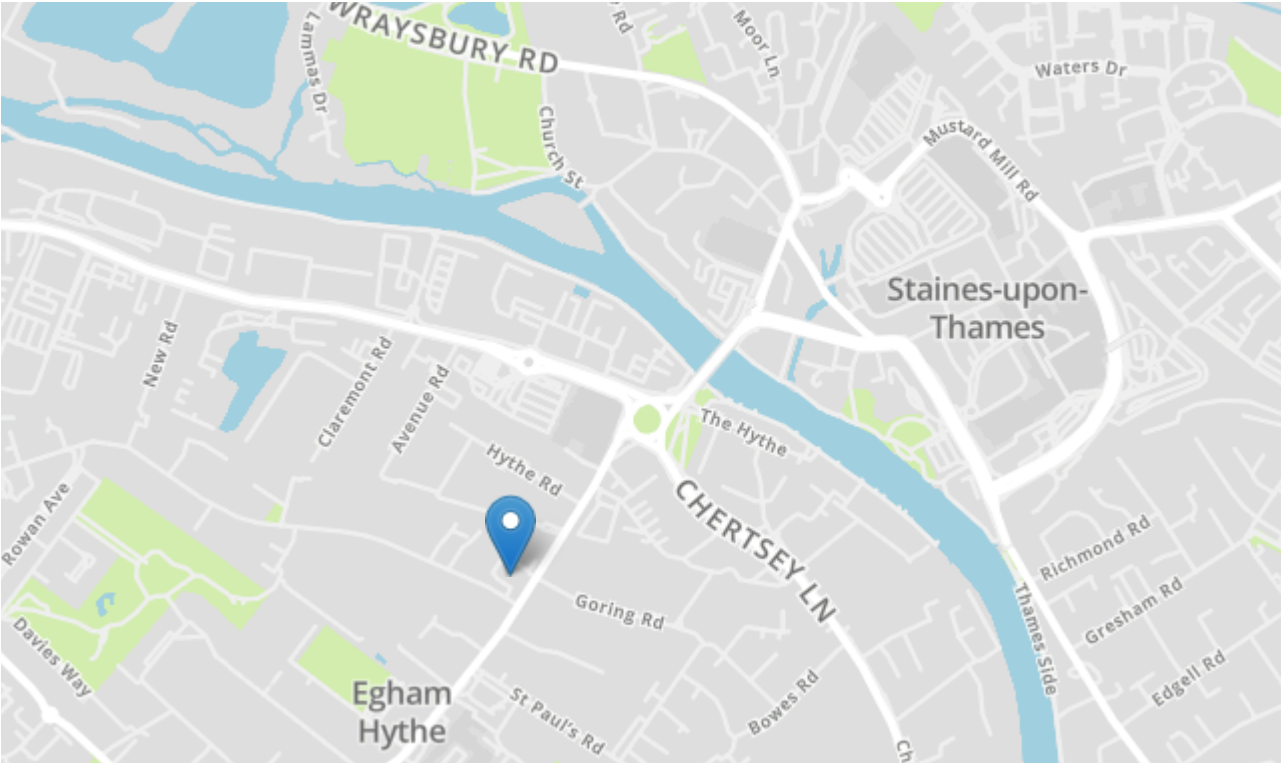

Tenure	Leasehold
Lease Term	To Be Confirmed
Ground Rent	To Be Confirmed
Service Charge	To Be Confirmed
Local Authority	
Council Tax	

We have prepared these property particulars as a general guide to a broad description of the property. They are not intended to constitute part of an offer or contract. We have not carried out a structural survey and the services, appliances and specific fittings have not been tested. All photographs, measurements, floorplans and distances referred to are given as a guide only and should not be relied upon for the purchase of carpets or any other fixtures or fittings. Lease details, service charges and ground rents (where applicable) and council tax are given as a guide only and should be checked and confirmed by your solicitor prior to exchange of contracts. The copyright of all details, photographs and floorplans remain exclusive to Gregory Brown.

