

Thornycroft Avenue, DEEPCUT, GU16 6FL

Guide Price £475,000 Freehold

Jigsaw Estates are proud to present to the market this recently constructed property built by CALA Homes and further updated by the current owners. The property is situated on the brand new Mindenhurst development in Deepcut within close proximity of local schools and Frimley Green village. Camberley town centre is also only a short distance away. The property is presented in truly stunning order throughout and accommodation comprises three bedrooms, living room and a beautiful and bright, open plan kitchen/breakfast/family room with roof lantern and door to rear garden. There is an en-suite shower room to bedroom one and a family bathroom. Further benefits include a downstairs cloakroom, double glazing, gas central heating. The garden is landscaped and mainly laid to lawn with a large patio which wraps around to the side of the house. To the front of the house there is a block paved driveway offering off street parking for two cars. Viewings are highly recommended.

Jigsaw 
Estates Limited

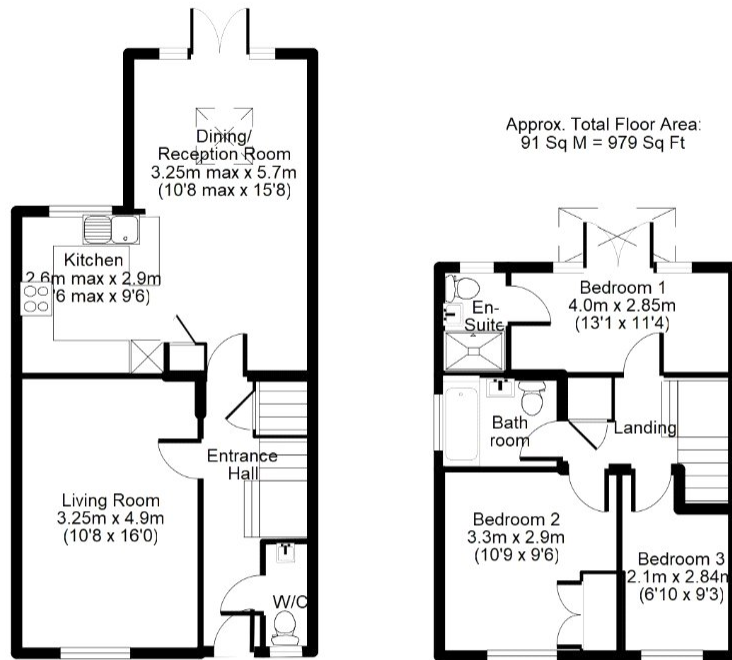

Floorplan is for illustration purposes only.
All measurements are approximate and should be verified.

- SEMI DETACHED
- THREE BEDROOMS
- BEAUTIFUL GARDEN
- CALA HOME
- DRIVEWAY
- LANDSCAPED GARDEN
- LIVING ROOM
- OPEN PLANNED KITCHEN/FAMILY ROOM
- UPDATED FURTHER BY CURRENT OWNERS
- EN-SUITE SHOWER ROOM
- FAMILY BATHROOM
- CLOAKROOM

Energy Efficiency Rating

	Current	Potential
Very energy efficient - lower running costs		
(92 to 100) A		96
(81 to 91) B	86	
(69 to 80) C		
(55 to 68) D		
(39 to 54) E		
(21 to 38) F		
(1 to 20) G		
Not energy efficient - higher running costs		
England, Wales & N.Ireland		EU Directive 2002/91/EC

