



Thornhill, Purleigh, Maldon, CM3 6PQ

Council Tax Band E (Maldon District Council)

 1  4  1

£650,000 Freehold

This delightful three/four bedroomed detached bungalow is nestled in a tranquil cul-de-sac within this highly sought-after village.

Accommodation

Step through the covered entrance into a welcoming glazed porch and entrance hall, complete with built-in double storage cupboards. The spacious lounge/diner is positioned at the rear of the bungalow and takes advantage of picturesque views of the beautifully maintained rear garden. The fitted kitchen is well equipped with integrated appliances and provides access to a walled courtyard providing an additional outside seating area before opening into the main garden. The bungalow features three double bedrooms, each with fitted wardrobes for ample storage. The fourth bedroom provides versatility and could be utilised as a study, snug or a separate dining room. The main bathroom includes both a bath and separate shower and is complemented by an additional cloakroom for added convenience. The bungalow also offers oil central heating, double glazing and to minimise external maintenance there are UPVC soffits and fascias.

Outside

Set on a generous 0.17-acre plot, the well maintained rear garden measures approximately 60' x 50' (18.29m x 15.24m) and enjoys an easterly aspect and a high degree of privacy. It includes timber sheds and a charming summer house, perfect for outdoor relaxation. A private paved terrace to the side of the bungalow offers a tranquil retreat, while the front provides off-road parking for several cars and an oversized garage with an electric up-and-over door.

Location

Purleigh is a semi-rural village approximately 4 miles south of Maldon and 4 miles east of Danbury. The village offers a range of amenities, including a village shop, a highly regarded primary school, a very popular public house, and a parish church. For commuters, the property is conveniently close to South Woodham Ferrers and North Fambridge railway stations, providing links to London Liverpool Street. The area boasts a choice of schools in both the public and private sectors, including Maldon Court Prep School, Heathcote, Elm Green in Danbury, and New Hall at Boreham. The nearby town of Maldon features a historic quay and High Street with a mix of local and national stores, quaint tea rooms, historic pubs, and a variety of restaurants and bars.

Utilities - Mains Electricity, Water and Drainage.

- Well presented four bedroom detached bungalow
- Fitted kitchen with built in electric oven and hob
- Bathroom/wc with separate cloakroom
- Upvc soffits, fascias and guttering
- Off road parking for 3/4 cars
- 25ft lounge/diner
- Bedroom four/study
- Oil fired central heating & double glazing
- Garage 22' x 13'8 with electric up and over door
- 60' x 50' (18.29m x 15.24m) east facing rear garden









bond
Residential

GROUND FLOOR
1476 sq.ft. (137.1 sq.m.) approx.

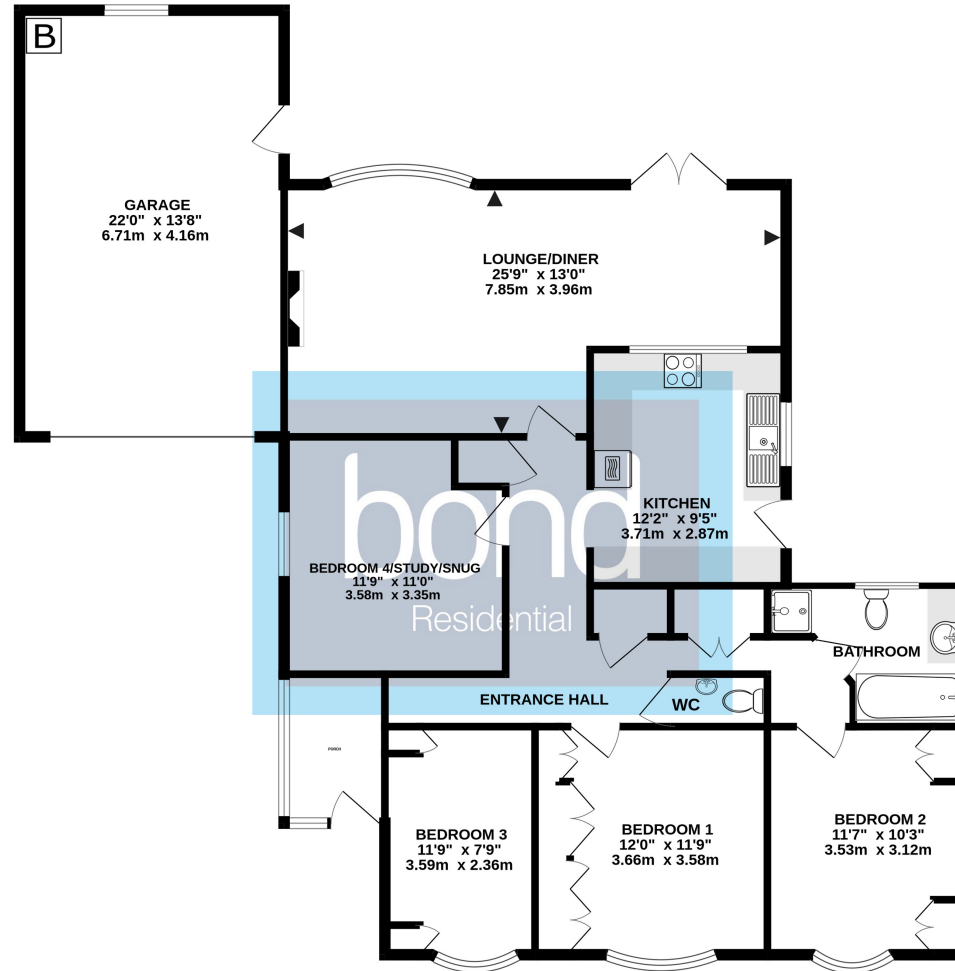

TOTAL FLOOR AREA : 1476 sq.ft. (137.1 sq.m.) approx.

Whilst every attempt has been made to ensure the accuracy of the floorplan contained here, measurements of doors, windows, rooms and any other items are approximate and no responsibility is taken for any error, omission or mis-statement. This plan is for illustrative purposes only and should be used as such by any prospective purchaser. The services, systems and appliances shown have not been tested and no guarantee as to their operability or efficiency can be given.
Made with Metropix ©2024

10, Maldon Road,
Danbury, Essex, CM3 4QQ
Telephone: 01245 222856
Website: www.bondresidential.co.uk

Consumer Protection from Unfair Trading Regulations 2008 and the Business Protection from Misleading Marketing Regulations 2008. Bond Residential have made every effort to ensure that consumers and/or businesses are treated fairly and provided with accurate material information as required by law. We have not tested any apparatus, equipment, fixture, fitting or any services and as such are unable to verify they are in working order, fit for their purpose, or within the ownership of the seller or landlord. Neither have we been able to check the legal documentation to verify the legal status of the property. We therefore advise potential buyers or tenants to verify these matters with their own solicitors or other advisers.

