

Day & Co  
ESTATE AGENTS

28 Cavendish Street  
Keighley  
BD21 3RG



61 Cross Roads, Keighley, West  
Yorkshire, BD22 9BG

£94,995

T: 01535 664609

W: [www.dayandcoestateagents.co.uk](http://www.dayandcoestateagents.co.uk)

E: [keighley@dayandcoestateagents.co.uk](mailto:keighley@dayandcoestateagents.co.uk)

- EPC Rating Is E
- 2 Bedrooms
- Spacious Accommodation Over 3 Floors

- Stone Built End Of Terrace
- Spacious Dining Kitchen
- Views Across Worth Valley

## SUMMARY

\*\*A 2 BEDROOM STONE BUILT THROUGH TERRACE WITH ACCOMMODATION OVER 3 FLOORS IN CONVENIENT LOCATION CLOSE TO LOCAL AMENITIES, POPULAR PRIMARY SCHOOL AND GOOD PUBLIC TRANSPORT LINKS TO KEIGHLEY, BRADFORD AND FURTHER AFIELD. BENEFITS DOUBLE GLAZING AND CENTRAL HEATING AND BRIEFLY COMPRISES; LOUNGE; BASEMENT DINING KITCHEN; WC; 2 BEDROOMS AND BATHROOM. DECEPTIVELY SPACIOUS WORTHY OF INTERNAL VIEWING AND WOULD PROVE IDEAL AS A FIRST HOME OR BUY TO LET OPTION\*\* EPC rating E.

## FULL DESCRIPTION

An ideal purchase for the first time buyer is this deceptively spacious two bedroom end of terrace, situated in the ever popular village location of Cross Roads with excellent access to the local primary school village amenities, and bus routes into Keighley town centre. The property offers accommodation over three floors and briefly comprises of an entrance hall, the lounge has double glazed windows to the front and side, and offers access to a cloaks WC. To the lower ground floor there is a spacious dining kitchen having a range of modern base and wall mounted units, plumbing for an automatic washing machine, tiled flooring, double glazed window to the front. To the first floor there are two bedrooms, the master having fitted mirror fronted wardrobes. The bathroom has a modern three piece suite in white comprising of bath with shower over, WC, wash hand basin, chrome heated towel rail, double glazed window to the rear. Viewing recommended to fully appreciate, EPC rating is E.

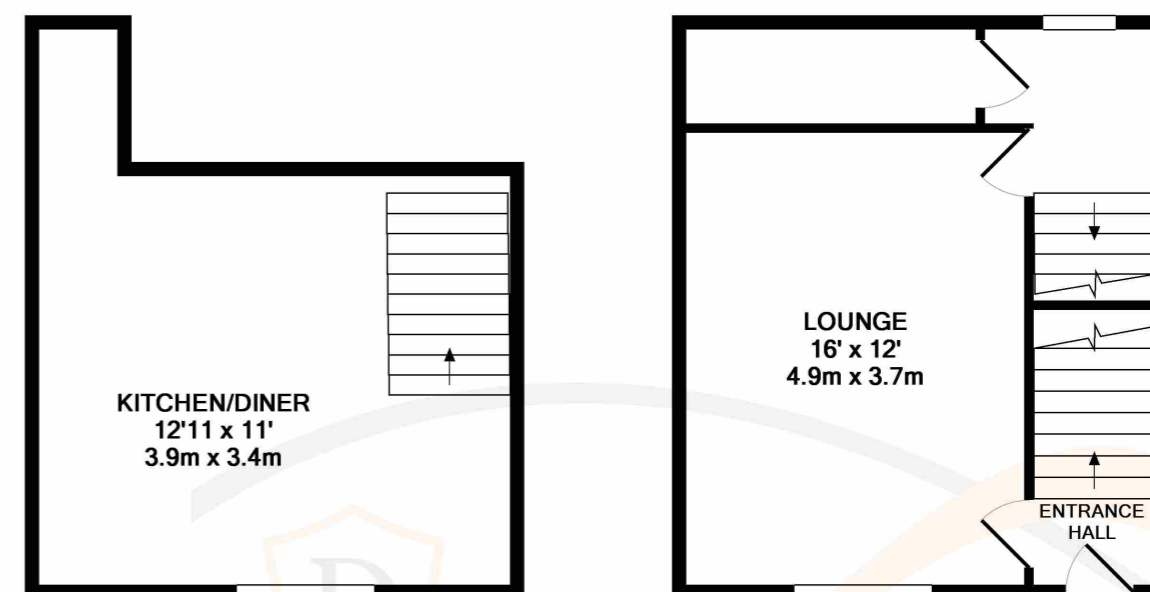

LOWER GROUND FLOOR

GROUND FLOOR

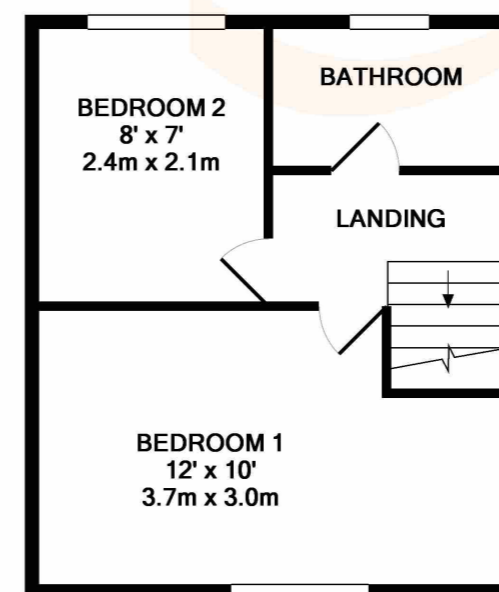

1ST FLOOR

Day & Co

Whilst every attempt has been made to ensure the accuracy of the floor plan contained here, measurements of doors, windows, rooms and any other items are approximate and no responsibility is taken for any error, omission, or mis-statement. This plan is for illustrative purposes only and should be used as such by any prospective purchaser. The services, systems and appliances shown have not been tested and no guarantee as to their operability or efficiency can be given  
Made with Metropix ©2019