



## 24 Easthouses Way, Easthouses, Dalkeith, Midlothian, EH22 4UA

Light & Well Presented, One Bedroom Maisonette

Up to date price and viewing info at [mov8realestate.com/property](https://www.mov8realestate.com/property)



# Property Description

Light and well-presented, one-bedroom maisonette, forming part of a modern and established residential development.

Situated in a quiet and leafy residential cul-de-sac, in the popular area of Easthouses near Dalkeith, Midlothian.

Comprises an entrance hall and stairway, living room, kitchen, double bedroom and a bathroom.

Prepared for the market with light neutral decor throughout, features include a fitted kitchen with appliances, a bright modern bathroom and gas central heating.

In addition, there is an allocated parking space, TV and phone points, single glazing, and good storage provision including a loft. All furnishings are available for inclusion in the sale.

A generous entrance hall has a built-in storage cupboard, further under stair storage space, the carpeted stairway and gives access to the bathroom which is fitted with a modern suite, including a shower unit over the bath and tiled splash walls.

Upstairs, a dual-aspect living room gives access to both the kitchen and bedroom, and features carpeted flooring and a central light fitting.

With a leafy view to the rear, the kitchen includes fitted worktops and units, a sink with drainer, a washing machine, a fridge/freezer, and an integrated oven and gas hob.

Completing the accommodation, the bedroom features a wall-mounted bed light, a central pendant ceiling light and carpeted flooring.

A 360 Virtual Tour is available online.



**24 Easthouses Way, Easthouses, Dalkeith, EH22 4UA**

Approximate Gross Internal Area: (441 sq ft - 41 sq m.)

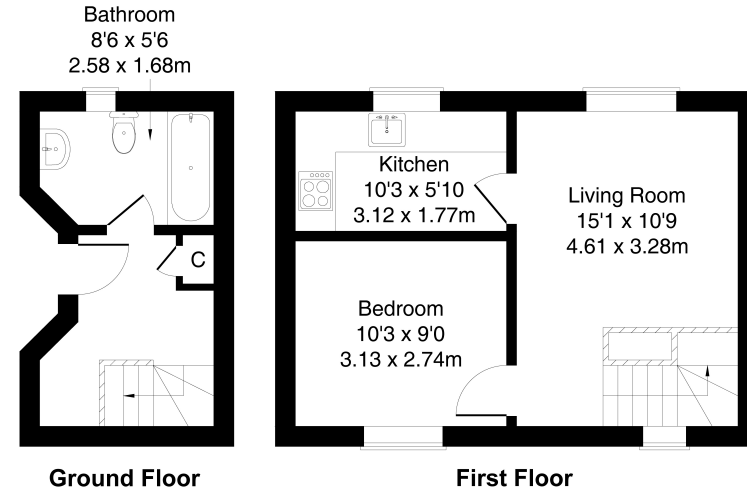

Legal Disclaimer : Floor-plan and measurements are for illustrative guidance only, and not intended to form part of any contract.

# Area Description

Easthouses is a residential town, set just to the south of Dalkeith, and some eight miles from Edinburgh city centre. With good amenities on offer locally, as well as excellent commuting links and local schooling, nearby Dalkeith offers further amenities including local shopping, supermarkets, cafes and restaurants. The surrounding areas offer some of Edinburgh's largest retail parks, including

Straiton, which provides a Sainsbury's supermarket, Boots, an M&S food store and other high-street names along with one of Scotland's IKEA stores. There is good local schooling available from primary to secondary level, and recreational facilities include several golf courses, Hillend Ski Slope and the famous Rosslyn Chapel and Rosslyn Glen County Park.





## Our Services

- Free pre-sale property valuations
- Great value fixed estate agency fees
- Extensive buyer matching database
- Purchase and sale conveyancing

## Contact Us

0345 646 0208

[sales@mov8realestate.com](mailto:sales@mov8realestate.com)

[www.mov8.com](http://www.mov8.com)

### Head Office

6 Redheughs Rigg, Edinburgh, EH12 9DQ

### Glasgow Office

77 Renfrew Street, Glasgow, G2 3BZ



Estate Agents and Solicitors

