







**15 Chessholme Road, Ashford, Surrey TW15 1LG**  
**£610,000 - Freehold**





## PROPERTY DESCRIPTION

Price reduced to sell. Situated in this sought after cul-de-sac is this well presented three bedroom detached family home. The property offers spacious and well planned accommodation comprising of two large reception rooms and a good size kitchen/breakfast room, down stairs shower room and WC. On the first floor are three good size bedrooms and a family bathroom. Outside there is own driveway to garage and parking for several cars and an attractive and well maintained rear garden with patio. The property also offers space and potential for extension subject to the usual planning permission. Local shops and schools are within easy walking distance and Ashford town centre is a few minutes away. The house also benefits from gas fired central heating and replacement double windows throughout.

## POINTS OF INTEREST

- DETACHED FAMILY HOME
- THREE BEDROOMS
- CUL-DE-SAC LOCATION
- THREE LARGE BEDROOMS
- PRIVATE DRIVEWAY
- GARAGE
- POTENTIAL TO EXTEND (S.T.P.P.)
- TWO BATHROOMS





GROUND FLOOR  
931 sq.ft. (86.5 sq.m.) approx.

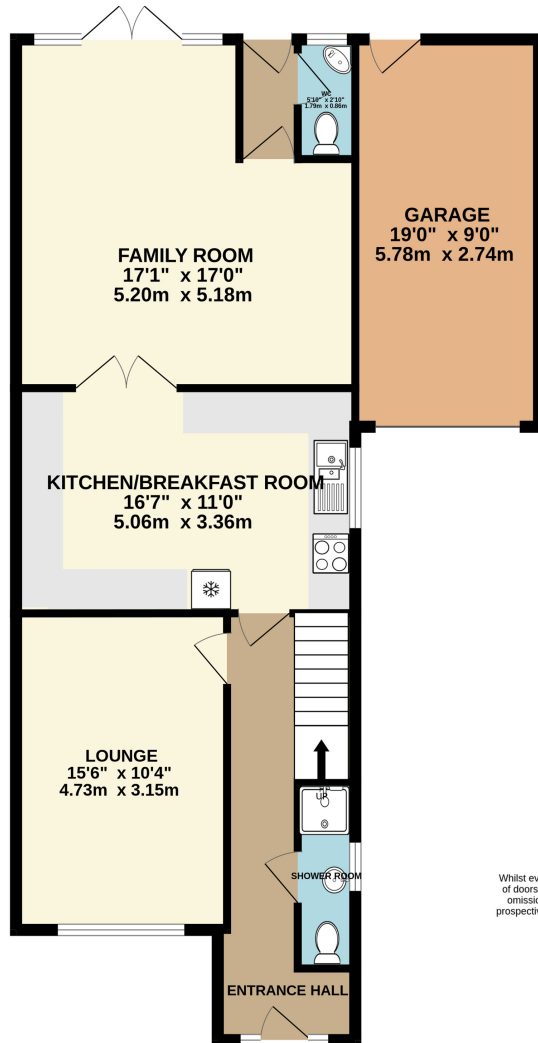

1ST FLOOR  
477 sq.ft. (44.3 sq.m.) approx.

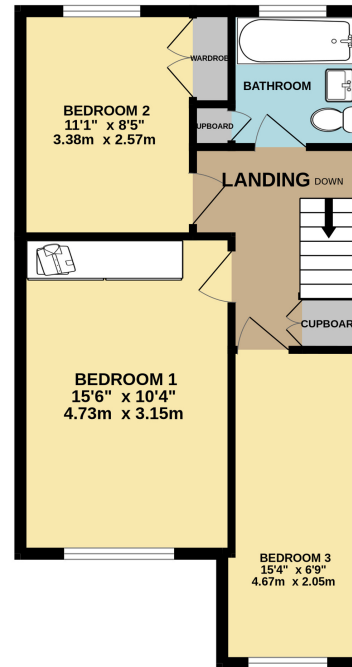

TOTAL FLOOR AREA : 1408 sq.ft. (130.8 sq.m.) approx.

Whilst every attempt has been made to ensure the accuracy of the floorplan contained here, measurements of doors, windows, rooms and any other items are approximate and no responsibility is taken for any error, omission or mis-statement. This plan is for illustrative purposes only and should be used as such by any prospective purchaser. The services, systems and appliances shown have not been tested and no guarantee as to their operability or efficiency can be given.

Made with Metropix ©2024