

# Truuli



## Hardcastle Close, Croydon, Surrey, CR0 6XQ

£260,000 Leasehold

- Chain free
- allocated parking space
- Close proximity to Blackhorse Lane Tram and Norwood Junction
- Overground Station
- Walk-in wardrobe
- Residential close
- Over 550sqft of living space

Southbridge Place, Surrey, CR0 4HA

Tel: 0330 043 0002

Email: [save@truuli.co.uk](mailto:save@truuli.co.uk) Web: [www.truuli.co.uk](http://www.truuli.co.uk)

# Hardcastle Close, Croydon, Surrey, CR0 6XQ

£260,000 Leasehold

Set within a peaceful close, this spacious two-bedroom apartment is available to view immediately.

Second Floor  
555 sq.ft. (51.5 sq.m.) approx.

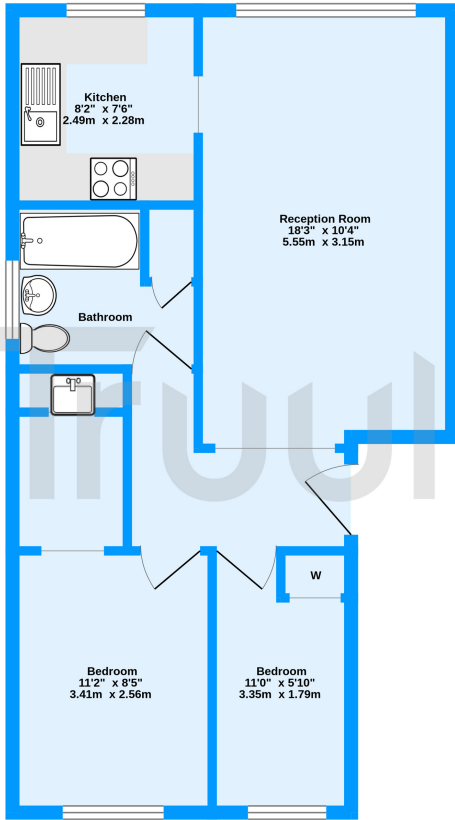

Hardcastle Close, Croydon, CR0

TOTAL FLOOR AREA: 555 sq.ft. (51.5 sq.m.) approx.  
Measurements are approximate. Not to scale. Illustrative purposes only.  
Made with Metropex ©2024.

Energy Efficiency Rating		Current	Potential
Very energy efficient - lower running costs			
(92+)	<b>A</b>		
(81-91)	<b>B</b>		
(69-80)	<b>C</b>	78	81
(55-68)	<b>D</b>		
(39-54)	<b>E</b>		
(21-38)	<b>F</b>		
(1-20)	<b>G</b>		
Not energy efficient - higher running costs			
England, Scotland & Wales		EU Directive 2002/91/EC	

