



Passingham Avenue

Hitchin | Hertfordshire | SG4 9LD

www.stonegate-estates.co.uk



PASSINGHAM AVENUE

Property Description

We are delighted to offer this 3 bed family home set within the popular SG4 9 postcode area of South Hitchin.

Set in a quiet residential area, the property offers good sized living accommodation with a rear extension leading to the pleasant rear garden.

The ground floor offers a spacious lounge diner with a feature fire place, a fully fitted kitchen with ample storage and the added benefit of a ground floor cloakroom, perfect for a family.

Upstairs are two double bedrooms and a single bedroom, all with storage. The recently refurbished bathroom has a large walk in shower and modern white suite, again with plenty of storage.

The location offers easy access to the town centre and train station along with being in an excellent school catchment area.

Viewing is highly recommended and should be booked via the sole selling agents.



£625,000 Freehold

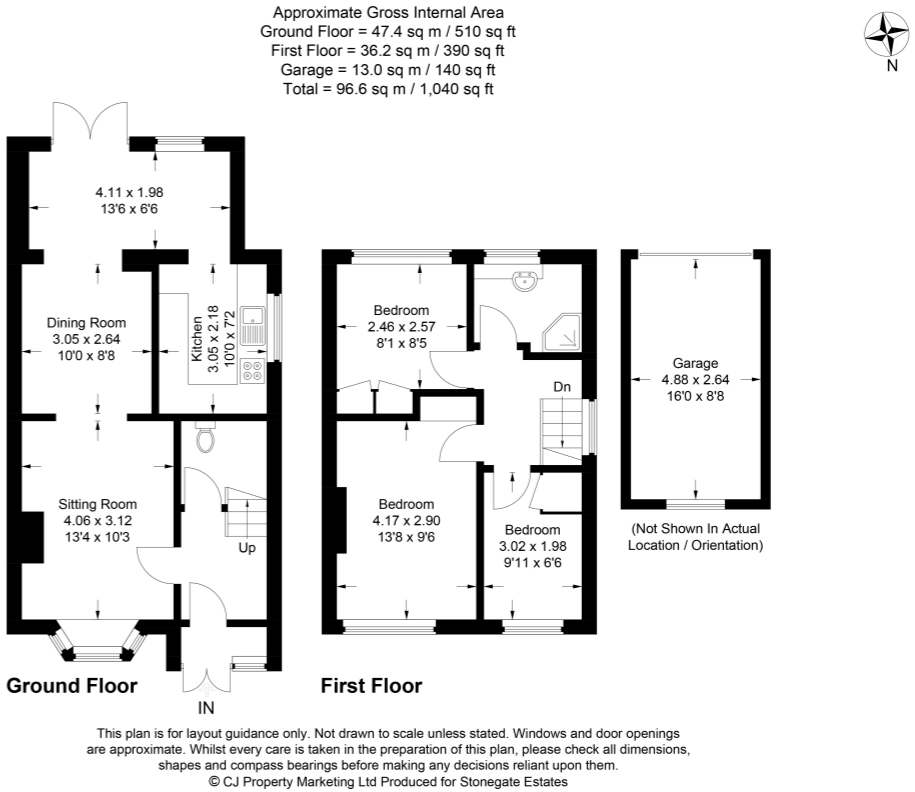



- Three Bedroom Semi Detached
- SG4 9 Postcode Location
- Extended to Rear
- No Chain
- Garage & Off Road Parking
- Delightful Gardens
- Walking Distance To Town Centre
- Good School Catchment

EPC Rating: D

Stonegate Estate Agents

01462 438979

sales@stonegate-estates.co.uk | www.stonegate-estates.co.uk

