







- Large Traditional Semi-Detached Home
- Extremely Large Garden
- Garden Backs Onto A Small Stream
- Two Reception Rooms
- Kitchen Dining Room
- Three Double Bedrooms
- Two Parking Spaces

### Description

A large, traditional Semi-Detached Home, that has an extremely long back garden, several outbuilding, a hot-tub, a treehouse and the garden backs onto Wincham Brook. The rear of the house is a true haven and has to be seen to be believed. The house itself has gas central heating and double glazed windows and comprises: Entrance hall, two reception rooms, a large kitchen dining room, downstairs WC, first floor landing, three double bedrooms and a large bathroom. The loft space has been converted with a staircase off the landing area. To the front of the house there is parking for two vehicles.





**Location**

There are several shops nearby, catering from most everyday needs along with a highly regarded local primary school. There are two nearby High Schools, the highly regarded County High School Leftwich and Rudheath Senior Academy. Local transport facilities could not be better served with the A556 immediately available with connections to the M6 Motorway, only six miles away. The Northern Line railway with trains from Chester to Manchester is accessible from either Northwich or nearby Lostock Gralam and The Mainline West Coast Railway is available from Hartford. Northwich caters for a more comprehensive range of amenities, including leading supermarkets with Waitrose, Sainsbury's and Tesco all represented.

**Tenure**

FREEHOLD

**EPC Rating:**





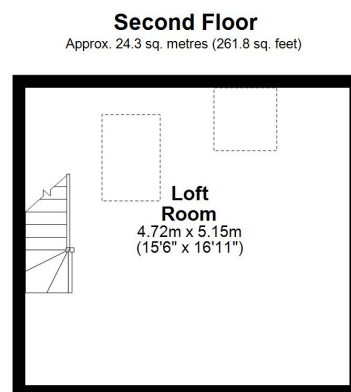
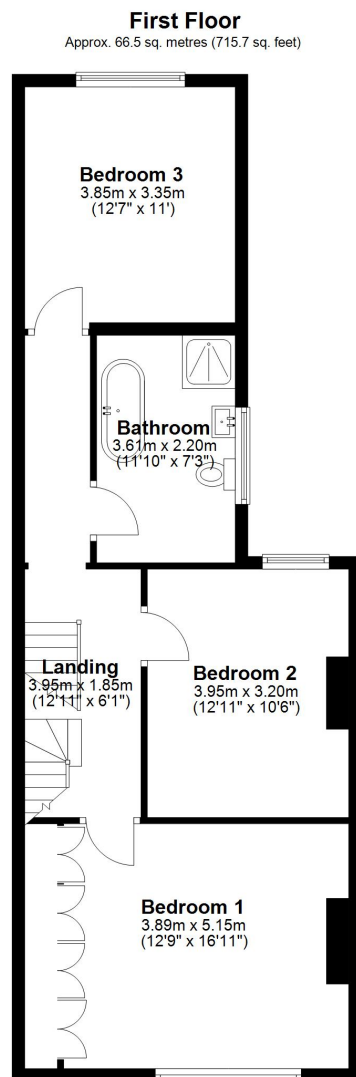
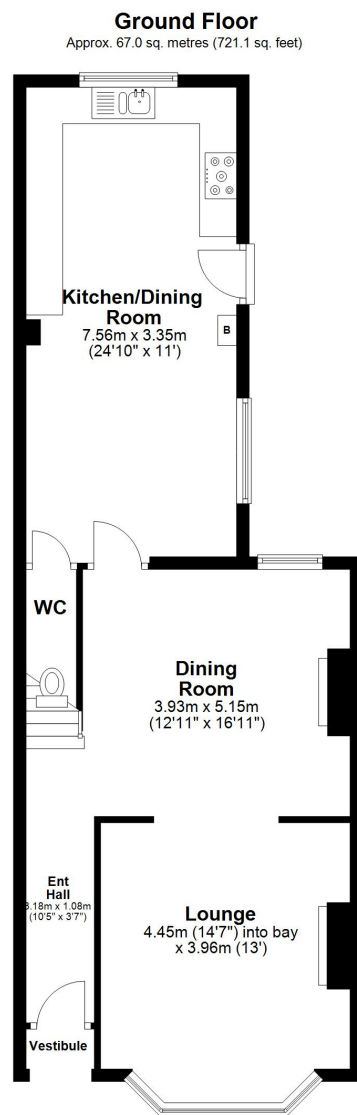

Total area: approx. 157.8 sq. metres (1698.6 sq. feet)

Williams Estates is the trading name of Williams Estates (Ltd). Registered address 33, The Green, Hartford, Northwich, Cheshire, CW8 1QA.

Reg number 07682683. Director Andrew P Williams



These particulars, whilst believed to be accurate are set out as a general outline only for guidance and do not constitute any part of an offer or contract. Intending purchasers should not rely on them as statements of representation of fact, but must satisfy themselves by inspection or otherwise as to their accuracy. All measurements quoted are approximate. We are unable to confirm the working order of any fixtures and fittings including appliances that are included in these particulars. No person in this firm's employment has the authority to make or give any representation or warranty in respect of the property.