



**£995,000 Freehold**

## Harrow Court

3 Harrow Court, Stockbury, SITTINGBOURNE, Kent ME9 7UQ



Energy Efficiency Rating		Current	Potential
Very energy efficient - lower running costs			
(92-100)	<b>A</b>		
(81-91)	<b>B</b>		
(69-80)	<b>C</b>		74
(55-68)	<b>D</b>		
(39-54)	<b>E</b>	43	
(21-38)	<b>F</b>		
(1-20)	<b>G</b>		
Not energy efficient - higher running costs			
England, Scotland & Wales		EU Directive 2002/91/EC	



## Harrow Court

- PRESTIGIOUS, INDIVIDUAL, FAMILY HOME
- PLANNING FOR BUNGALOW IN GROUNDS
- 5 BEDROOMS
- 5 RECEPTION ROOMS
- UNLIMITED POTENTIAL
- ENVIABLE VILLAGE LOCATION
- PRICE HAS BEEN REDUCED TO ENABLE OPURCHASER TO COMPLETE WORKS AND DRIVEWAY.

<https://www.facebook.com/BuckeyandWard>
<https://twitter.com/buckeyandward>  
 23 West Street, Sittingbourne, Kent, ME10 1AJ  
 T: 01795 472828 F: 01795 425014 www.buckeyandward.co.uk  
 sales@buckeyandward.co.uk lettings@buckeyandward.co.uk



IMPRESSIVE COUNTRY PROPERTY SET WITHIN THE MAIDSTONE NORTH DOWNS!  
 OUTSTANDING COUNTRYSIDE VIEW!!! HUGE LIVING ACCOMMODATION!!! ENDLESS AMOUNTS OF POTENTIAL!!!

The current vendor has planning permission granted in 2002 for an ancillary residential accommodation (Planning number MA/01/1803). The base of the build already being laid by the current vendor. The vendor has had further drawings for this to be made into a larger detached bungalow but no planning permission has yet been sought.

Opportunities such as this one do not come around often particularly when they are offered with NO CHAIN! This substantial and very imposing FIVE bedroom detached home located in the beautiful Maidstone countryside is a real rarity to the market. Nestled out of the way in a quiet cul-de-sac within the highly sought after village of Stockbury.

The property itself sits within the centre of its generously sized wrap around plot which consists of



## Floor Plans

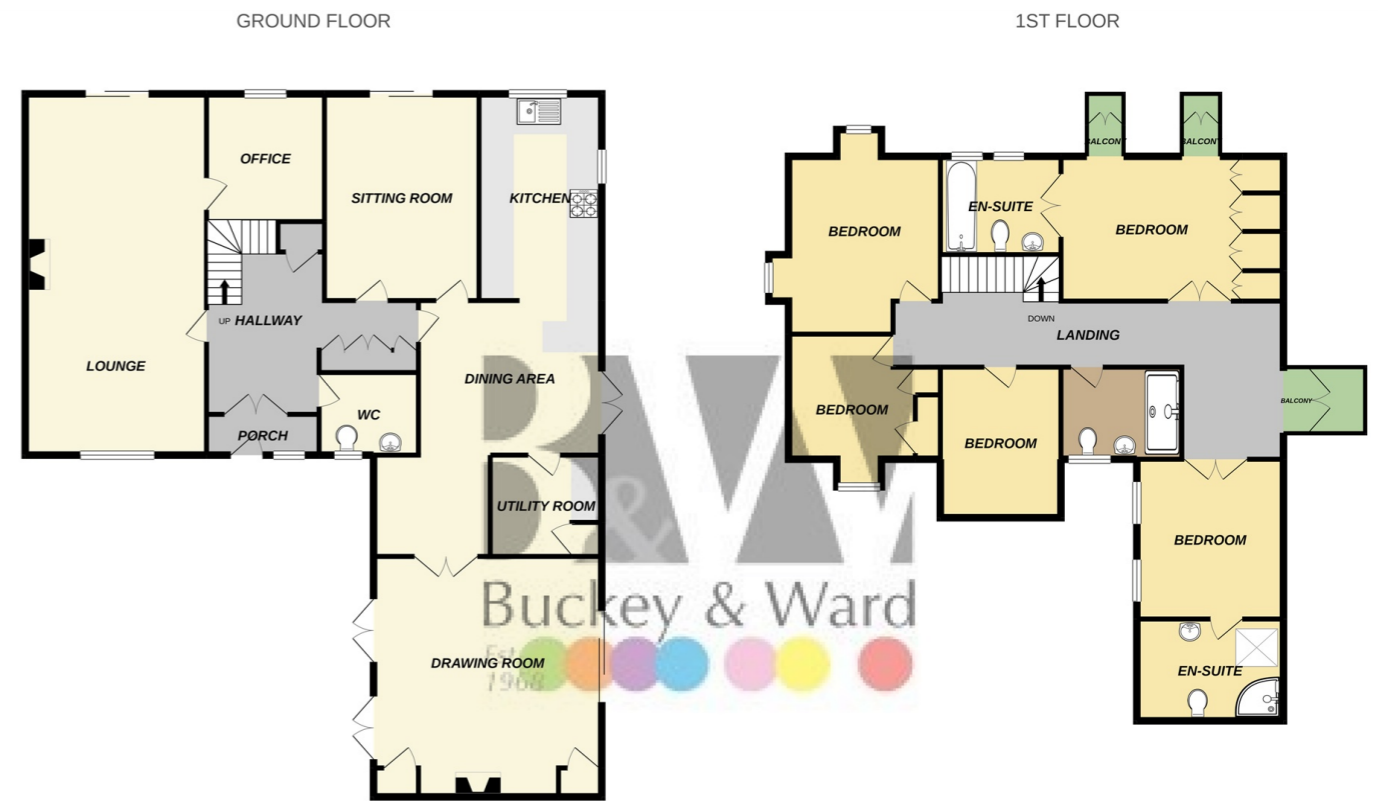

Whilst every attempt has been made to ensure the accuracy of the floorplan contained here, measurements of doors, windows, rooms and any other items are approximate and no responsibility is taken for any error, omission or mis-statement. This plan is for illustrative purposes only and should be used as such by any prospective purchaser. The services, systems and appliances shown have not been tested and no guarantee as to their operability or efficiency can be given.  
 Made with Metropix ©2021