



**FOR SALE**



## Kingfisher Way, London NW10

OVER 900 YEARS LEASE!!!!

CALLING ALL FIRST TIME BUYER AND INVESTORS!!!!!!

Well presented, two bed 1ST floor flat with allocated parking space.

Ideally located on a quiet residential cul-de-sac but still centrally located, providing easy access to the North Circular (leading to the M1 & A40), Neasden, Stonebridge Park, Brent Cross, Wembley Stadium & Wembley Outlet to name but a few.

The property itself is well presented throughout and comprises of spacious living room, fitted kitchen, two good sized bedrooms and a family bathroom.

Added benefit of no upper chain!

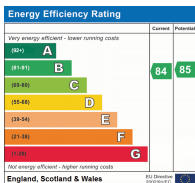

## Offers In Excess Of £300,000 Leasehold

4 North Parade, Mollison Way, Edgware, HA8 5QH  
E: info@mischaandco.com T: 0208 951 5000

# Floorplan

## GROUND FLOOR

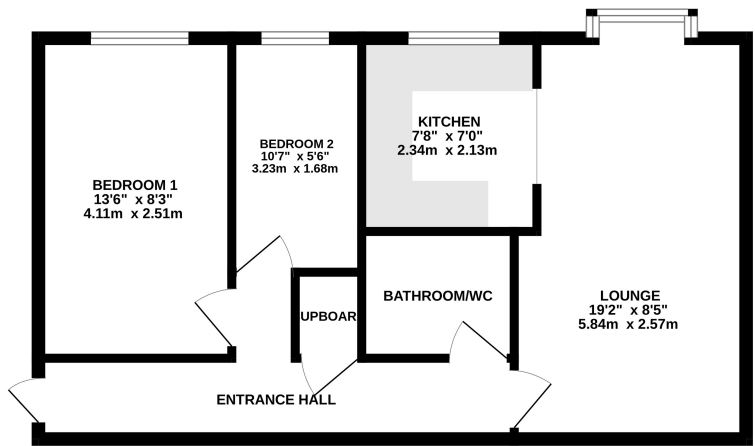

KINGFISHER WAY NW10

TOTAL FLOOR AREA - 546sq ft (50.7 sq.m.) approx.

Whilst every attempt has been made to ensure the accuracy of the floorplan contained here, measurements of doors, windows, rooms and any other items are approximate and no responsibility is taken for any error, omission or mis-statement. This plan is for illustrative purposes only and should be used as such by any prospective purchaser. The services, systems and appliances shown have not been tested and no guarantee as to their operability or efficiency can be given.

Made with Metropix ©2025

NB: Please note that all fittings, kitchen appliances and heating systems have not been tested by Mishca & Co Sales & Lettings. Whilst we endeavour to make our sales details accurate and reliable. Room sizes should not be relied upon for carpets and furnishings. If there is any point, which is of particular important to you, please contact our office and we will be pleased to verify any information for you. Do so particularly if contemplating travelling some distance to view this property.

