



Day & Co
ESTATE AGENTS

28 Cavendish Street

Keighley

BD21 3RG



1 Ruby Street, Keighley, West
Yorkshire, BD22 7BL

£57,500

T: 01535 664609

W: www.dayandcoestateagents.co.uk

E: keighley@dayandcoestateagents.co.uk

- EPC Rating Is E
- Two Bedrooms
- Popular & Convenient Residential Location

- Stone Built End Terrace
- Accommodation 3 Floors
- NO CHAIN

SUMMARY

A 2 BEDROOM STONE BUILT END TERRACE, POPULAR & CONVENIENT RESIDENTIAL LOCATION WITH EXCELLENT ACCESS TO LOCAL SCHOOLS & KEIGHLEY TOWN CENTRE!! Having accommodation over 3 floors, recently installed gas central heating system - OFFERED FOR SALE WITH NO ONWARD CHAIN!! EPC rating is E.

FULL DESCRIPTION

Of interest to a variety of buyers is this stone built 2 bedroom end of terrace, situated in the popular and convenient location of Ingrow with excellent access to local schools and amenities. The three storey property comprises of an entrance leading into the spacious lounge having double glazed window to the front and a radiator. The kitchen has base and wall mounted units, double glazed window to the side. To the first floor there is a double bedroom, and the bathroom having a bath, wash hand basin, WC, double glazed window to the front. To the second floor is a further double bedroom. Offered for sale with no onward chain, EPC rating is E.

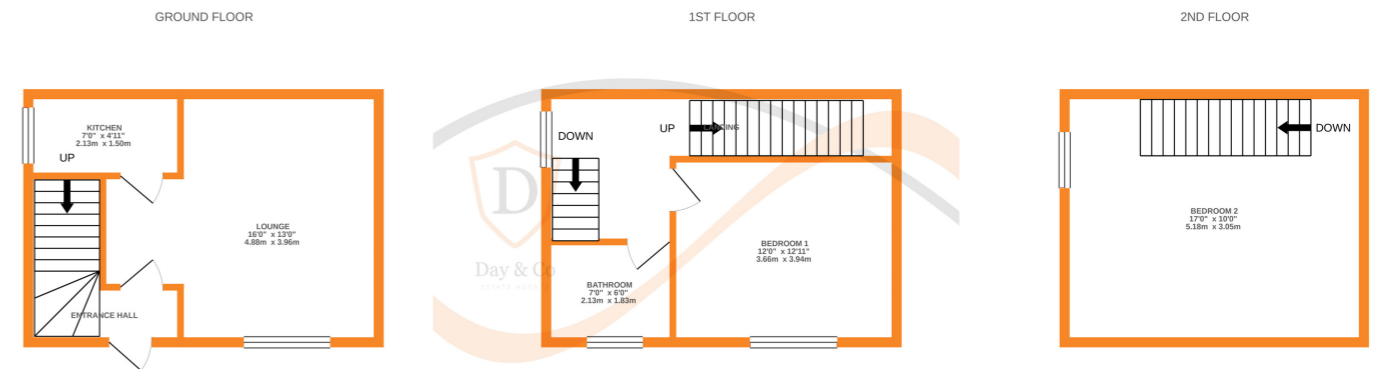

Whilst every attempt has been made to ensure the accuracy of the floorplan contained here, measurements of doors, windows, rooms and any other items are approximate and no responsibility is taken for any error, omission or mis-statement. This plan is for illustrative purposes only and should be used as such by any prospective purchaser. The services, systems and appliances shown have not been tested and no guarantee as to their operability or efficiency can be given.
Made with Metropix ©2021