

## Peregrine Drive, Stowmarket

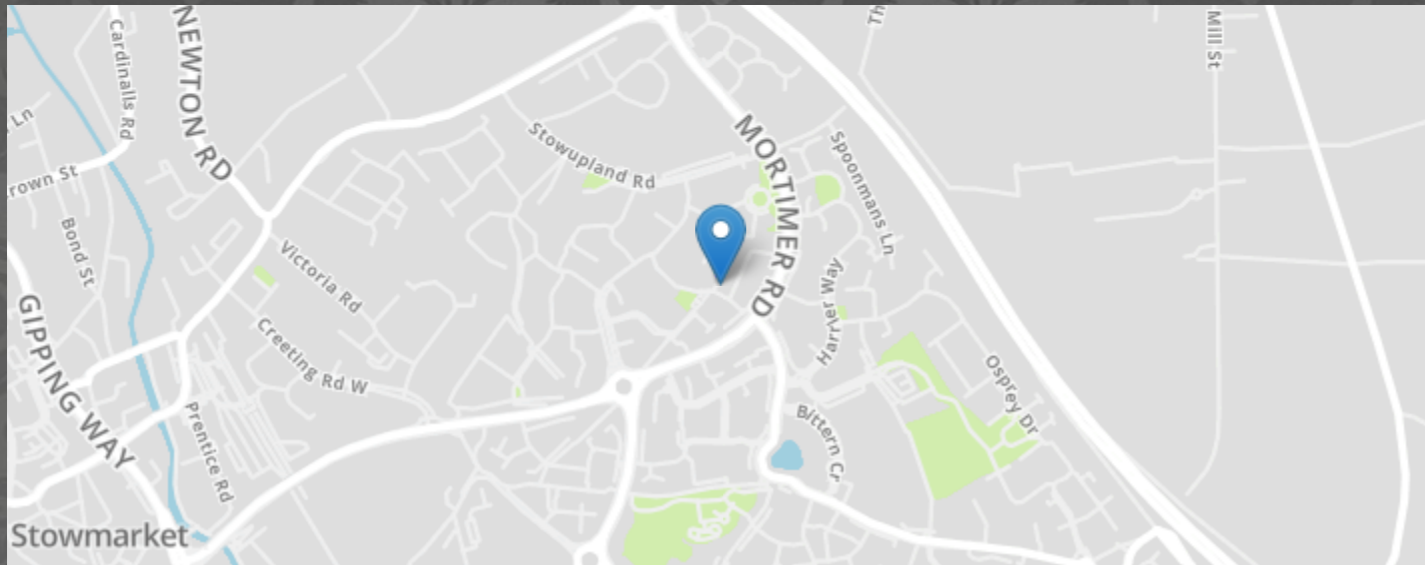

- FIVE BED DETACHED PROPERTY
- THREE EN-SUITE SHOWER ROOMS
- CLOSE TO LOCAL AMENITIES, BUS ROUTES & TRAIN STATION
- GROUND FLOOR W/C
- WRAP AROUND GARDEN
- AMPLE DRIVEWAY PROVIDING OFF ROAD PARKING
- EASY ACCESS TO A12 & A14
- SEPARATE KITCHEN, DINING ROOM & LOUNGE

# MARKS & MANN

8 Needham Rd, Stowmarket, Suffolk, IP14 2AW.

01449 867 590

contactstowmarket@marksandmann.co.uk

Website [www.marksandmann.co.uk](http://www.marksandmann.co.uk)

# MARKS & MANN



## Peregrine Drive, Stowmarket

Offered for sale is this DETACHED, FIVE BEDROOM, FOUR BATHROOM house with a SINGLE GARAGE on a CORNER PLOT, ample off road parking and a landscaped wrap around garden. The home comprises of a modern kitchen, separate dining room and lounge, four double bedrooms, three with en-suite shower rooms, a single bedroom and a modern four piece family bathroom.

**£425,000 Offers in Excess of**

# Peregrine Drive, Stowmarket

## GROUND FLOOR

### Hallway

Skimmed ceiling, overhead lighting, carpeted stairs leading to first floor, front aspect UPVC double glazed window, coat cupboard and wood effect flooring.

### W/C

Skimmed ceiling, overhead lighting, extraction fan, radiator and wood effect flooring.

### Lounge

5.55m x 3.09m (18' 3" x 10' 2")  
Skimmed ceiling, overhead lighting, front aspect UPVC double glazed window, two radiators and carpeted flooring.

### Sitting Room

3.23m x 2.54m (10' 7" x 8' 4")  
Skimmed ceiling, overhead lighting, rear aspect UPVC double glazed French doors, radiator and carpeted flooring.

### Kitchen

5.78m x 3.40m (19' 0" x 11' 2")  
Skimmed ceiling, spotlighting, rear aspect UPVC double glazed window, under-stair storage cupboard, two radiators and wood effect flooring. Kitchen consists of a range of base and eye level units with integrated sink-drainer, dishwasher, washing machine, fridge freezer, five point gas hob, double electric oven and an extraction unit.

## FIRST FLOOR

### Landing

Skimmed ceiling, overhead lighting, airing cupboard, radiator and carpeted flooring.

### Bedroom One

4.86m x 3.32m (15' 11" x 10' 11")  
Skimmed ceiling, overhead lighting, front and side aspect UPVC double glazed windows, built in wardrobe, two radiators and carpeted flooring.

### En-Suite

Three piece en-suite shower room with skimmed ceiling, spotlighting, front aspect UPVC double glazed obscured window, radiator and wood effect flooring.

### Bedroom Three

3.24m x 2.79m (10' 8" x 9' 2")  
Skimmed ceiling, overhead lighting, rear aspect UPVC double glazed window, built in wardrobe, radiator and carpeted flooring.

### En-Suite

Three piece en-suite shower room with skimmed ceiling, overhead lighting, side aspect UPVC double glazed obscured window, radiator and wood effect flooring.

### Bedroom Five

3.32m x 2.53m (10' 11" x 8' 4")  
Skimmed ceiling, overhead lighting, rear aspect UPVC double glazed window, radiator, built in wardrobe and carpeted flooring.

### Bathroom

3.79m x 1.77m (12' 5" x 5' 10")  
Four piece family bathroom with a skimmed ceiling, overhead lighting, front aspect UPVC double glazed obscured window, radiator and wood effect flooring.

## SECOND FLOOR

### Landing

Skimmed ceiling, overhead lighting, rear aspect skylight and carpeted flooring.

### Bedroom Two

5.72m x 3.31m (18' 9" x 10' 10")  
Skimmed ceiling, overhead lighting, front aspect UPVC double glazed window, two radiators, built in wardrobe and carpeted flooring.

### En-Suite

Three piece en-suite shower room with skimmed ceiling, overhead lighting, rear aspect skylight, under-sink storage, radiator and wood effect flooring.

# Peregrine Drive, Stowmarket

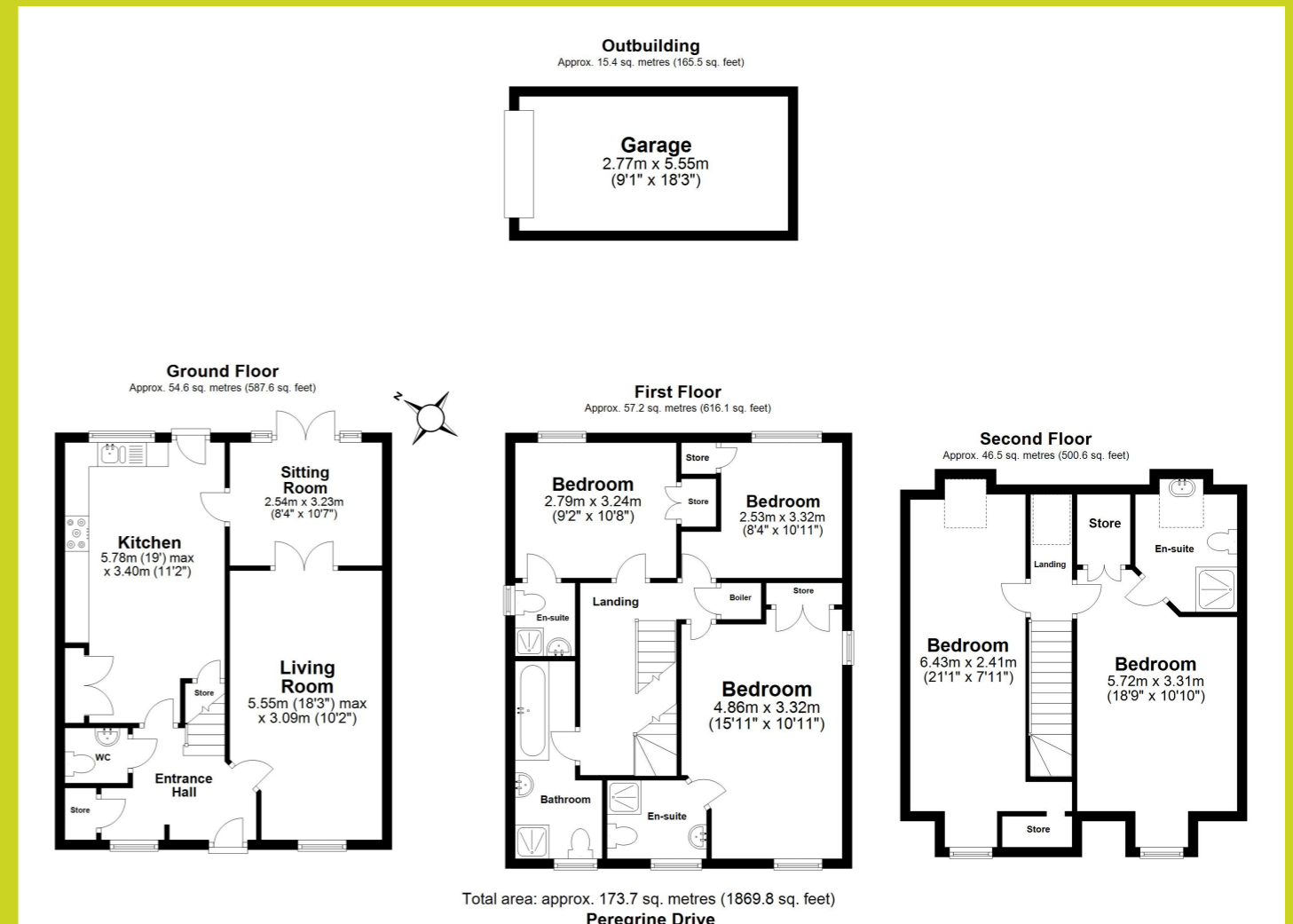

The above floor plans are not to scale and are shown for indication purposes only.

