

**Flat 7, 33 Spinnaker Court, Bean Road, Greenhithe, Kent, DA9 9JB**  
**£260,000 Leasehold**

## Description

Guide Price £260,000 - £270,000

Situated on the first floor, with easy access via the lift. As you enter the apartment you will be greeted by spacious hallway with two large cupboards for additional storage, large modern family bathroom. To the rear of the apartment has two double bedrooms with the main bedroom benefitting from an en suite shower room and direct access to the roof terrace. The open plan living area is a great size and can fit two large sofas and dining table the bay window has double doors opening to the large garden terrace. The modern kitchen is also a good size with integrated fridge freezer, washing machine and space for a dishwasher. Externally there is an allocated parking space to the rear of the development.

Spinnaker Court is an exclusive development, which only has 14 apartments within the block. The block is managed to a high standard with the communal grounds regularly maintained with surrounding mature trees, shrubs and plants. There is a communal lawn area to the front and rear where residents can relax. The internal communal areas have a keypad entrance and internal postboxes for extra security, there is a lift within the block. Spinnaker Court is only minutes from Bluewater Shopping Centre, easy access to Darenth Valley Hospital and Darenth County Park which has history back to Saxon times, the country park has excellent woodland walks and surrounded by horse paddocks which is ideal for a rural lifestyle. The proximity to Bluewater Shopping Centre and Darenth Valley Hospital has become popular for local employees and shoppers who want to take advantage of the walking distance shops, restaurants, cafes and bars. Greenhithe Village is only a short walk away with ASDA supermarket and the trading estate. Greenhithe Village is known for its historic pubs which over look the Thames and have views of Dartford Bridge. For London Commuters, Greenhithe Station is approximately 0.7miles away, Dartford Main Line Station is 3 miles away which is also within the Oyster Zone and Ebbsfleet International minutes to Stratford. Stansted or Gatwick A

GROUND FLOOR  
658 sq.ft. (61.1 sq.m.) approx.

into St Pancras or 10  
to travel to London,

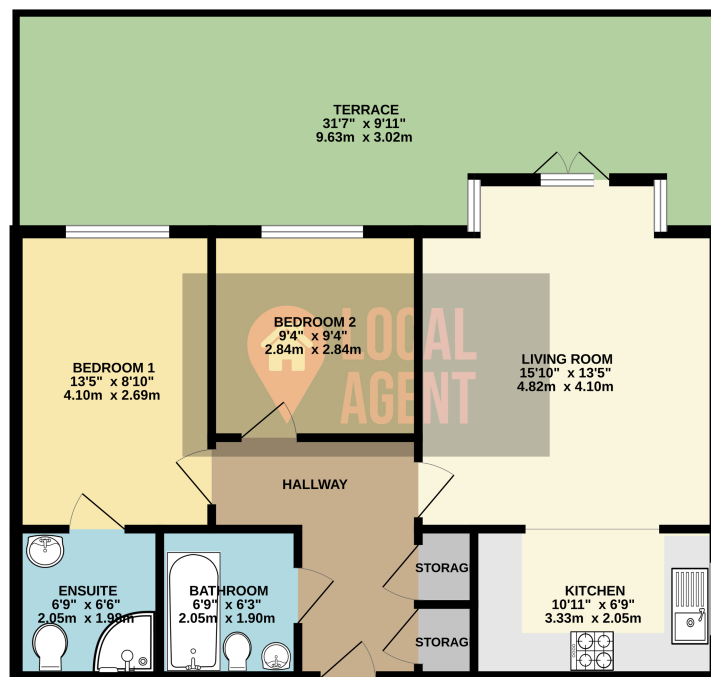

TOTAL FLOOR AREA: 658 sq.ft. (61.1 sq.m.) approx.  
Whilst every attempt has been made to ensure the accuracy of the floorplan contained here, measurements