



T: 01909 509001  
E: [info@bartropanddilks.co.uk](mailto:info@bartropanddilks.co.uk)  
W: [www.bartropanddilks.co.uk](http://www.bartropanddilks.co.uk)  
A: 78 Bridge Street, Worksop, S80 1JA

FOR SALE

£185,000

54 Beaumont Rise, Worksop, Nottinghamshire. S80 1YG



Viewing is recommended for this well presented and decorated two bedroom semi detached bungalow that has gas central heating and uPVC double glazed windows. Being set within this much sought after area and in walking distance to the town centre, the accommodation in brief comprises of; entrance hallway, lounge with fire surround and gas fire, well fitted kitchen with hob, oven and extractor, two bedrooms, bedroom one with fitted wardrobes and bedroom two with French doors to the conservatory, shower room. Outside; low maintenance front and rear gardens, block paved driveway proving ample parking that leads to the garage.



## Accommodation

### Entrance Hallway

With entrance door, central heating radiator.

### Lounge 5.26m x 3.03m (17' 3" x 9' 11")

With a front facing window, central heating radiator, fire surround with gas fire.

### Kitchen 3.13m x 2.76m (10' 3" x 9' 1")

With a good range of fitted wall and base units, worksurfaces, sink unit, wall mounted boiler, front facing window, gas hob with extractor above, electric oven, central heating radiator, plumbing for an automatic washing machine.

### Bedroom One 3.38m x 3.08m (11' 1" x 10' 1")

With fitted wardrobes, rear facing window, central heating radiator.

### Bedroom Two 2.78m x 2.68m (9' 1" x 8' 10")

With French doors to the conservatory, central heating radiator.

### Conservatory 2.83m x 2.76m (9' 3" x 9' 1")

With door to the rear garden.

## Shower Room

With a shower cubicle and mains shower, wash hand basin, low flush w.c, side facing window, central heating radiator, tiling.

## Outside

### Gardens

Low maintenance front and rear gardens.

### Driveway

Block paved and providing ample parking.

## Detached Garage









GROUND FLOOR

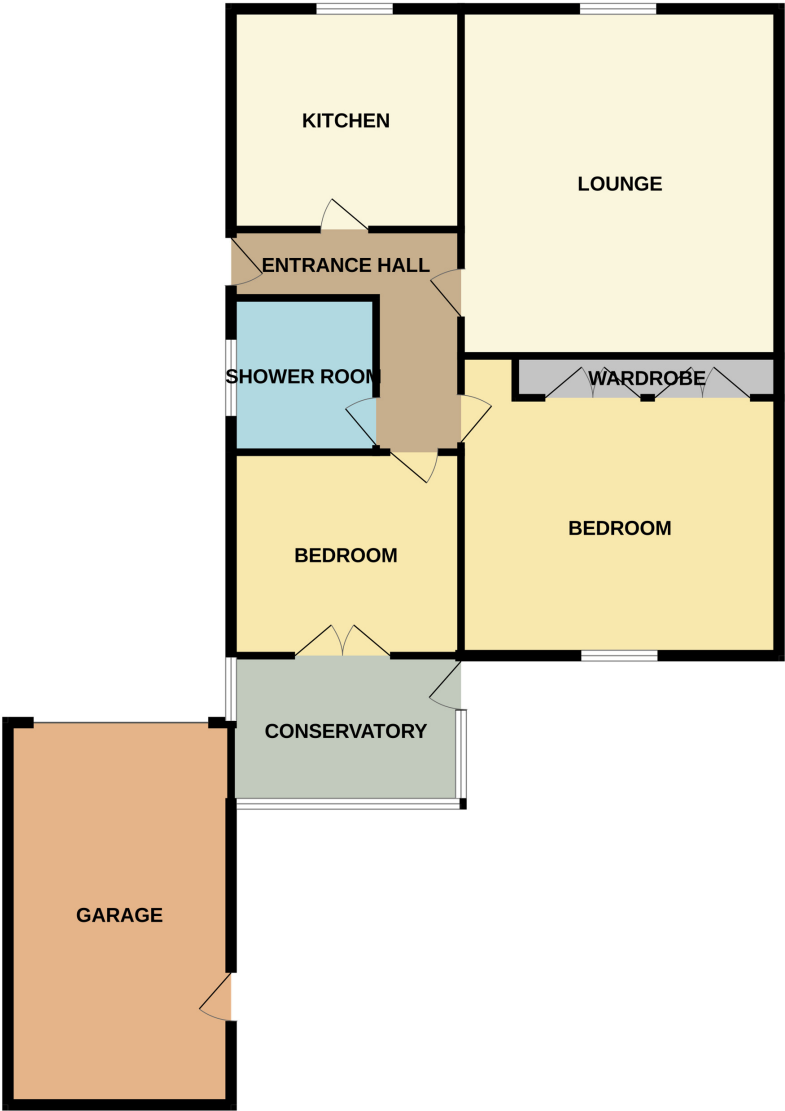

Whilst every attempt has been made to ensure the accuracy of the floorplan contained here, measurements of doors, windows, rooms and any other items are approximate and no responsibility is taken for any error, omission or mis-statement. This plan is for illustrative purposes only and should be used as such by any prospective purchaser. The services, systems and appliances shown have not been tested and no guarantee as to their operability or efficiency can be given.  
Made with Metropix ©2025

