

FOR SALE

£480,000 Freehold



**223a & 225a Turners Hill,
Cheshunt, Waltham Cross,
Hertfordshire. EN8 9DG**

ABOUT THE PROPERTY

Woodhouse are pleased to offer this freehold investment opportunity comprising of both commercial & residential premises.

The shop on the Ground Floor has previously been used as a butcher's is currently setup for same usage (the Butcher's Fixtures & Fittings can be optionally purchased for offers in the region of £40k). There is also the option to let the commercial premise. Butcher's ideal but not a necessity.

The 2-bedroom apartment itself has its own access and set over two floors, yielding a monthly AST rental income of £1,300 per month (£15,600 pa).

Turners Hill is ideal for the residential footfall thanks to the local residential neighbourhoods. Further information can be provided upon request, contact Woodhouse today for further discussion and to a viewing at your convenience.

FEATURES

- Freehold Investment opportunity
- Commercial premises plus the Duplex Apartment above it
- Shop primed for a butcher's
- Duplex maisonette on an AST of £1,300pcm
- Prominent high street position
- Shop also available to let



ROOM DESCRIPTIONS

UNFAMILIAR WITH THIS NEIGHBOURHOOD?

- You are in walking distance to Cheshunt Station (Liverpool Street 25 mins / Oxford Circus in under 40 mins)
- In under 10 minutes, you are on the M25. And shortly beyond that take your pick for the M1, M11 & A1. The A10 is just a couple of minutes drive away, again with its quick and direct route to London, or north towards Cambridge.
- In a few minutes drive you are at Brookfield Centre, with its array of large shops and eateries. Brookfield is also part of an exciting and staggering £400-million development project, which will include under current plans up to 315,000 sq ft of retail space, 250,000 sq ft of leisure space, boutique shops, restaurants and a boutique cinema
- A few minutes away is Lea Valley, a vast area encompassing heritage sites, cycling, walking, white water rafting, horse riding, nature reserves and wide open spaces.
- The latest news is that Hollywood is coming to Europe, and with a whole continent to choose from they have selected this borough as their base. The behemoth Sunset Studios are ploughing £700m to take 91 acres in nearby greenfield. Only a few minutes drive away.
- There is further development by the Old Pond / Cheshunt Station. Further evidence of the confidence in this town's popularity for those wishing to escape London's congestion, who wish pleasant green surroundings with all the amenities needed.



FLOORPLAN

FIRST FLOOR

2ND FLOOR

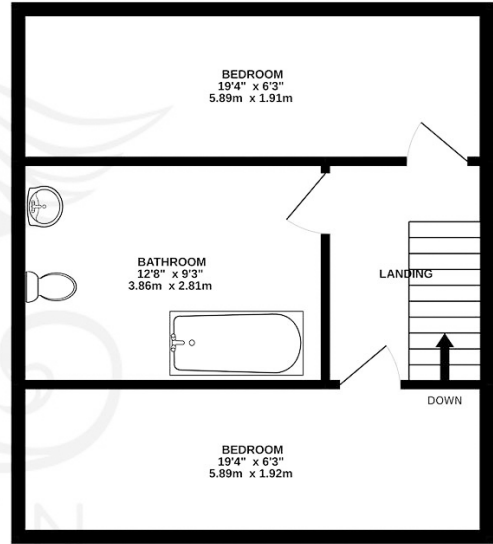
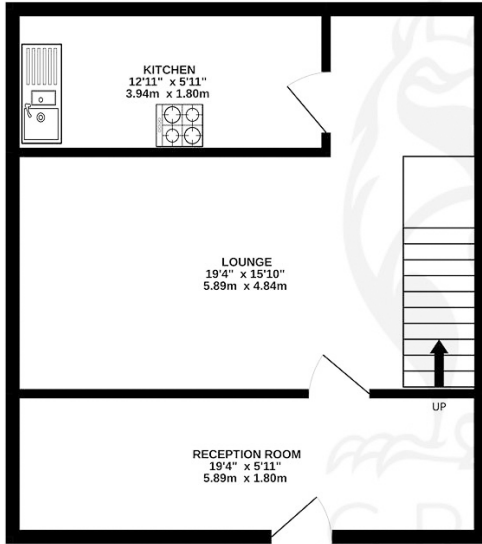

CRIFFIN
THE PROPERTY PEOPLE

Whilst every attempt has been made to ensure the accuracy of the floorplan contained here, measurements of doors, windows, rooms and any other items are approximate and no responsibility is taken for any error, omission or mis-statement. This plan is for illustrative purposes only and should be used as such by any prospective purchaser. The services, systems and appliances shown have not been tested and no guarantee as to their operability or efficiency can be given.
Made with Metropix ©2022