



St Michaels Road
Pitts Hill
Stoke-on-Trent, ST6 6LD



OneAgency

01782 970222

hello@oneagencygroup.co.uk



£500 pcm

Three bedroom terraced property, located close to shops and amenities. The property benefits from a first floor bathroom and a ground floor shower room, with a good sized rear garden.





ENTRANCE PORCH

0.83m x 0.89m (2' 9" x 2' 11")

ENTRANCE HALL

0.86m x 3.38m (2' 10" x 11' 1")

Carpeted, radiator.

FRONT RECEPTION

3.41m x 3.09m (11' 2" x 10' 2")

Window to the front elevation, carpeted, radiator, feature fire surround.

UNDER STAIR STORE

REAR RECEPTION

3.39m x 4.09m (11' 1" x 13' 5")

Window to the rear elevation, carpeted, radiator, brick fire surround. Door leading to stairs.

KITCHEN

2.49m x 3.59m (8' 2" x 11' 9")

Window to the side elevation, radiator, tiled flooring. Fitted with a range of wall, base and drawer storage units. Gas hob and electric oven.

REAR PORCH

0.79m x 0.95m (2' 7" x 3' 1")

Door leading to rear garden.



G.F SHOWER ROOM

Window to the side elevation, tiled floor, radiator. W.c, wash hand basin and shower cubicle.

BEDROOM 1

3.38m x 3.60m (11' 1" x 11' 10")

Window to the rear elevation, carpeted, radiator. Storage cupboard.

BEDROOM 2

2.40m x 3.42m (7' 10" x 11' 3")

Window to the front elevation, carpeted, radiator.

BEDROOM 3

2.06m x 2.49m (6' 9" x 8' 2")

Window to the front elevation, carpeted, radiator.

FIRST FLOOR BATHROOM

2.51m x 3.81m (8' 3" x 12' 6")

Window to the rear elevation, vinyl flooring, radiator. White suite comprising bath, w.c , wash hand basin.

Store cupboard.

EXTERIOR

To the rear of the property is an enclosed garden laid to lawn.

GROUND FLOOR
441 sq.ft. (41.0 sq.m.) approx.

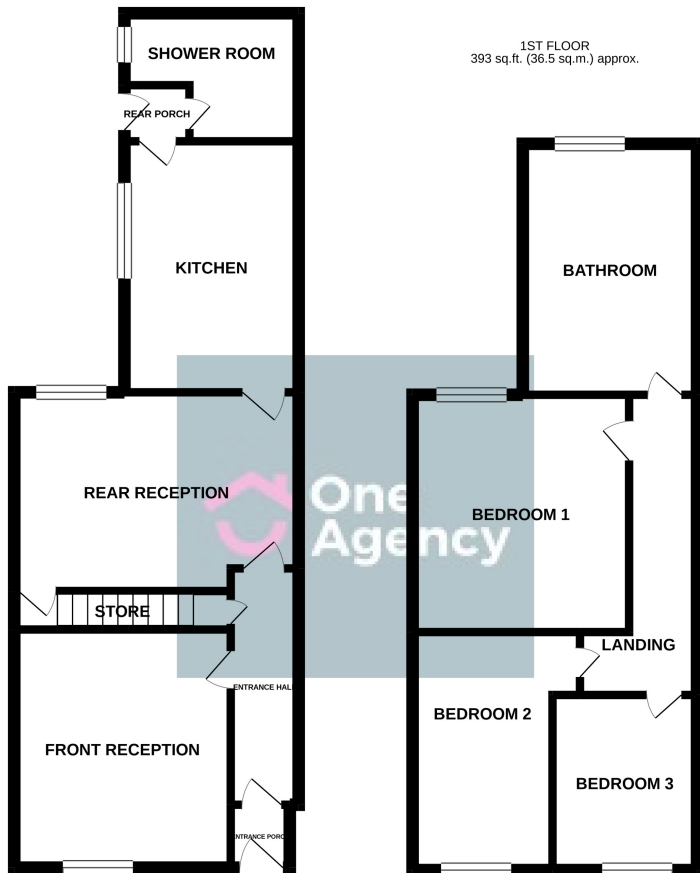

THREE BED TERRACE, GF SHOWER ROOM
TOTAL FLOOR AREA: 834 sq.ft. (77.5 sq.m.) approx.

Whilst every attempt has been made to ensure the accuracy of the floorplan contained here, measurements of doors, windows, rooms and any other items are approximate and no responsibility is taken for any error, omission or mis-statement. This plan is for illustrative purposes only and should be used as such by any prospective purchaser. The services, systems and appliances shown have not been tested and no guarantee as to their operability or efficiency can be given.
Made with Metropix ©2020

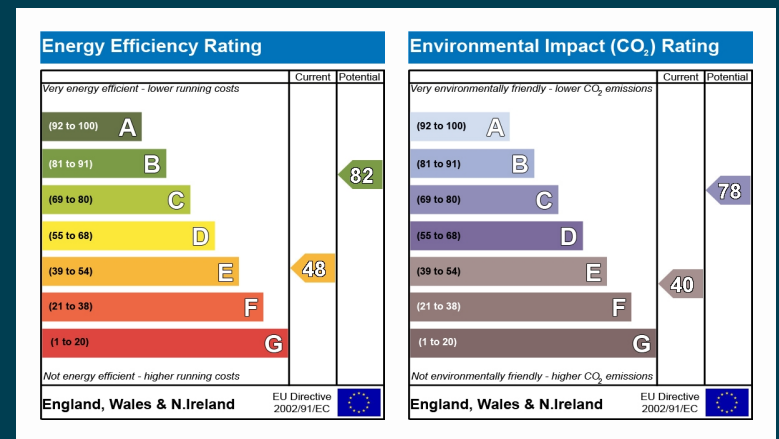

OneAgency, 9 & 10 Ridge House Drive, Festival Park, Stoke-on-Trent, ST1 5SJ

01782 970222

hello@oneagencygroup.co.uk

Every attempt has been made to ensure accuracy, however, all measurements are approximate and for illustrative purposes only. **Not to scale.**

In accordance with The Consumer Protection from Unfair Trading Regulations 2008 the following particulars have been prepared in good faith and they are not intended to constitute part of an offer or contract. We have not carried out a structural survey and the services, appliances and specific fittings have not been tested. All photographs, measurements, floor plans and distances referred to are given as a guide only and should not be relied upon for the purchase of carpets or any other fixtures and fittings. Lease details, service charges and ground rent (where applicable) are given as a guide only and should be checked and confirmed by your Solicitor prior to exchange of contracts.