



Millstone Court, Stone
ST15

 **OneAgency**

01782 970222

hello@oneagencygroup.co.uk



£675 pcm

A two bedroomed first floor apartment with allocated parking and communal gardens. The property is located close to Stone Town centre and a short walk from the canal. The property is offered unfurnished and is Managed by OneAgency.





COMMUNAL ENTRANCE HALL

Secure entrance with stairs leading to the first floor.

ENTRANCE HALL

0.97m x 6.21m (3' 2" x 20' 4")

Carpeted, radiator, secure entrance system.

OPEN PLAN KITCHEN / DINING & LIVING ROOM

5.22m x 4.17m (17' 2" x 13' 8")

Dining & Living area

French doors to Juliet balcony, laminate flooring, two radiators, feature fireplace with electric fire.

Kitchen area

Window to front, laminate flooring. The kitchen is fitted with a range of wall, base and drawer storage units, integrated electric oven and grill and gas hob.

BEDROOM ONE

3.10m x 3.96m (Max) (10' 2" x 13' 0"(Max))

Window to front, carpeted, radiator.

BEDROOM TWO

2.43m x 3.40m (8' 0" x 11' 2")

Window to side, carpeted, radiator.



BATHROOM

1.96m x 1.66m (6' 5" x 5' 5")

Tiled floor and part tiled walls, fitted with a white suite comprising of wash hand basin, w.c, bath with shower over, radiator.

EXTERIOR

Allocated parking for one vehicle and visitor parking. Communal gardens around the property which are well stocked with shrubs and flowers

GROUND FLOOR
631 sq.ft. (58.6 sq.m.) approx.

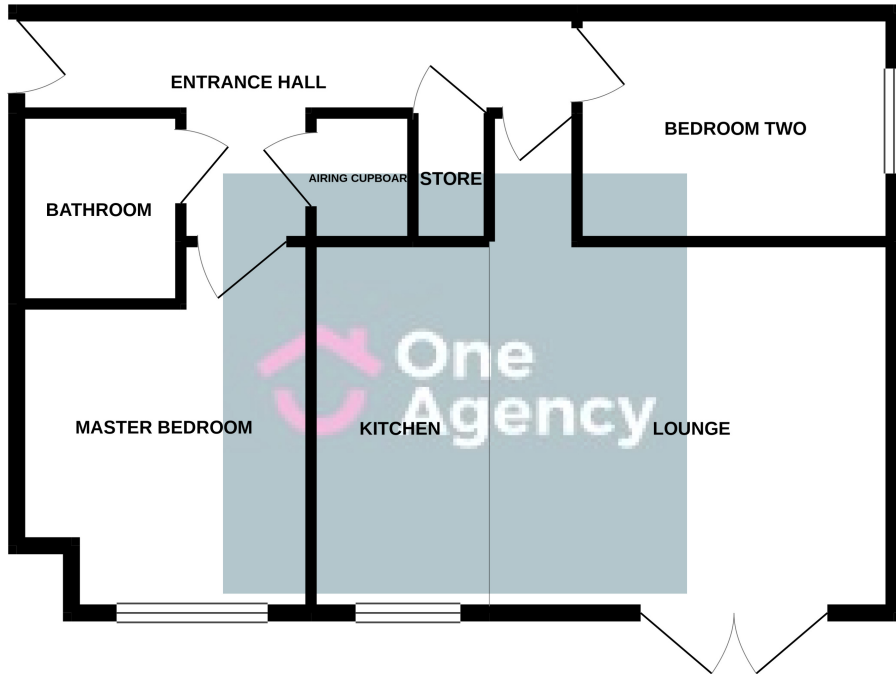

TWO BEDROOM APARTMENT

TOTAL FLOOR AREA : 631 sq.ft. (58.6 sq.m.) approx.

Whilst every attempt has been made to ensure the accuracy of the floorplan contained here, measurements of doors, windows, rooms and any other items are approximate and no responsibility is taken for any error, omission or mis-statement. This plan is for illustrative purposes only and should be used as such by any prospective purchaser. The services, systems and appliances shown have not been tested and no guarantee as to their operability or efficiency can be given.
Made with Metropix ©2021

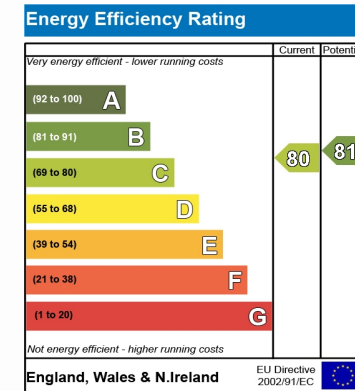

OneAgency, 9 & 10 Ridge House Drive, Festival Park, Stoke-on-Trent, ST1 5SJ

01782 970222

hello@oneagencygroup.co.uk

Every attempt has been made to ensure accuracy, however, all measurements are approximate and for illustrative purposes only. **Not to scale.**

In accordance with The Consumer Protection from Unfair Trading Regulations 2008 the following particulars have been prepared in good faith and they are not intended to constitute part of an offer or contract. We have not carried out a structural survey and the services, appliances and specific fittings have not been tested. All photographs, measurements, floor plans and distances referred to are given as a guide only and should not be relied upon for the purchase of carpets or any other fixtures and fittings. Lease details, service charges and ground rent (where applicable) are given as a guide only and should be checked and confirmed by your Solicitor prior to exchange of contracts.