

Meadow Place, St Georges, Weston-Super-Mare,
Somerset. BS22 7RT

£232,500 Freehold

FOR SALE



www.housefox.co.uk

01934 314242
01275 404601
01278 557700
sales@housefox.co.uk

PROPERTY DESCRIPTION

HOUSE FOX ESTATE AGENTS PRESENTS ... This mid terraced house is a real find as it not only offers 2 bedrooms but also cloakroom, gas heating, a great rear garden, single garage and parking in front. The property is approached via a small front garden area and with the entrance hall having the stairs to the first floor and a cloakroom offering WC and a wash basin. The living room is a good size to the rear of the house with doors to the garden and the kitchen is to the front of the house and offers a range of wall and base units with worktops over, gas hob with extractor hood over and electric oven under, spaces for washing machine and fridge freezer and inset stainless steel sink/drain. Upstairs there are 2 double bedrooms and the bathroom offers a white suite of WC, wash basin and a bath with shower over and a glass screen. Outside to the rear the secure lawned garden is a good size with an area of patio immediately to the rear for table and chairs and a rear access lane leads around to a door to the rear of the single garage, which has an up and over door to the front driveway parking.

FEATURES

- Terraced house
- Two bedrooms
- Downstairs Cloakroom
- Garage and parking for 1
- Gas C/H & Double Glazed
- NO ONWARD CHAIN
- EPC - C
- WALK THROUGH 360 VIDEO TOUR AVAILABLE



ROOM DESCRIPTIONS

Entrance Hall / Cloakroom

Stairs to first floor.

Cloakroom with white WC and wash basin; radiator and window to front

Living Room

13' 9" x 11' 6" (4.19m x 3.51m)
Radiator; Upvc double glazed french doors to rear garden; under stairs cupboard

Kitchen

9' 2" x 5' 2" (2.79m x 1.57m)
Radiator; Upvc double glazed window to front; range of wall and base units with worktops over, gas hob with extractor hood over and electric oven under, spaces for washing machine and fridge freezer and inset stainless steel sink/drainers.

Bedroom 1

11' 6" x 8' 11" (3.51m x 2.72m)
Radiator; Upvc double glazed window to front; built in cupboard

Bedroom 2

11' 6" x 8' 6" (3.51m x 2.59m)
Radiator; Upvc double glazed window to rear

Bathroom

6' 2" x 5' 2" (1.88m x 1.57m)
Radiator; white suite of WC, wash basin and a bath with shower over and a glass screen.

Outside

FRONT - garden area of chippings to front entrance

REAR - Outside to the rear the secure lawned garden is a good size with an area of patio immediately to the rear for table and chairs and a rear access lane leads around to a door to the rear of the single garage

GARAGE - has an up and over door to the front driveway parking.



FLOORPLAN & EPC

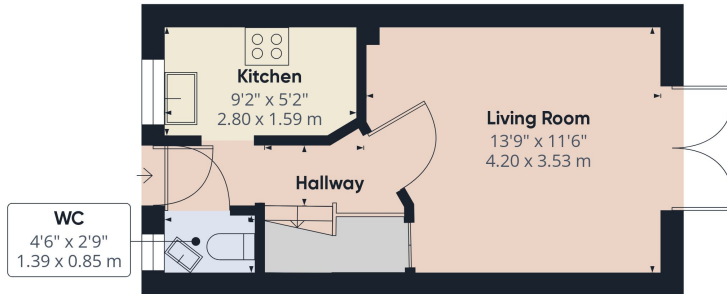

Floor 0

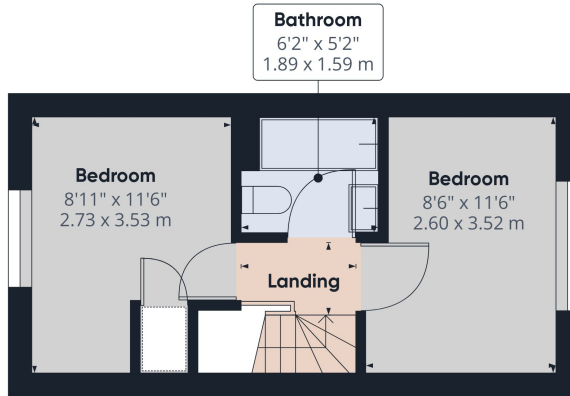

Floor 1

Approximate total area⁽¹⁾
502.73 ft²
46.71 m²

(1) Excluding balconies and terraces

While every attempt has been made to ensure accuracy, all measurements are approximate, not to scale. This floor plan is for illustrative purposes only.

GIRAFFE360

