



41B Dorset Road, Bexhill on Sea, East Sussex,
TN40 1SG

£160,000



- Spacious Top Floor Apartment
- Spacious 19ft x 13ft Lounge-Diner
- Large Double Bedroom
- Central Heated & Double Glazed
- Ample Storage Throughout
- Close To Town Centre & Station
- Pleasant Views to the front
- Ideal First Time Buy / Buy To Let Investment
- Easy Street Parking
- Viewing Highly Recommended
- Sold With No Onward Chain



2ND FLOOR FLAT
842 sq.ft. (78.2 sq.m.) approx.

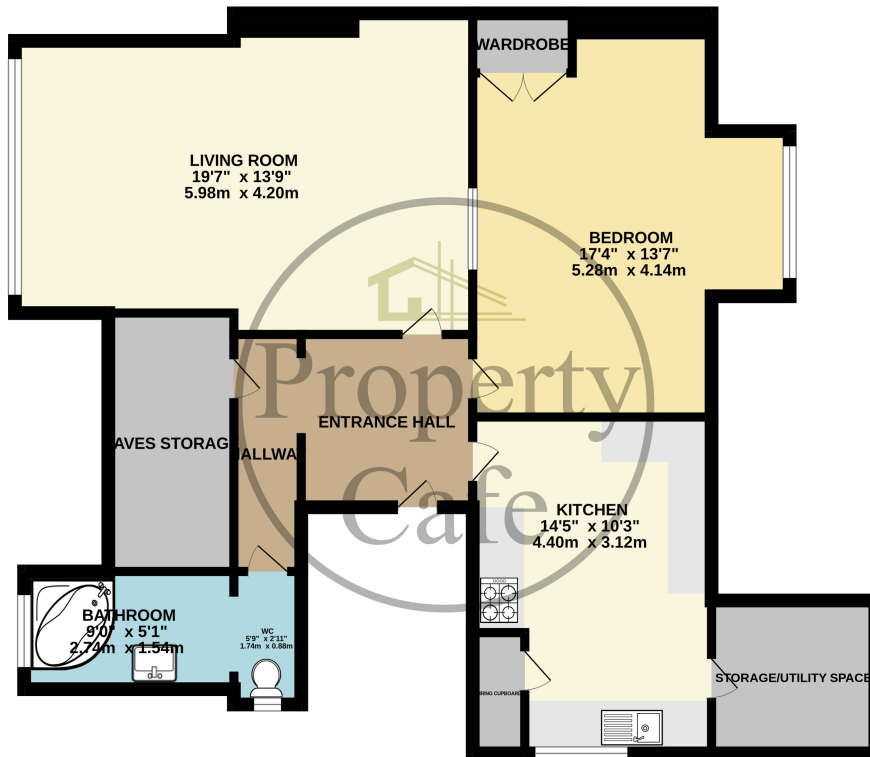

TOTAL FLOOR AREA : 842 sq.ft. (78.2 sq.m.) approx.

Whilst every attempt has been made to ensure the accuracy of the floorplan contained here, measurements of doors, windows, rooms and any other items are approximate and no responsibility is taken for any error, omission or mis-statement. This plan is for illustrative purposes only and should be used as such by any prospective purchaser. The services, systems and appliances shown have not been tested and no guarantee as to their operability or efficiency can be given.
 Made with Metropix 03/2021