



- Brand New High Specification Throughout
- Small Development Of Bespoke Homes
- Detached Family Home
- Four Spacious Bedrooms
- Stunning Kitchen/Diner
- Bathroom, En Suite & Cloakroom
- Generous Garden & Ample Parking
- Air Source Heat Pump

Plot Three Conrad Road, Witham, Essex. CM8 2QL.

GUIDE PRICE £500,000-£525,000

Set within an exclusive development of only six newly built homes, this brand new four-bedroom detached family home offers high specification living throughout, ideal for modern family life. Occupying a generous plot, this home features a sizeable rear garden and ample parking, making it as practical as it is stylish.



Call to view 01376 337400



Property Details.

Room Measurements

Entrance Hall



Living Room



19' 0" x 11' 0" (5.79m x 3.35m)

Kitchen



23' 7" x 10' 10" (7.19m x 3.30m)

Cloakroom

Study

First Floor

Bedroom One



16' 8" x 10' 10" (5.08m x 3.30m)

Property Details.

En Suite



Bedroom Two

11' 1" x 11' 0" (3.38m x 3.35m)

Bedroom Three

10' 7" x 10' 2" (3.23m x 3.10m)

Bedroom Four

11' 0" x 7' 7" (3.35m x 2.31m)

Family Bathroom



Outside

Rear Garden



Driveway Parking

Property Details.

Floorplans

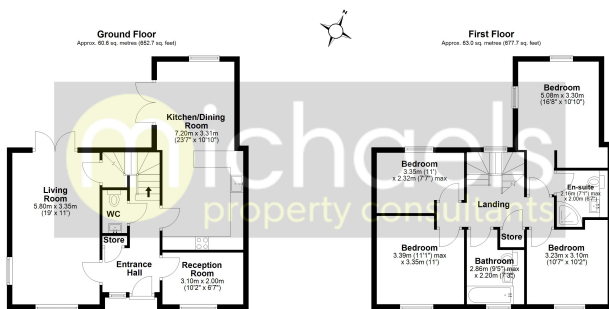

Total area: approx. 123.6 sq. metres (1330.4 sq. feet)
Conrad Road

Location

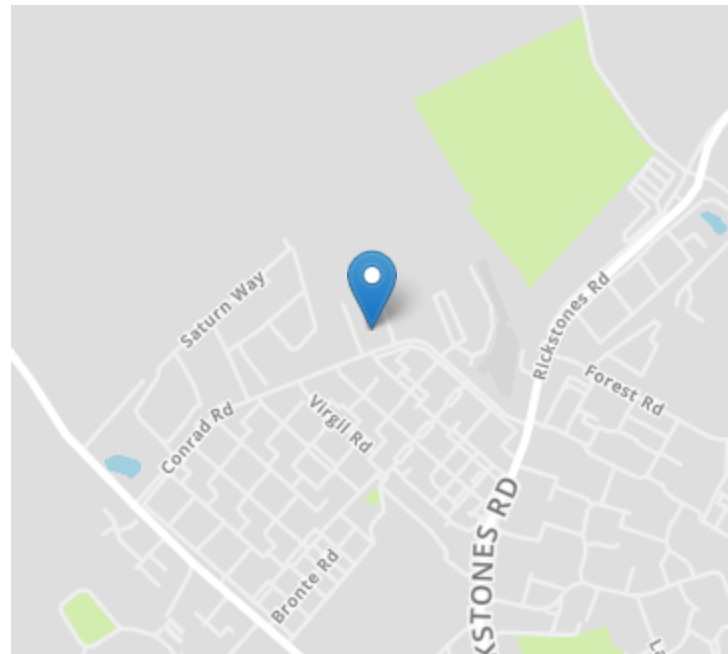

Energy Ratings

We have not carried out a structural survey and the services, appliances and specific fittings have not been tested. All photographs, measurements, floor plans and distances referred to are given as a guide only and should not be relied upon for the purchase of carpets or any other fixtures or fittings. Gardens, roof terraces, balconies and communal gardens as well as tenure and lease details cannot have their accuracy guaranteed for intending purchasers. Lease details, service ground rent (where applicable) are given as a guide only and should be checked and confirmed by your solicitor prior to exchange of contracts.